



N. P. 1263  
6-34

# NORTHERN PACIFIC RAILWAY COMPANY AUTHORITY FOR EXPENDITURE

1929  
COMPTROLLER'S  
YEAR 1929  
A. F. E. NO. 495

SUPERINTENDENT'S No. 42

DEPT. No. ENGINEERING DEPT. No. 71-29

DISTRICT BRANCH STATE Wash.

VAL. SEC. No. 28-A

Tacoma Div. Elma Branch

AUTHORITY IS REQUESTED FOR A NET EXPENDITURE OF \$3522

Accounting distribution as follows: (Distribution to be made in General Office.)

	Operating Expenses	Profit and Loss	Net Operating Expenses	Net Profit and Loss
Cost of property retired	3			
Value of salvage	133			
Incidental costs	64			
<b>Total to Operating Expenses</b>			69	
<b>Total to Profit and Loss</b>			109	
To Material and Supplies				178 ✓
To Bills for Collection				64 ✓
To Other Accounts				
Net charge to investment account—Additions and Betterments				3344 ✓
<b>Total of distribution</b>				3586 ✓

Original Cost Adjustment  
Made in 11-1-1929  
*Handwritten signature*

Budget reference: NOT IN BUDGET.

Joint facility contract reference: Non Joint.

Class of Works No. 10 ✓

The location is **not** on this company's property. To secure rights, it will be necessary to secure easement.

Location: Hillgrove, Wash.  
Title: Wye track connection at Hillgrove.  
and Track increase 970 ft.

Reason:

It has been the practice heretofore for trains on the Elma Branch to stop at the point where the McCleary Branch connects with the main line, take the loads and empties down to McCleary where they would do the necessary switching at the mill, etc. It has been agreed with Mr. McCleary that, if the Northern Pacific will construct the track connection at Hillgrove as contemplated by this AFE, he will make and take delivery of loads and empties at the main line. This train is always on overtime and the estimated saving is \$2,250.00 per year.

Work to be done by company force under charge of **Superintendent**  
Accounting to concentrate in the office of **Division Accountant.**

Checked and Entered  
President's Office



Date 3-11 1929

Signature and Title

APPROVED:

<i>[Signature]</i> General Superintendent	<i>[Signature]</i> Superintendent	<i>[Signature]</i> General Manager
<i>[Signature]</i> Mech. Supt., Sept. Telgr. or Signal Engr.	<i>[Signature]</i> Asst. Chief Engr. or Engr. Maint. of Way.	<i>[Signature]</i> Vice President
<i>[Signature]</i> Chief Engineer	<i>[Signature]</i> President	<i>[Signature]</i> Vice President
<i>[Signature]</i> For Comptroller	<i>[Signature]</i> President	<i>[Signature]</i> Vice President

Date of Final Approval APR 1929

Form No. 1346 issued

COMPTROLLER'S RECORD OF NOTICE OF APPROVAL AND OF COMPLETION

19 Work begun

19 Work finished

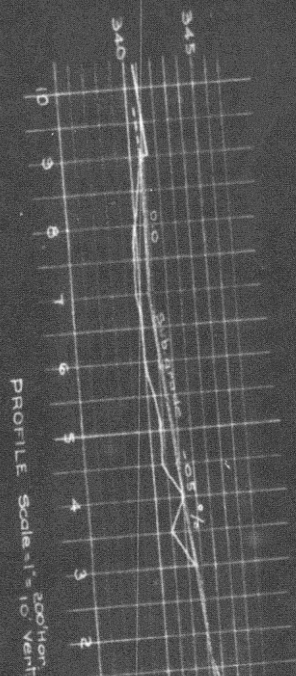
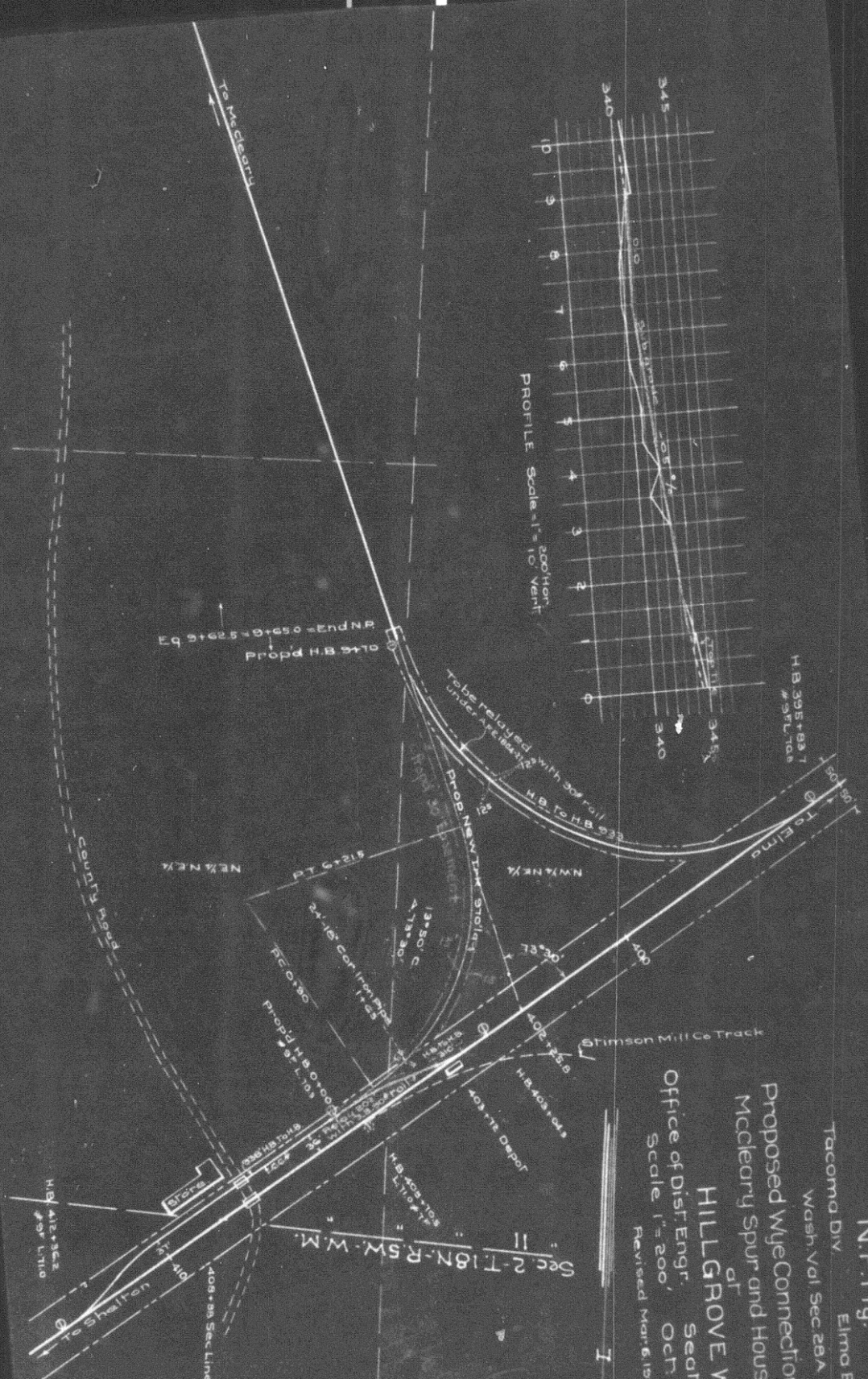

N.P.R.y.  
 Tacoma Div. Elmo Branch  
 Wash. Vol. Sec 28A  
 Proposed Wye Connection between  
 McCleary Spur and House Track.  
 of  
 HILL GROVE W.N.  
 Office of Dist. Engr., Seattle W.N.  
 Scale 1" = 200' Oct. 24th 1929  
 Revised Mar. 6, 1929