



N. P. 1363
6-24

NORTHERN PACIFIC RAILWAY COMPANY

AUTHORITY FOR EXPENDITURE

1929 1929
YEAR 1929

SUPERINTENDENT'S No. 23

DEPT. No.

No.

ENGINEERING DEPT. No. 62-29

A. F. E. NO. 492

P A S C O Div. FIRST DISTRICT DISTRICT BRANCH STATE WASH. VAL. SEC. No. 1

AUTHORITY IS REQUESTED FOR A NET EXPENDITURE OF \$ 377.

Accounting distribution as follows: (Distribution to be made in General Office.)

	Operating Expenses	Profit and Loss	Not Operating Expenses	Net Profit and Loss
Cost of property retired.....	\$	\$	\$	\$
Value of salvage				
Incidental costs			17	
Total to Operating Expenses				\$ 17 ✓
Total to Profit and Loss				
To Material and Supplies				
To Bills for Collection				
To Other Accounts				
Net charge to investment account—Additions and Betterments				360 ✓
Total of distribution				\$ 377 ✓

Budget reference: Spec 467-1729

Class of Work, No. 21 ✓

Joint facility contract reference: **Non Joint.**

The location is _____ on this company's property. To secure rights, it will be necessary

Location: **Pasco, Washington**

Title **Runways at Roundhouse.**

and

Reason: **A Baker movable crane has been provided for handling locomotive tires. In order to operate the crane efficiently and economically, runways, constructed of old car sills, should be provided because of the ground over which it is necessary to move the crane being too soft for its operation. It is recommended that the work be authorized in accordance with the attached sketch and estimate.**

Work to be done by company force under charge of Superintendent

Accounting to concentrate in the office of Division Accountant

Checked and Entered President's Office



Signature and Title: J. M. Weston Superintendent Date March 28 1929

APPROVED: <u>[Signature]</u> General Superintendent.	<u>[Signature]</u> Asst. Chief Engr. or Engr. Maint. of Way.	<u>[Signature]</u> General Manager.
<u>[Signature]</u> Mech. Supt., Supt. Train or Signal Engr.		
<u>[Signature]</u> Chief Engineer.		<u>[Signature]</u> VICA President.
<u>[Signature]</u> For Comptroller.	<u>Charles D. [Signature]</u> President	Date of Final Approval <u>APR 4 1929</u>

COMPTROLLER'S RECORD OF NOTICE OF APPROVAL AND OF COMPLETION

Form No. 1345 Issued _____ 19 _____ Work begun _____ 19 _____ Work finished 6-27 1929

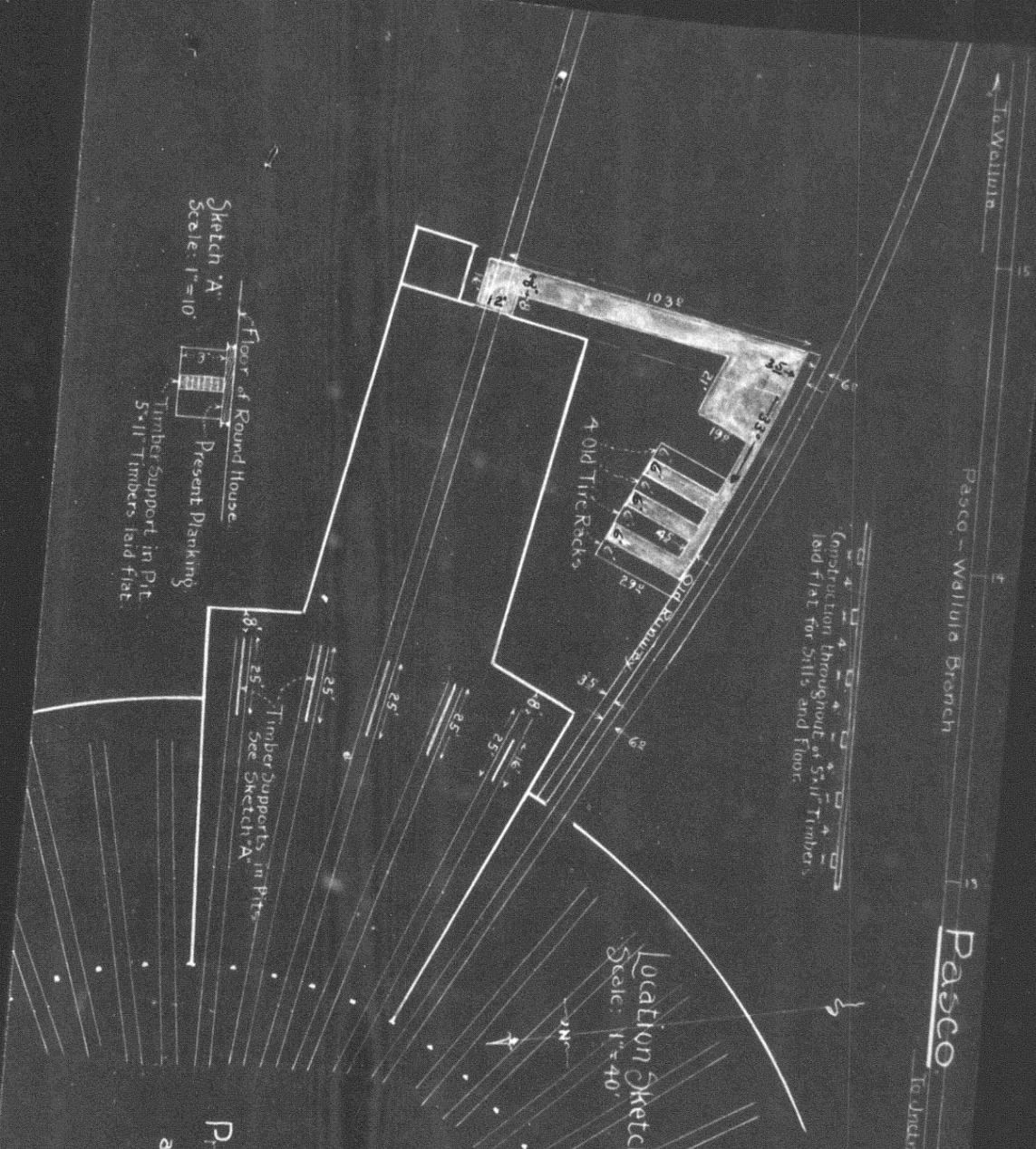

N.P.R.Y.
Pasco Div. 2nd Sub-div.
Proposed Runways for Baker Crane,
at Round House, Pasco, Wash.
Scale as shown.
Office Dist. Engr. Spokane, Feb 26, 1929
Prop. new work shown thus: —
Valuation Section, Wash. # 1
G.B.