



N. P. 1363  
6-24

NORTHERN PACIFIC RAILWAY COMPANY  
AUTHORITY FOR EXPENDITURE

COMPTROLLER'S OFFICE  
1929  
YEAR 1929

SUPERINTENDENT'S No.

Manager's No. 154

DEPT. No.

ENGINEERING DEPT. No. 17-29

A. F. E. No. 491

Camas Prairie R. R. Div. Camas Prairie R. R. ~~BRANCH~~ STATE Idaho VAL. SEC. No. 6

AUTHORITY IS REQUESTED FOR A NET EXPENDITURE OF \$ 203.00

Accounting distribution as follows: (Distribution to be made in General Office.)

	Operating Expenses	Profit and Loss	Net Operating Expenses	Net Profit and Loss
Cost of property retired	\$	\$	\$	\$
Value of salvage				
Incidental costs				
Total to Operating Expenses				
Total to Profit and Loss				
To Material and Supplies				
To Bills for Collection				
To Other Accounts				
Not charge to investment account—Additions and Betterments				
Total of distribution				\$ 203 ✓

Added to Joint Valuation MAY 1930

Budget reference: Not in budget

Joint facility contract reference: Basis C.W. R.R. & N. Contract 3/10/26, 9-1-26

The location is \_\_\_\_\_ on this company's property. To secure rights, it will be necessary

Location: Orofino, Idaho

Title Construct Unloading Platform Suitable for Unloading Automobiles or Machinery

Reasons: There is no platform at Orofino suitable for unloading automobiles or machinery, therefore, it is desired to construct a platform to accommodate this class of business.

APPROVED

Copy (Signed A. V. Brown)

*[Signature]*  
VICE PRESIDENT  
CAMAS PRAIRIE RAILROAD COMPANY

APPROVED

*[Signature]*  
President, Camas Prairie R.R. Co.

Checked and Entered  
President's Office



Work to be done by company force under charge of Supervisor of Maintenance, C. P. R. R. Co.

Accounting to concentrate in the office of Auditor, Camas Prairie R.R. Co., Lewiston, Idaho

Signature and Title: *[Signature]* Manager, C.P.R.R. Co. Date March 1, 1929

APPROVED:	<i>[Signature]</i> General Superintendent.	<i>[Signature]</i> Asst. Chief Engr. or Engr. Maint. of Way.	<i>[Signature]</i> General Manager.
	<i>[Signature]</i> Mech. Supt., Supt. T'igh. or Signal Engr.		
	<i>[Signature]</i> Chief Engineer.		<i>[Signature]</i> Vice President.
	<i>[Signature]</i> For Comptroller.	<i>[Signature]</i> President.	Date of Final Approval { APR 4 1929 }

COMPTROLLER'S RECORD OF NOTICE OF APPROVAL AND OF COMPLETION

Form No. 1345 issued \_\_\_\_\_ 19 \_\_\_\_\_ Work begun \_\_\_\_\_ 19 \_\_\_\_\_ Work finished \_\_\_\_\_ 19 \_\_\_\_\_

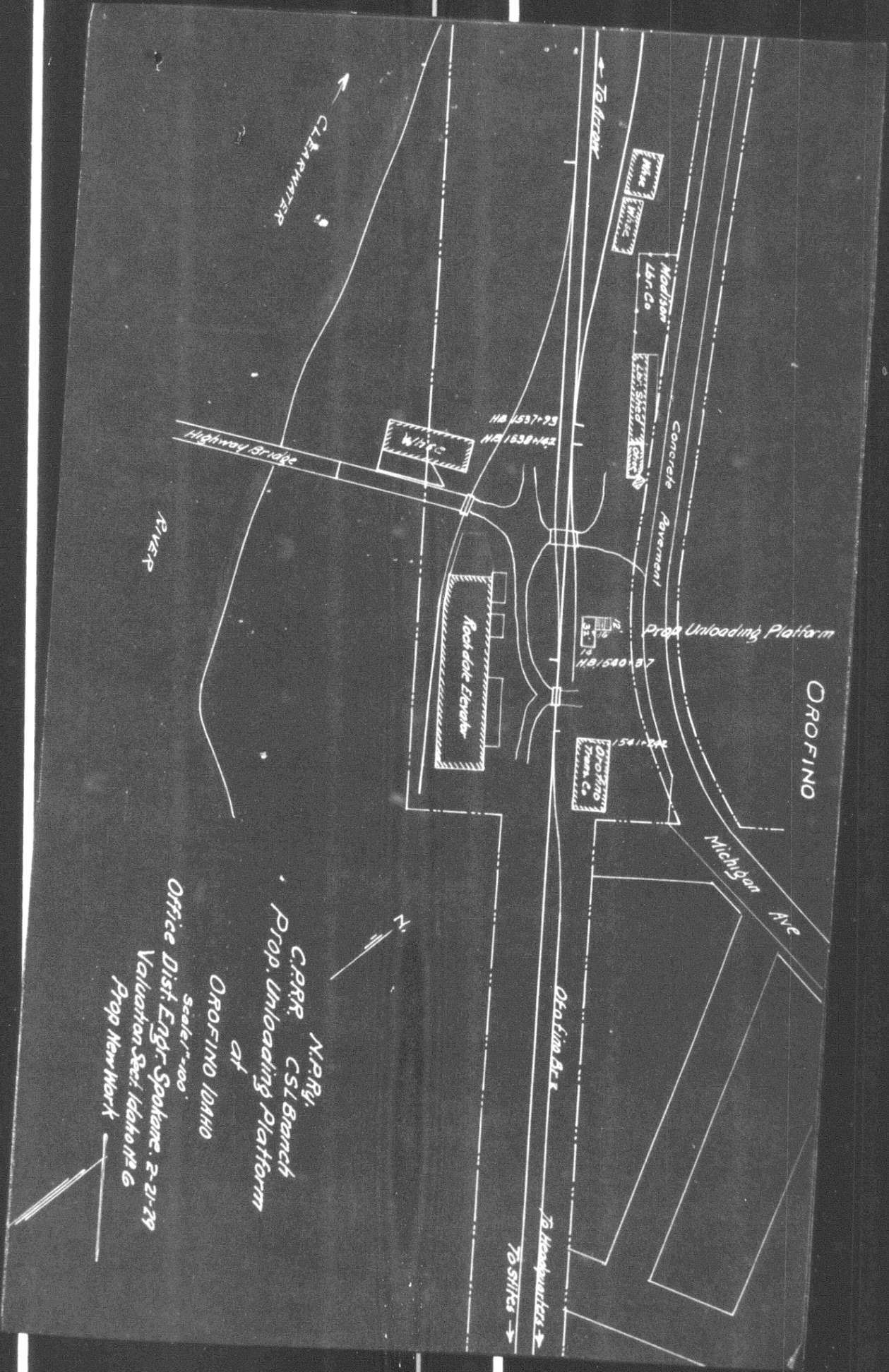

N.P.R.Y.  
 C.P.R.R. CSL Branch  
 Prop. Unloading Platform  
 at  
 OROFINO IDAHO  
 Scale 1"=100'  
 Office Dist. Engr. Spokane, 2-21-29  
 Valuation Ser: Idaho No 6  
 Prop New Work