



N. P. 1363
6-24

NORTHERN PACIFIC RAILWAY COMPANY
AUTHORITY FOR EXPENDITURE

1929
YEAR 1929

SUPERINTENDENT'S No. 31.
No.

DEPT. No.
ENGINEERING DEPT. No. 63-29

A. F. E. NO. 484

Idaho Div. Second District DISTRICT BRANCH STATE WASH. VAL. SEC. No. 15

AUTHORITY IS REQUESTED FOR A NET EXPENDITURE OF \$ 95

Accounting distribution as follows: (Distribution to be made in General Office.)

	Operating Expenses	Profit and Loss	Net Operating Expenses	Net Profit and Loss
Cost of property retired	\$ 89	\$	\$	\$
Value of salvage			89	
Incidental costs			6	
Total to Operating Expenses				\$ 95 ✓
Total to Profit and Loss				
To Material and Supplies				
To Bills for Collection				
To Other Accounts				
Net charge to investment account—Additions and Betterments				
Total of distribution				\$ 95 ✓

Original Cost Adjustment
Made in May 18 1929
Supt.

Budget reference: ~~NOT IN BUDGET~~

100.00
100.00

Class of Works No. 17 ✓

Joint facility contract reference: Non Joint

The location is on this company's property. To secure rights, it will be necessary

Location: Spokane, Washington.

Title: Replacing switch tender's house.

and

Reason: The switch tender's house near Washington Street at Spokane was totally destroyed by fire from some unknown cause on October 7, 1928. It was necessary to replace it in kind immediately.

Work to be done by company force under charge of Superintendent.

Accounting to concentrate in the office of Division Accountant

Checked and Listed
President's Office

Signature and Title: Supt.

Date 3-9-29



APPROVED: <i>[Signature]</i> General Superintendent.	<i>[Signature]</i> Asst. Chief Engr. or Engr. Maint. of Way.	<i>[Signature]</i> General Manager.
<i>[Signature]</i> Mech. Supt., Supt. Trigh. or Signal Engr.		<i>[Signature]</i> Vice President.
<i>[Signature]</i> For Comptroller.	<i>[Signature]</i> President.	Date of final approval { APR 3 1929 } 19..

COMPTROLLER'S RECORD OF NOTICE OF APPROVAL AND OF COMPLETION

Form No. 1345 issued 19.. Work begun 19.. Work finished Oct. 23 1929

Spokane.

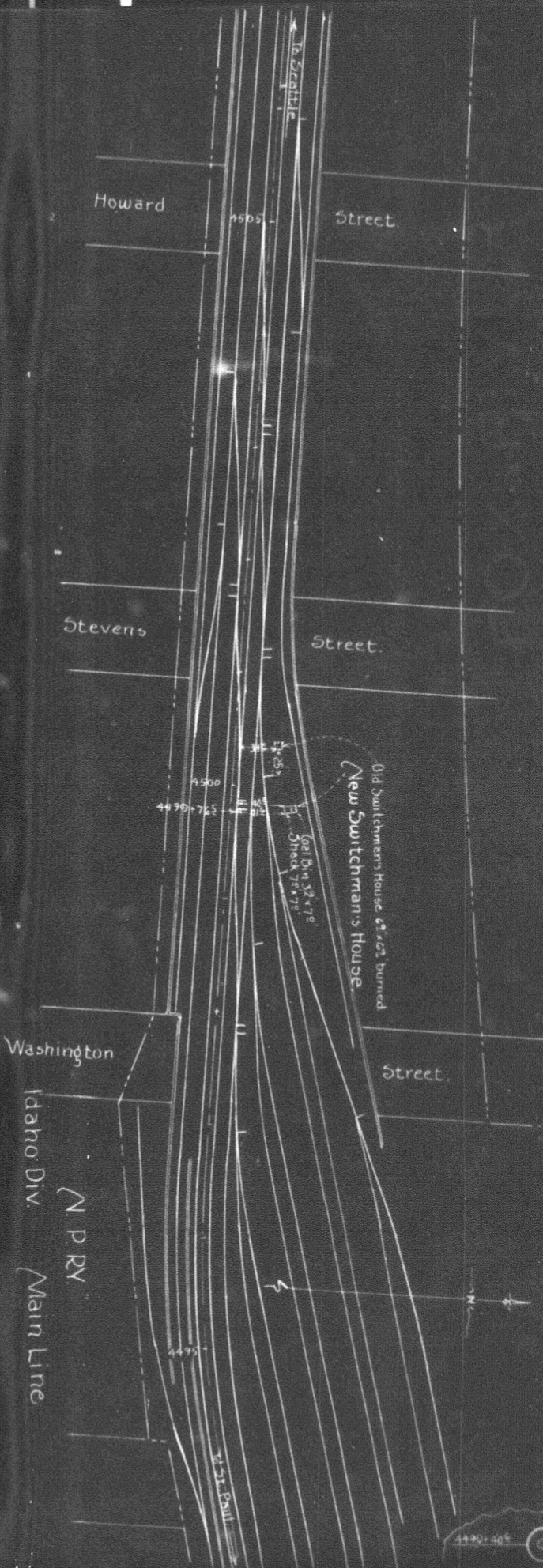

Switch Tender's House,
replacing one destroyed by fire,
Spokane, Wash.

Scale: 1" = 100'
Office Dist. Engr. Spokane, Mich., 1, 1929.
New work shown thus: _____
Shack destroyed -----
Valuation Section, Wash. # 1 B.
G.B.