



N. P. 1929
6-24

NORTHERN PACIFIC RAILWAY COMPANY

COMPTROLLER'S COPY

AUTHORITY FOR EXPENDITURE

1929
1929

SUPERINTENDENT'S No. 15
No.

DEPT. No.
ENGINEERING DEPT. No. 19

A. F. E. No. **L 473**

Lake Superior Div. Duluth Terminals DISTRICT STATE Minn.
BRANCH

VAL. SEC. No. 1

AUTHORITY IS REQUESTED FOR A NET EXPENDITURE OF \$ 3838.00

Accounting distribution as follows: (Distribution to be made in General Office.)

	Operating Expenses	Profit and Loss	Net Operating Expenses	Net Profit and Loss
Cost of property retired	1431			
Value of salvage	970			
Incidental costs			461	
			1150	
Total to Operating Expenses				
Total to Profit and Loss				1591 ✓
To Material and Supplies				
To Bills for Collection				970 ✓
To Other Accounts				
Net charge to investment account—Additions and Betterment:				
Total of distribution				1231 ✓
Budget reference: Item 89				3792 ✓

COST AT CURRENT ADJUSTMENT
MADE IN

Joint facility contract reference: Joint with GMS&P&P RR Contract October 1, 1900.
Class of Work: No. 3 ✓
The location is on this company's property. To secure rights, it will be necessary
Location: Duluth Month: MAR

Title Relay West ladder track Yard "E" with 90# rail

Reason: The West ladder track is now laid with 56# switch material. As there is a heavy switching movement over this track, it is impossible to hold it in shape with such light rail and it is proposed to relay with heavier switch material. The East lead of this yard was relaid with heavier rail several years ago and it is just as important that the West lead be changed to heavier material.

Work to be done by company force under charge of Superintendent
Accounting to concentrate in the office of Superintendent
Signature and Title: *H. H. Jacobus* Superintendent
Checked and Limited President's Office
Date Jan. 4, 1929

APPROVED

<i>H. H. Jacobus</i> General Superintendent.	<i>[Signature]</i> Asst. Chief Engr. & Engr. in-charge of Work.	<i>[Signature]</i> General Manager.
<i>[Signature]</i> Mach. Supt., Supt. Telgr. or Signal Engr.	<i>[Signature]</i> VICE PRESIDENT	<i>[Signature]</i> Vice President.
<i>[Signature]</i> Chief Engineer.	<i>[Signature]</i> President.	

Date of Final Approval: APR 1 1929

COMPTROLLER'S RECORD OF NOTICE OF APPROVAL AND OF COMPLETION
Form No. 1345 issued
19 Work begun
19 Work finished June 13

Michigan St

10th Ave W

9th Ave W

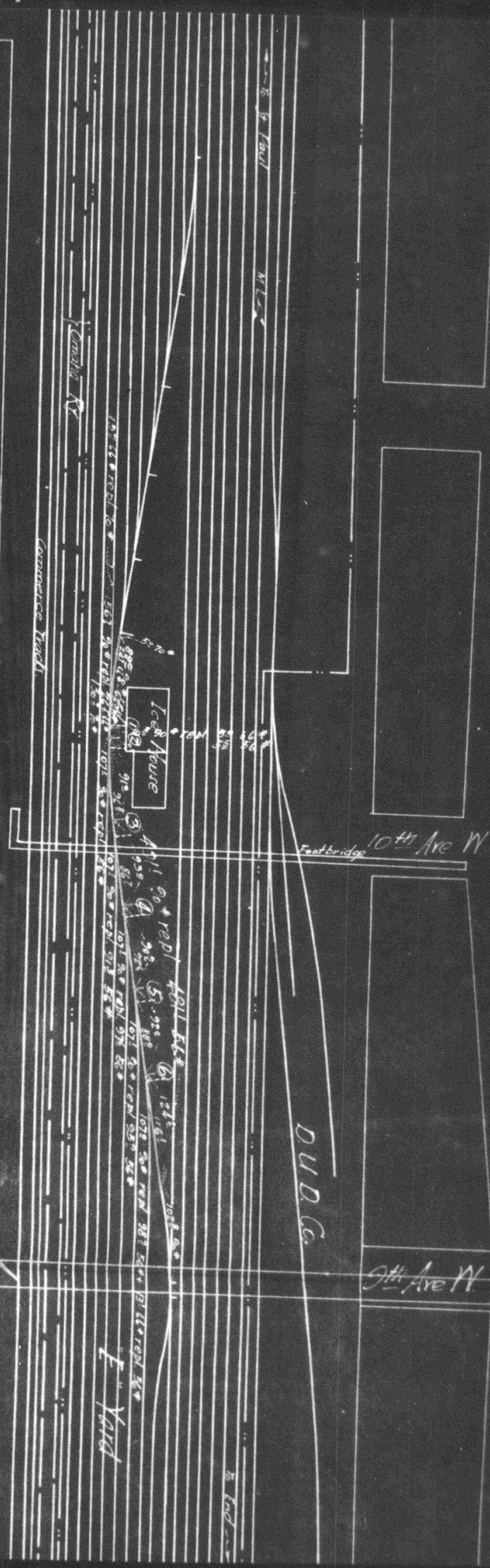

Material in Turnouts

Switch	Lead	Points	Frog	Guard Rail
1	640	25 90"	77 RT Baked We 8"	8 3/4" 3" Clamp
2	688	"	"	"
3	659	"	"	"
4	640	"	"	"
5	640	"	"	"
6	640	"	"	"
1	618	15: 6.6"	77 RT Clamp 93 7/8"	15: 72" plain
2	563	16: 56"	77 RT "	13 3/4 x 14 1/2 plain 85"
3	534	10: "	77 RT "	15 1/2 x 15 1/2 "
4	582	15: "	77 RT "	15 1/2 x 15 1/2 "
5	619	15: "	77 RT "	15 1/2 x 15 1/2 "
6	629	15: "	77 RT "	15 1/2 x 15 1/2 "

Late Superior Div. Duluth Terminal
 Relay West Ladder Track - Yard 'E'
 Duluth Minn.
 Office of Dist Engr. St Paul, Sept 9, 1929
 Scale 1" = 100'
 Relay shown red
 Authorized under A.T.E. 473-29
 Labuation section No. 1 Minn.
 Work begun June 1929
 Work completed June 13, 1929

N.P.R.

E Yard