



N. P. 1363  
6-24

NORTHERN PACIFIC RAILWAY COMPANY  
AUTHORITY FOR EXPENDITURE

COMPTROLLER'S COPY

SUPERINTENDENT'S No. 64

DEPT. No.

YEAR 1929

No. 1

ENGINEERING DEPT. No. 68

A. F. E. No. 457

Montana

Div.

Second

DISTRICT  
~~BRANCH~~

STATE Montana

VAL. SEC. No.

3

AUTHORITY IS REQUESTED FOR A NET EXPENDITURE OF \$ 180.00

Accounting distribution as follows: (Distribution to be made in General Office.)

	Operating Expenses	Profit and Loss	Net Operating Expenses	Net Profit and Loss
Cost of property retired	\$	\$	\$	\$
Value of salvage				
Incidental costs				
Total to Operating Expenses				\$
Total to Profit and Loss				\$
To Material and Supplies				
To Bills for Collection				
To Other Accounts				
Net charge to investment account—Additions and Betterments				180 ✓
Total of distribution				\$ 180 ✓

Budget reference: Item 467

Class of Work: No. 21 ✓

Joint facility contract reference: Not Joint.

The location is ----- on this company's property. To secure rights, it will be necessary

Location: Livingston, Montana.

Title: Paint Room in Flue House.

and

Reason:

At present time paint supply of the Store Department is stored in the old stationary plant at the car shop. The present location of paint supply is unsatisfactory as paint stock is not under direct supervision of the Division Storekeeper. It is proposed to place a concrete floor and steam coil in the west end of the flue house for storing paint stock. Paint supplies will then be issued only on requisition to Division Storekeeper and stock will be in charge of store-room foreman.

It is therefore recommended that work be done as per attached blue print and estimate.

Mr. E. J. Myers, General Storekeeper, concurs in these recommendations.

Work to be done by company force under charge of Superintendent.

Accounting to concentrate in the office of Superintendent.

Checked and entered  
President's Office



Signature and Title: *[Signature]* Superintendent, Date Feb. 12 1929

APPROVED: *[Signature]* General Superintendent, *[Signature]* Asst. Chief Engr. or Engr. in Charge of Work, *[Signature]* General Manager.

Mech. Supt., Supt. Telgr. or Signal Engr.: *[Signature]* Chief Engineer, *[Signature]* Vice President.

*[Signature]* For Comptroller, *[Signature]* President, Date of Final Approval: MAR - 7 1929

COMPTROLLER'S RECORD OF NOTICE OF APPROVAL AND OF COMPLETION

Form No. 1345 issued. 19. Work begun. 19. Work finished May 7 1929

Machine Shop  
6065+774 7

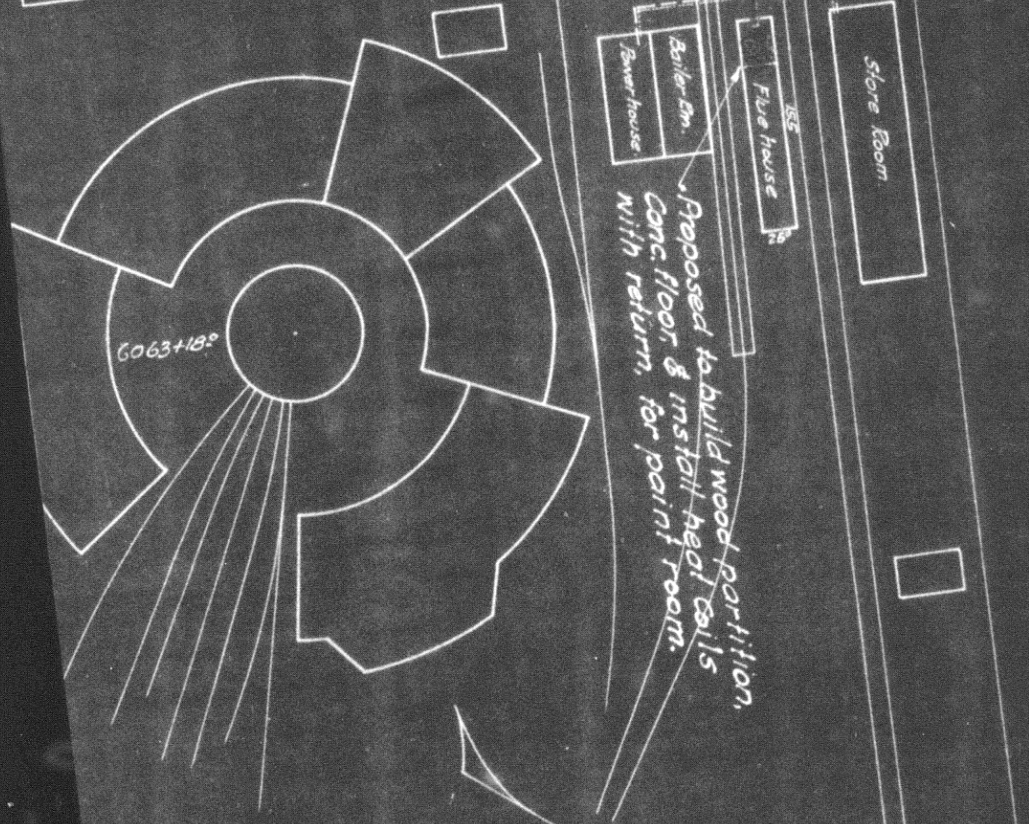

N.P.E.  
Drawing No  
2nd District  
Montana Div  
Proposed to fix up room in west end of  
Flue house as a Paint room  
at  
**Livingston.**  
Scale: 1" = 10'  
Office of Dist. Engr. Livingston, Mont. Febr. 9th 1929.  
Proposed New Work Shown  
Valuation Section Mont. No. 8