

NORTHERN PACIFIC RAILWAY COMPANY COMPTROLLER'S COPY
 AUTHORITY FOR EXPENDITURE

1929 1929
 YEAR 1929

63
 24
 N
 ERIN... IT'S NO. 19
 No.

1929
 DEPT. No.
 ENGINEERING DEPT. No. 23

A. F. E. NO. 445

Lake Superior Div. Duluth Terminals DISTRICT STATE Minn. VAL. SEC. No. 1.

AUTHORITY IS REQUESTED FOR A NET EXPENDITURE OF \$ 1528.00

Accounting distribution as follows: (Distribution to be made in General Office.)

	Operating Expenses	Profit and Loss	Net Operating Expenses	Net Profit and Loss
Cost of property retired.....	695			
Value of salvage	599		96	
Incidental costs			558	
Total to Operating Expenses				654
Total to Profit and Loss				
To Material and Supplies				599
To Bills for Collection				392
To Other Accounts				
Net charge to investment account--Additions and Betterments				482
Total of distribution				2127

COST AT CURRENT ADJUSTMENT
 19
 MADE IN

Ownership
 N.P. 75%
 O.M.A. 25%

Budget reference: Item 89 Class of Work: No. 3
 Joint facility contract reference: Joint with CStPM&O Ry. Contract March 1, 1886.
 Joint with MStP&SSM Ry. Contract Jan. 1, 1910.

The location is on this company's property. To secure rights, it will be necessary Original Cost Adjustment Made in 5-21-1930

Location: Duluth
 Title: Relay tracks 1 and 2 at Cutler-Magner Lime Kiln

Reason: These tracks are laid with 56# and 68# mixed rail which is badly battered, curve worn and kinked. The heavy movement over these tracks causes excessive wear on ties and it is proposed to relay the Railway Company's portion of these tracks with 90# rail.

Work to be done by company force under charge of Superintendent

Accounting to concentrate in the office of Superintendent

Checked and Entered President's Office

Signature and Title: [Signature] Superintendent Date Jan. 9, 1929



APPROVED: [Signature] General Superintendent.	[Signature] Ass. Chief Engr. or Edr. Maint. of Way.	[Signature] General Manager.
[Signature] Mech. Supt., Supt. Telg. or Signal Engr.	[Signature] Chief Engineer.	[Signature] Vice President.
[Signature] For Comptroller.	[Signature] President.	Date of Exp. MAR 26 1929

COMPTROLLER'S RECORD OF NOTICE OF APPROVAL AND OF COMPLETION

Form No. 1345 issued 19 Work begun 19 Work finished June 11, 29 19

Tracks shown thus  are maintained by the Cutler-Magner Co. and covered for Relay on Est. # 434 JTD, Aug. 15-1928.

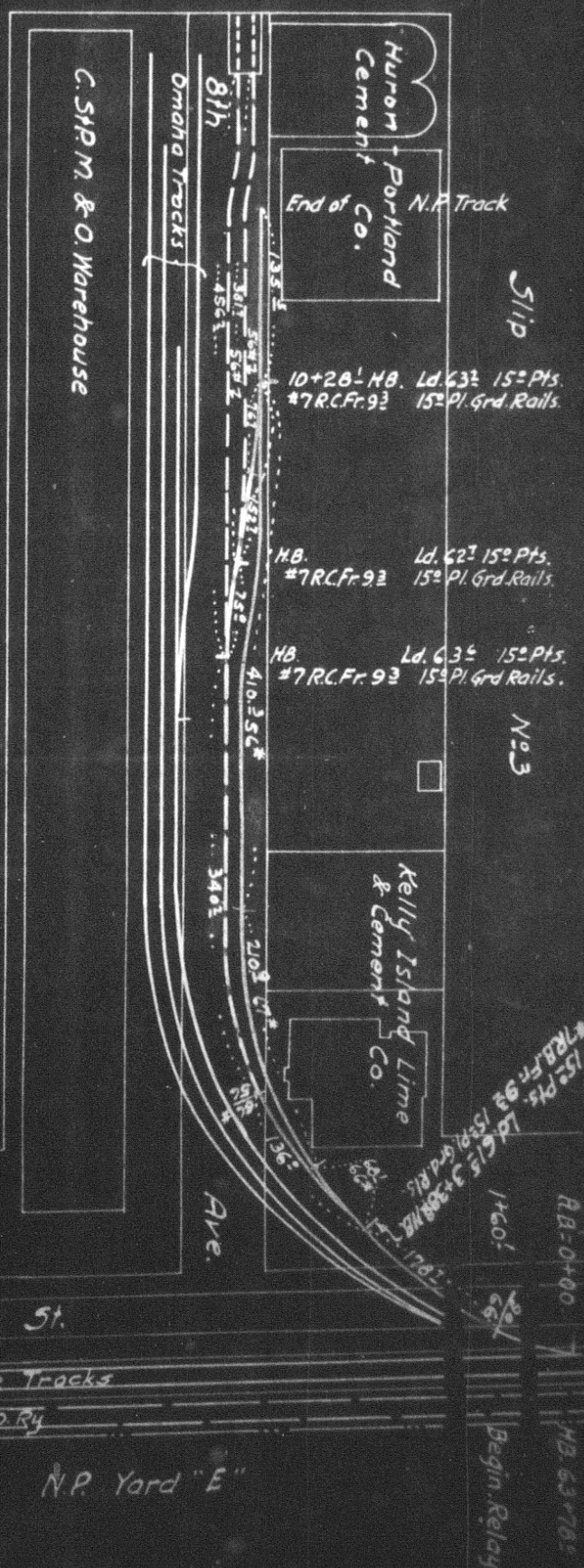

Prop'd Relay Cutler-Magner Lime Kiln Tracks #1 & 2.

Lake Superior Div'n Duluth Terminals.
 Duluth, Minn.
 Scale 1"=100'
 Prop'd Relay shown thus 
 Office of Dist. Engr., St. Paul, Dec. 12-1928.
 Val. Sec. #1, Minn.

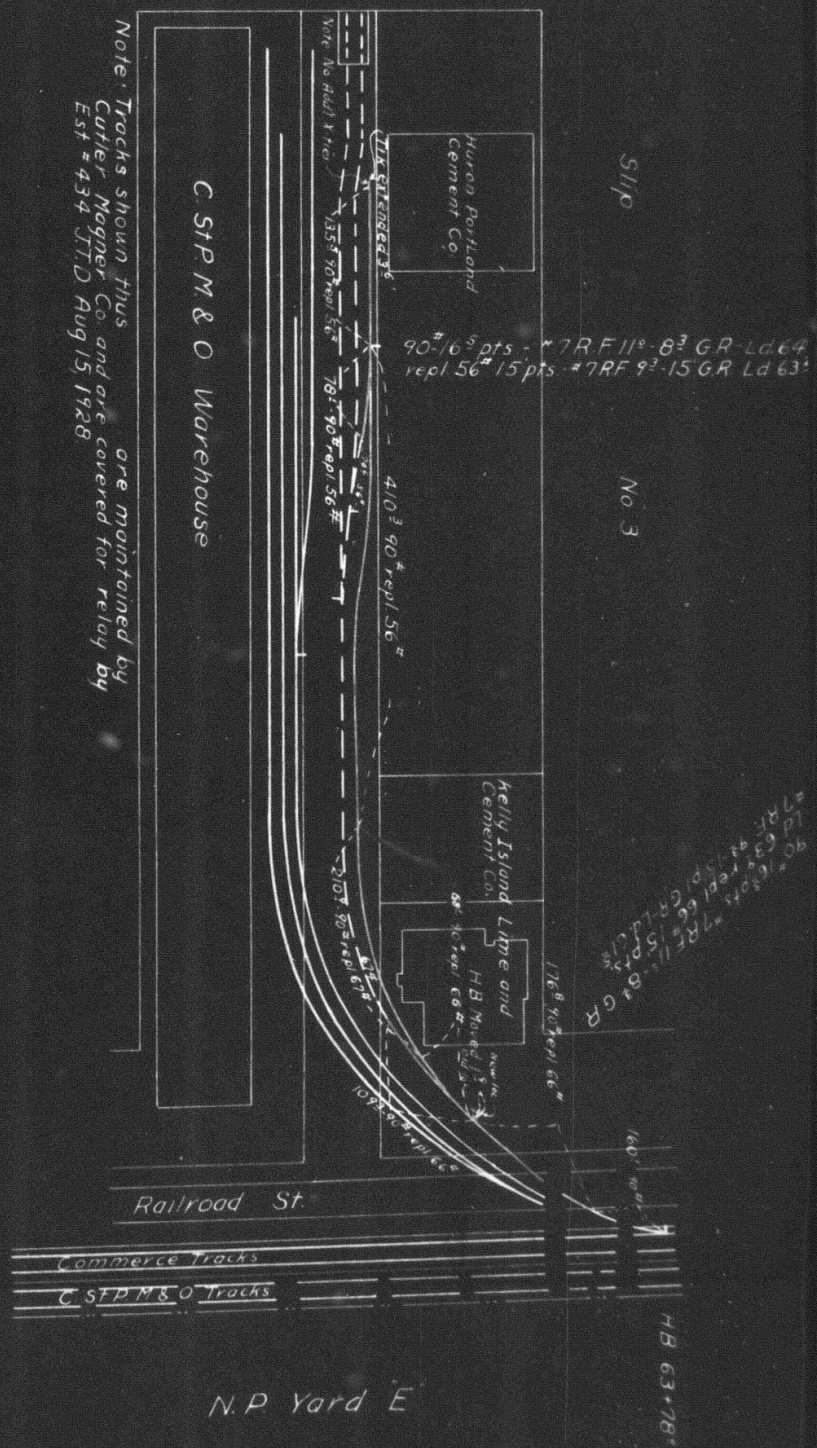

Note: Tracks shown thus are maintained by Cutler Wagner Co. and are covered for relay by Est #434 J.T.D. Aug 15, 1928

NPRY
 Lake Superior Divn Duluth Terminals
 Relay Tracks 1 & 2, Cutler Wagner Lime Kiln
 Duluth

Scale 1"=100'
 Office of Dist Engr St Paul Aug 3, 1929
 New Work Shown Red
 Relocated Work Shown Yellow
 Authorized Under AFE No 445-29
 Work Begun April, 1929
 Work Completed June 11, 1929
 Val Sec No 1-Minn