



N. P. 1963  
6-24

# NORTHERN PACIFIC RAILWAY COMPANY AUTHORITY FOR EXPENDITURE

COMPTROLLER'S COPY

SUPERINTENDENT'S No. **33**  
No. **1029**

DEPT. No. \_\_\_\_\_  
ENGINEERING DEPT. No. **80-29**

YEAR **1929**  
A. F. E. NO. **440**

**Seattle** Div. **Snoqualmie** BRANCH STATE **Wash**

VAL. SEC. No. **25**

AUTHORITY IS REQUESTED FOR A NET EXPENDITURE OF \$ **(454)**  
Accounting distribution as follows: (Distribution to be made in General Office.)

Cost of property retired	Operating Expenses	Profit and Loss	Net Operating Expenses	Net Profit and Loss
Value of salvage		<b>1019</b>		
Incidental costs		<b>710</b>		
Total to Operating Expenses				<b>309</b>
Total to Profit and Loss				<b>256</b>
To Material and Supplies				
To Bills for Collection				<b>565</b> ✓
To Other Accounts				<b>710</b> ✓
Net charge to investment account—Additions and Betterments				
Total of distribution				<b>1019</b> ✓
				<b>256</b> ✓

Budget reference: **NOT IN BUDGET.**  
Joint facility contract reference: **Non Joint**

Original Cost Adjustment  
Made in **9-16 1929**  
*Fair*

Class of Work: No. **10** ✓

The location is \_\_\_\_\_ on this company's property. To secure rights, it will be necessary

Location: **Campton, Washington**  
Title: **Remove Campbell Lumber Co.'s tracks**  
and **Track decrease 1030 ft.**

Reason: **Under AFE 857-1905 a track connection was constructed at Campton to serve the Campbell Lumber Co., and under AFE 876-1910 an additional spur track was installed to serve the same concern, the Railway Company furnishing metal only in both cases. The Main Line turnout was relaid with 90% metal under AFE 800-1923. These tracks have not been used for a number of years and as there is no prospect of it being needed in future it is recommended that the same be removed and material salvaged.**  
**Track decrease 1030 ft with two turnouts.**



Work to be done by **company force** under charge of **Divn. Superintendent at Seattle, Wn**  
Accounting to concentrate in the office of **Divn. Accountant at Seattle, Wn.**

Signature and Title: \_\_\_\_\_  
Checked and Entered President's Office  
Supt Date **Feb. 12 1929**

APPROVED: \_\_\_\_\_  
General Superintendent

\_\_\_\_\_  
Asst. Chief Engr. or Engr. in Charge of Work

\_\_\_\_\_  
Mech. Supt., Supt. Telgr. or Signal Engr.

\_\_\_\_\_  
Chief Engineer

\_\_\_\_\_  
For Comptroller

\_\_\_\_\_  
Date of Final Approval **MAR 22 1929**

\_\_\_\_\_  
Vice President

Form No. 1368 Issued  
COMPTROLLER'S RECORD OF NOTICE OF APPROVAL AND OF COMPLETION  
Work begun \_\_\_\_\_ 19\_\_\_\_  
Work finished **April 24 1929**

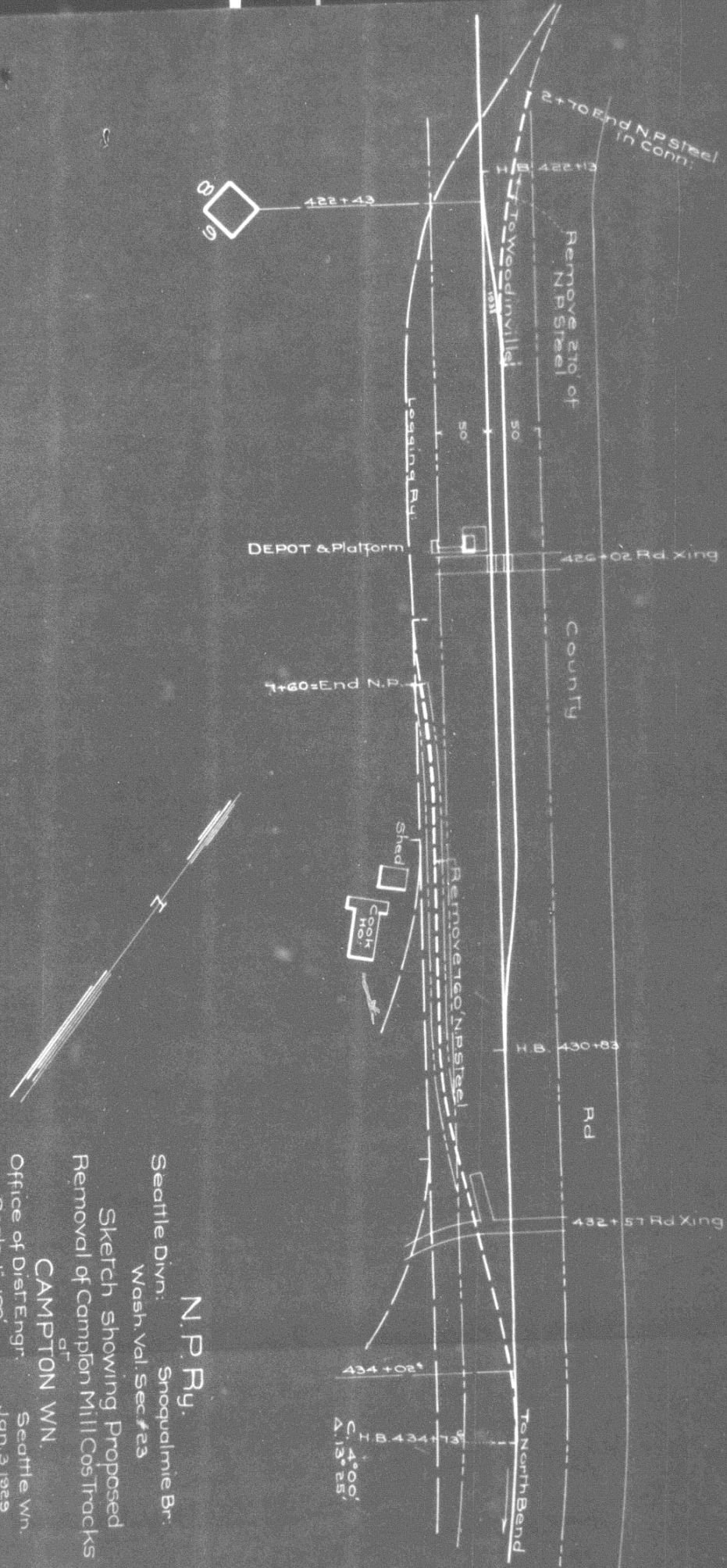

N.P. Ry.  
 Seattle Divn.: Snoqualmie Br.  
 Wash. Val. Sec. #23  
 Sketch showing Proposed  
 Removal of Campion Mill Co. Tracks  
 at  
 CAMPION Wn.  
 Seattle Wn.  
 Office of Dist. Engr.  
 Scale: 1"=100'  
 Jan. 3, 1929