

1363
6-24

COMPTROLLER'S COPY

NORTHERN PACIFIC RAILWAY COMPANY

AUTHORITY FOR EXPENDITURE

1929 1929
YEAR 1929

IDENT'S NO. 25

DEPT. No.

A. F. E. NO. 414

No. 101

ENGINEERING DEPT. No. 18

St. Paul

Div.

Main Line

DISTRICT
BRANCH

STATE

Minn.

VAL. SEC. No. 9

AUTHORITY IS REQUESTED FOR A NET EXPENDITURE OF \$712.

Accounting distribution as follows: (Distribution to be made in General Office.)

	Operating Expenses	Profit and Loss	Net Operating Expenses	Net Profit and Loss
Cost of property retired.....	\$ 57	\$	\$	\$
Value of salvage	15		42	
Incidental costs				
Total to Operating Expenses				42 ✓
Total to Profit and Loss				15 ✓
To Material and Supplies <i>843</i> <i>11/10/30</i> <i>73.00</i> <i>7.00</i> <i>1930</i> <i>Original Cost Adjustment Made in Final</i>				544 ✓
To Bills for Collection <i>1800-30. 612.00</i>				(329) ✓
To Other Accounts <i>P. & L. a/c 606</i>				999 ✓
Net charge to investment account—Additions and Betterments				1271 ✓
Total of distribution				

Budget reference: *App/Budget* Item 277

Class of Works No. 10 ✓

Joint facility contract reference: Not Joint Account

The location is on this company's property. To secure rights, it will be necessary **Nothing**

Location: **St. Cloud, Minnesota**

Title **Proposed spur track for Theo. Jensen.**

and

Reason: **Mr. Theo. Jensen, Contractor, has purchased the building formerly owned by Mr. Norman Cooper and occupied by the Excelsior Tool Works located west of the station, and has applied for a spur track to serve the plant.**

The situation has been looked over and it is proposed to construct a spur 230 feet in length leading off the westward siding, on the basis of our regular Industrial Track Agreement, the Railway Company to bear the expense to the clearance point, the applicant to bear the balance of the expense. Track Agreement, Form 802, properly signed by applicant is enclosed.

The proposed arrangement meets with Mr. Jensen's approval as well as that of our Traffic Department, and will result in a business of from 12 to 15 cars annually.

It is recommended the work be done.

Work to be done by company force under charge of **Superintendent**

Accounting to concentrate in the office of **Division Accountant**

Signature and Title: *[Signature]* Superintendent

Date **Febr. 2, 1929**

APPROVED *[Signature]* General Superintendent. *[Signature]* Asst. Chief Engr. or Engr. in Charge of Work. *[Signature]* General Manager.

Mech. Supt., Supt. Telg. or Signal Engr. *[Signature]* Chief Engineer. *[Signature]* GENERAL TRAFFIC MANAGER. *[Signature]* Vice President.

[Signature] For Comptroller. *[Signature]* Charles Sommers President. Date of Final Approval **MAR 21 1929**

COMPTROLLER'S RECORD OF NOTICE OF APPROVAL AND OF COMPLETION

Form No. 1345 issued. 19. Work begun. 19. Work finished **6-30 1929**



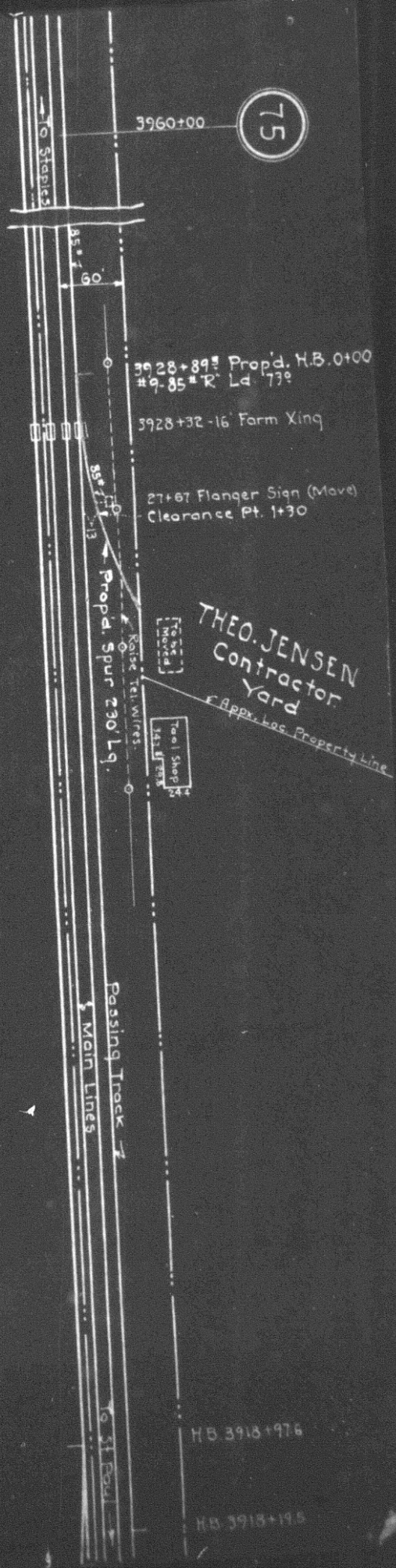

N.P.R.R.
 St. Paul Div. Main Line
 Prop'd. Spur for Mr. Theo. Jensen
 at St. Cloud, Minn.
 Scale: 1"=100'
 Office of Dist. Engr. St. Paul, Dec. 12, 1928
 Val. Sec. # 9 Minn.
 Proposed work shown in Red.