



N. P. 1363
6-24

NORTHERN PACIFIC RAILWAY COMPANY

AUTHORITY FOR EXPENDITURE

COMPTROLLER'S COPY

1929
YEAR 1929

SUPERINTENDENT'S No. 30

1929

DEPT. No.

ENGINEERING DEPT. No. 76-29

A. F. E. No.

411

Seattle Div. Everett

BRANCH

STATE

Wash

VAL. SEC. No. 9-A

AUTHORITY IS REQUESTED FOR A NET EXPENDITURE OF \$ 849

Accounting distribution as follows: (Distribution to be made in General Office.)

	Operating Expenses	Profit and Loss	Net Operating Expenses	Net Profit and Loss
Cost of property retired.....	\$ 73	\$	\$	\$
Value of salvage.....	49		24	
Incidental costs.....			96	
Total to Operating Expenses.....				\$ 120 ✓
Total to Profit and Loss.....				
To Material and Supplies.....				49 x
To Bills for Collection.....				175 x
To Other Accounts.....				19 x
Net charge to investment account—Additions and Betterments.....				748 ✓
Total of distribution.....				\$ 1073 ✓

COST AT CURRENT ADJUSTMENT

78000 MADE IN
12500
8513-47-09 Original Cost Adjustment
Made in final 19
June 27
P&L Donations 605

Budget reference: Item 277-1929

Class of Work: No. 10 ✓

Joint facility contract reference: Non Joint

The location is on this company's property. To secure rights, it will be necessary

Location: Everett, Washington

Title: Spur track to serve the Milgood Investment Co.,
and Track increase 96 ft.

Reason: The Milgood Investment Co. Washington Corporation connected with Ed. Miller & Co., who are distributors of Richfield Oil Products have purchased from the Northern Pacific Railway Co., a portion of Lots 1 to 6 inclusive in Block 662, City of Everett, on which they are constructing a distributing station and have made application for a spur track to serve the station. The people connected with the distribution of Richfield products are very friendly to the Northern Pacific and it is expected the future business will amount to about ten cars per month from Seattle to Everett. It is recommended that this spur be constructed on the basis of the Northern Pacific standing expense from headblock to clearance point, a distance of 91 ft, balance of track to be paid for by applicant. Emergency authority to proceed with the work was granted by General Manager on January 26, 1929. Industrial Track Agreement form 802 signed by A.R. Mills, President and Ed. Miller Vice Pres. of the Milgood Investment Co., dated Feb. 5, 1929 is attached.

Work to be done by company force under charge of Divn. Superintendent at Seattle, Wn.

Accounting to concentrate in the office of Divn. Accountant at Seattle, Wn.

Checked and Entered President's Office

Signature and Title: J. J. [Signature] Supt. Date Feb. 6 1929

APPROVED: [Signature] General Superintendent, [Signature] Ass. Chief Engr. or Engr. Maint. of Way, [Signature] General Manager.

[Signature] Mech. Supt., Supt. Telg. or Signal Engr., [Signature] Western Traffic Manager

[Signature] Chief Engineer, [Signature] Vice President

[Signature] For Comptroller, [Signature] President, Date of Final Approval { MAR 19 1929

COMPTROLLER'S RECORD OF NOTICE OF APPROVAL AND OF COMPLETION

Form No. 1345 issued 19. Work begun 19. Work finished March 12, 1929

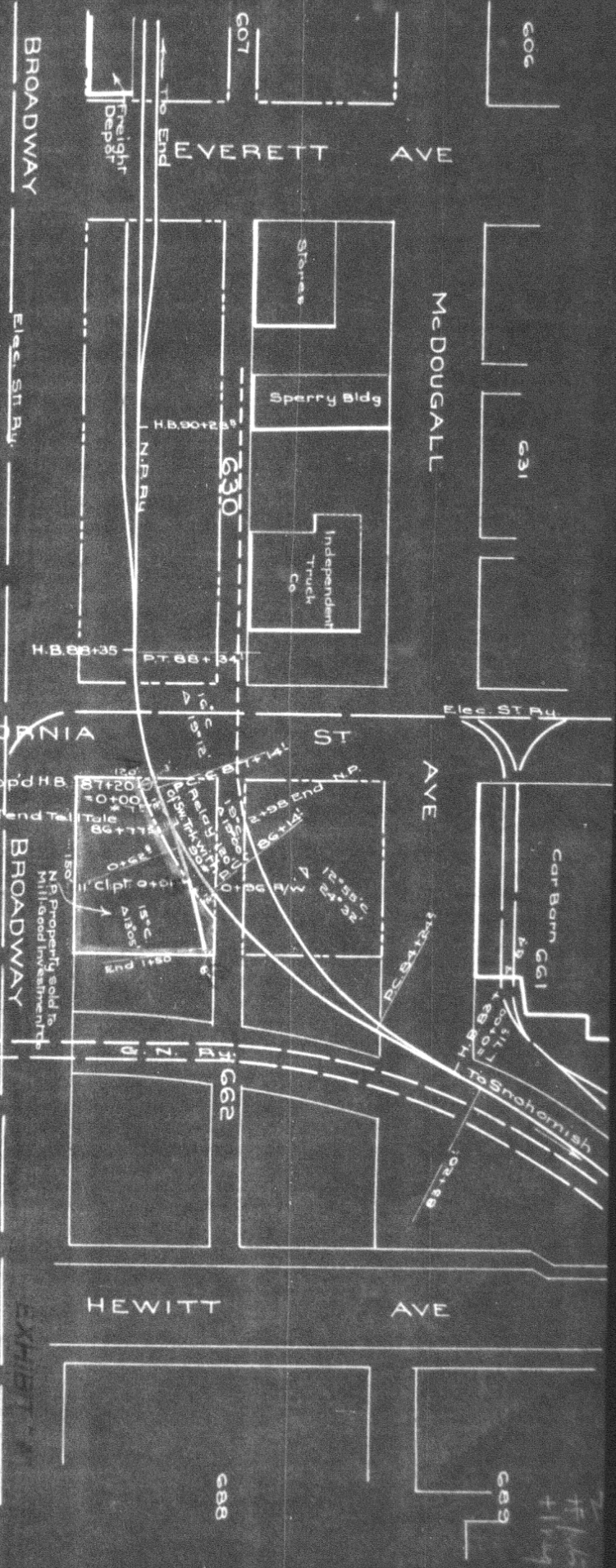
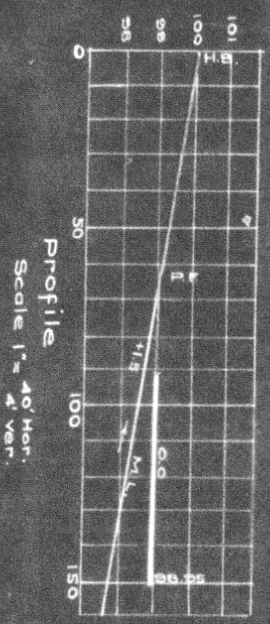

N.P.R.y.
 Seattle Div. Everett Branch
 Wash. Val. Sec. 9A
Proposed Spur for
Mill-Good Investment Co.
 of
EVERETT W.N.
 Office of Dist. Engr. Seattle Wn.
 Scale 1" = 100' Dec. 10 1928
 Revised Jan 29 1929

EXHIBIT A

+ 1/4
 1/4