

N. P. 1363
6-24

NORTHERN PACIFIC RAILWAY COMPANY
1929 AUTHORITY FOR EXPENDITURE

COMPTROLLER'S COPY

1929 1929
YEAR 1929

SUPERINTENDENT'S No. 23

DEPT. No.

ENGINEERING DEPT. No. 29

A. F. E. No. 388

Lake Superior Div. Duluth Terminals

DISTRICT STATE Minn.

VAL. SEC. No.

AUTHORITY IS REQUESTED FOR A NET EXPENDITURE OF \$ 939.00

Accounting distribution as follows: (Distribution to be made in General Office.)

| | Operating Expenses | Profit and Loss | Net Operating Expenses | Net Profit and Loss |
|---|--------------------|-----------------|------------------------|---------------------|
| Cost of property retired..... | 230 | | | |
| Value of salvage | 182 | | 48 | |
| Incidental costs | | | 54 | |
| Total to Operating Expenses | | | | 102 X |
| Total to Profit and Loss | | | | |
| To Material and Supplies | | | | 560 X |
| To Bills for Collection | | | | 496 X |
| To Other Accounts | | | | |
| Net charge to investment account--Additions and Betterments | | | | 837 X |
| Total of distribution | | | | 1995 X |

Original Cost Adjustment
Made in 2-27-1929
Final

Added to Joint Valuation
AUG 1930

Added to Joint Valuation
NOV 1930

Budget reference: Item 276-1929

Joint facility contract reference: Joint with CSTPM&O Ry.

Joint with MSTP&SSM Ry.

3-1-1886
1-1-1910
Class of Work: No. 10

The location is ----- on this company's property. To secure rights, it will be necessary

Location: Duluth

Title: Install additional crossover and abandon and move existing crossover, 9th Avenue West.

Reason: Undue delay is experienced when switching tracks at the McDougall-Duluth Terminal Building, 9th Avenue West and also when switching our docks 3 and 4 when the Omaha switch engine is also switching at the same time at their dock located at 7th Avenue West which is almost a daily occurrence and causes delay to one or the other of the engines.

To permit getting away from this condition, it is proposed to take out crossover track at 9th Avenue West, reversing and placing it a short distance west of its present location as shown in yellow and install an additional crossover track as shown in red on attached print. This will permit Omaha engines to go directly into their dock without interfering with our switching operations at the McDougall-Duluth Terminal and our own docks at 7th Avenue West.

The Omaha are to stand their proportion of the cost in taking care of this work.

Work to be done by company force under charge of Superintendent

Accounting to concentrate in the office of Superintendent

Signature and Title: *H. Jacobson* Superintendent Date Jan. 10, 1929

APPROVED: *H. H. Stricker* General Superintendent. *J. H. ...* Ass. Chief Engr. or Insp. *J. H. ...* General Manager.

... Mech. Supt., Supt. Telegraph or Signal Engr. *...* Chief Engineer. *...* Vice President.

... For Comptroller. *Charles ...* President Date of Final Approval: MAR 1929

COMPTROLLER'S RECORD OF NOTICE OF APPROVAL AND OF COMPLETION

1345 issued 19..... Work begun 19..... Work finished

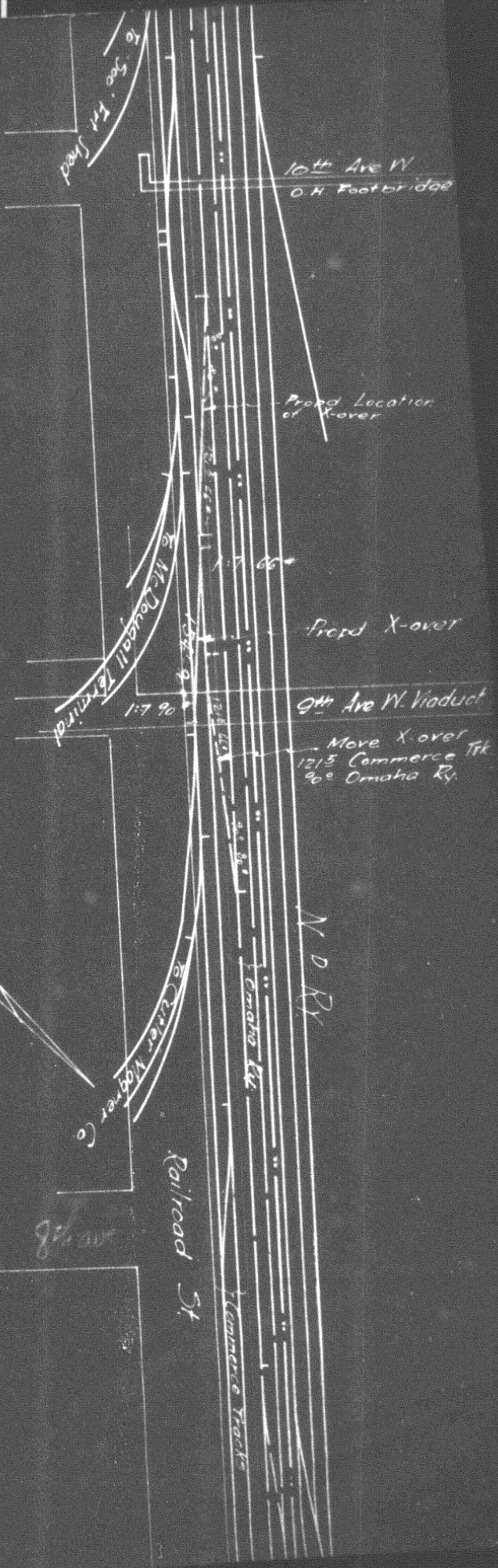

Lake Superior Division Duluth Terminals
 Propd Additl X-over & Relocation of X-over
 Duluth Minn.

Office of Dist Engr St Paul April 23 1928
 Scale 1" = 100'
 Propd location X-over
 Valuation Section No 1 Minn.

N. D. Ry.

980