



N. P. 1363
6-24

NORTHERN PACIFIC RAILWAY COMPANY

AUTHORITY FOR EXPENDITURE

1929 DEPT. NO. 64
ENGINEERING DEPT. NO. 148.

COMPTROLLER'S OFFICE

1929
YEAR 1929

A. F. E. NO. 381

SUPERINTENDENT'S NO. 136.
No.

Lake Superior. DIV. Duluth Terminals. DISTRICT STATE Minnesota VAL. SEC. NO. 1.
BRANCH

AUTHORITY IS REQUESTED FOR A NET EXPENDITURE OF \$3717.00
(Distribution to be made in General Office.)

Accounting distribution as follows:	Operating Expenses	Profit and Loss	Net Operating Excess	Net Profit and Loss
Cost of property retired				
Value of salvage				
Incidental costs				
Total to Operating Expenses				
Total to Profit and Loss				
To Material and Supplies				
To Bills for Collection				
To Other Accounts				
Net charge to investment account—Additions and Betterments				
Total of distribution				

Original Cost Adjustment 303
Made in May 1929
Final

Added to Joint Valuation 1930
Month MAY

(592)
4006
\$3717

Budget reference: Not in Budget.

Joint facility contract reference: Joint with CMST&P RR., Contract October 1, 1900-
on this company's property. To secure rights, it will be necessary

The location is

Location: DULUTH-

Title: COST OF CHANGES AT DOCK NO. 6 FOR WESTERN TRANSIT COMPANY-

and

Reason: Preparatory to leasing Dock No. 6 to the Western Transit Company it was necessary to provide additional platform, construct a retaining wall and fill in at the lake end. As it was necessary for this dock to be put in condition promptly for the handling of automobiles from boats to cars, work was informally authorized by General Superintendent on August 31, 1928, and this AFE is submitted to properly account for the expenditure.

Work completed by company force under charge of Superintendent.

Accounting to concentrate in the office of Superintendent.
Signature and Title: W. H. Jacobus

Checked and Entered
President's Office

Superintendent Date Nov. 3, 1928

APPROVED: H. H. Strachan
General Superintendent.

Asst. Chief Engr. or Equip. Maint. of Way

Mech. Supt., Supt. Telegraph or Signal Engr.

Bernard Blum
Chief Engineer.

For Comptroller.

Charles Souce
President

Date of Final Approval

MAR 13 1929

COMPTROLLER'S RECORD OF NOTICE OF APPROVAL AND OF COMPLETION

19 Work begun

19 Work finished

Minnesota Slip
 (Dredging of Slip to be done by the Rust Parker Co.)

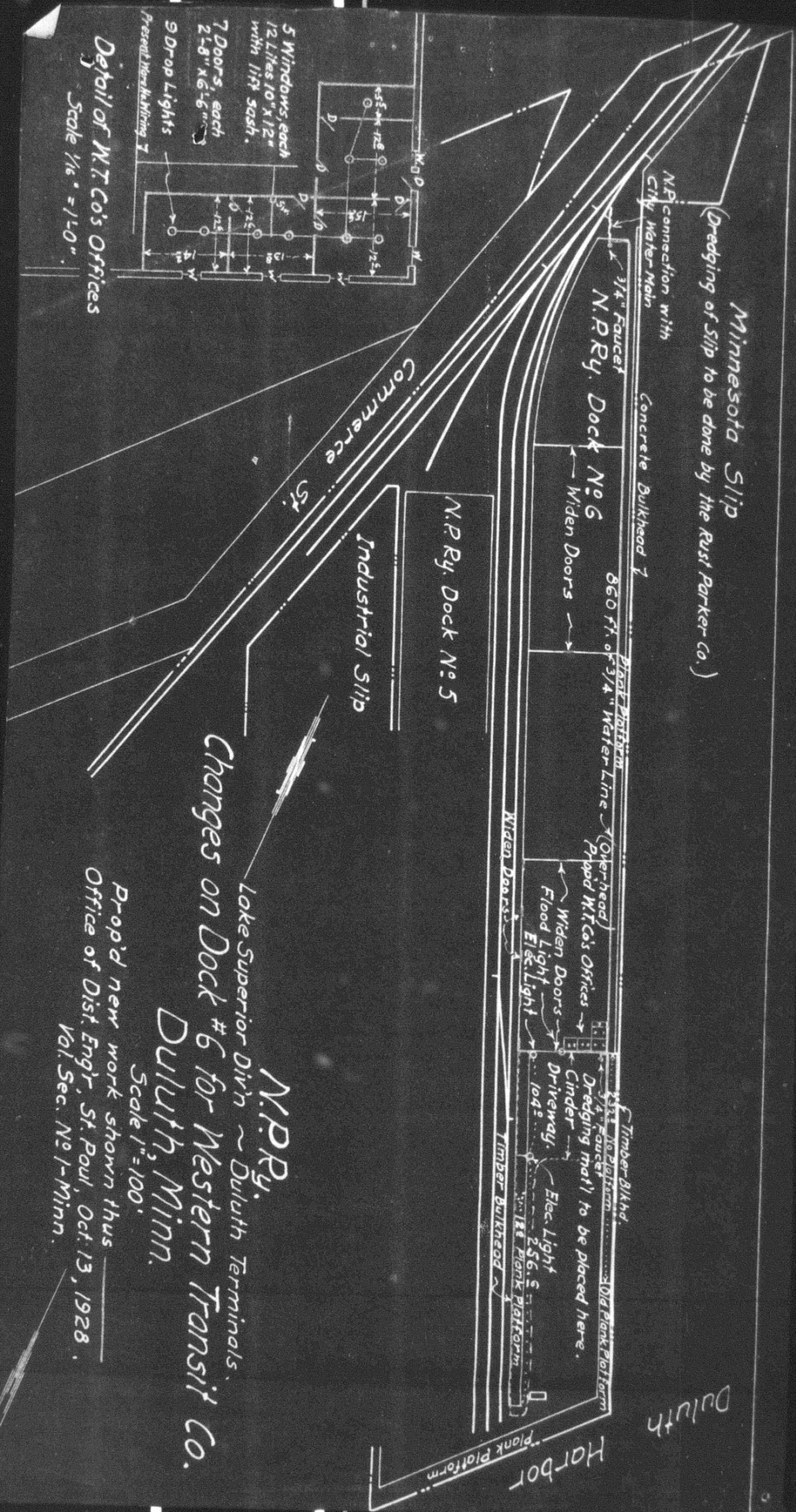

5 Windows, each
 12 Lites 10" x 12"
 with lift sash.
 7 Doors, each
 2'-8" x 6'-6"
 9 Drop Lights
 Present When Writing 7

Detail of W.T. Co's Offices
 Scale 1/16" = 1'-0"

Changes on Dock #6 for Western Transit Co.
 Lake Superior Div'n ~ Duluth Terminals.
 Duluth, Minn.

Prop'd new work shown thus
 Office of Dist Engr, St. Paul, Oct. 13, 1928.
 Vol. Sec. No 1-Minn.

Duluth

Harbor

Minnesota Slip
 (Dredging of slip to be done by the Rust Parker Co.)

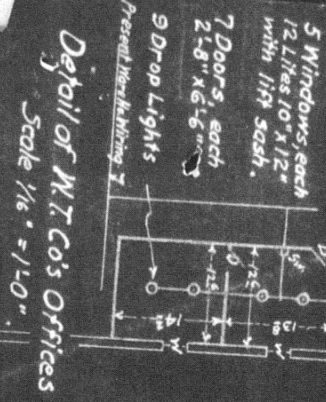
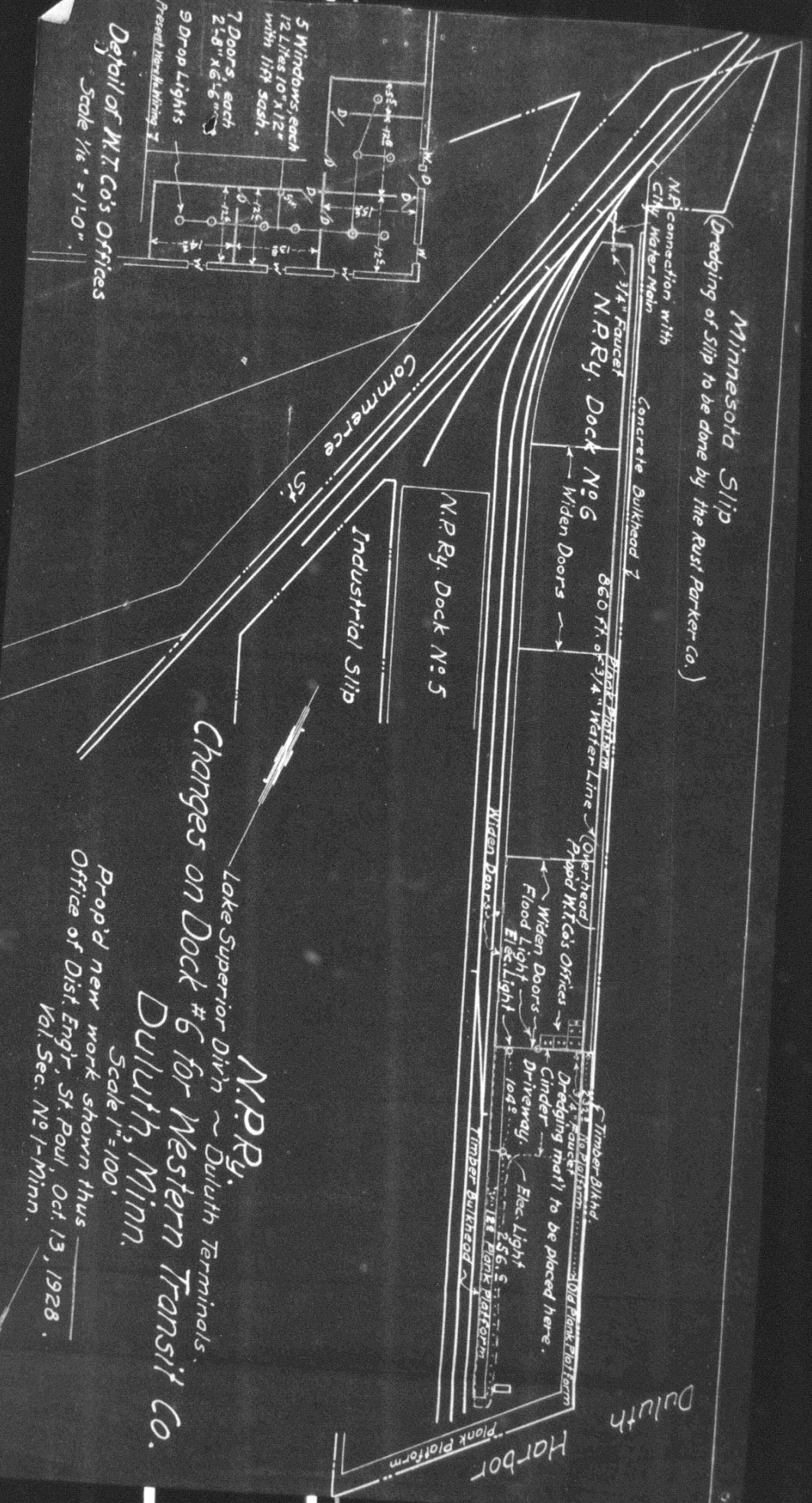

5 Windows each
 12 Lites 10" x 12"
 with 11ft Sash.
 7 Doors, each
 2'-6" x 6'-6"
 9 Drop Lights
 Present Wiring

Detail of M.T. Co's Offices
 Scale 1/16" = 1'-0"

N.P.Ry.
 Lake Superior Div'n ~ Duluth Terminals.
 Changes on Dock #6 for Western Transit Co.
 Duluth, Minn.

Prop'd new work shown thus
 Office of Dist. Engr. St. Paul, Oct. 13, 1928.
 Val. Sec. No 1-Minn.

Duluth

Harbor