



N. P. 1363
6-24

NORTHERN PACIFIC RAILWAY COMPANY

AUTHORITY FOR EXPENDITURE

1929 1929
YEAR 1928

SUPERINTENDENT'S No. 21

DEPT. No.

A. F. E. No.

327

ENGINEERING DEPT. No. 27-29

TACOMA

DIV. Tacoma Terminals

DISTRICT STATE Wash

VAL. SEC. No. 4

AUTHORITY IS REQUESTED FOR A NET EXPENDITURE OF \$ 28,928

Accounting distribution as follows: (Distribution to be made in General Office.)

	Operating Expenses	Profit and Loss	Net Operating Expenses	Net Profit and Loss
Cost of property retired	263		206	
Value of salvages	57		844	
Incidental costs				1050 ✓
Total to Operating Expenses				
Total to Profit and Loss				57 ✓
To Material and Supplies				443 ✓
To Bills for Collection	G.N.P. 84.00 O.W.R.R.N. 357.00			
To Other Accounts				27878 ✓
Net charge to investment account—Additions and Betterments				29428 ✓
Total of distribution				

Original Cost Adjustment
Made in 4-71 1930

Final
riv-10-26-31

Budget reference: Item 274-1927

Class of Work No. 10 ✓

Joint facility contract reference: Non Joint.

The location is on this company's property. To secure rights, it will be necessary to secure permit from city of Tacoma to cross public Street
Location: Tacoma

Title Additional yard tracks
Track increase 8602 feet.

Reason: The number of logs received by the St. Paul & Tacoma Lumber Company mill in Tacoma has increased until it now runs from 135 to 150 cars per day. These cars have to be classified, after scaling, into several groups, and unloaded on different ponds accordingly. Most of the unloading must be done on the tides, which restricts the time available very materially. At present, trains are brought into Head of Bay Yard and then pulled back out on the drawbridge main line and over onto various industry tracks on the mill side of the drawbridge line. It is necessary to place these cars on the switching leads, industry spurs, etc., in order to have room to handle them at all. This interferes with the work of industry engines and seriously slows up the whole operation. The matter has been still further aggravated by increase in business at the plant of the Western Concrete Pipe Company whose track had been used for holding about 28 cars of logs pending dumping. Their business has increased now so that the track cannot be used for handling logs, making additional trips necessary to Head of Bay Yard to get logs. (over)

Work to be done by company force under charge of Superintendent

Checked and Entered
President's Office

Accounting to concentrate in the office of

Division Accountant

Date Oct. 11 1928

Signature and Title	<i>[Signature]</i> Superintendent	<i>[Signature]</i> General Manager
APPROVED:	<i>[Signature]</i> General Superintendent	<i>[Signature]</i> Vice President
	<i>[Signature]</i> Mech. Supt., Spnt. Trng. or Signal Engr.	<i>[Signature]</i> Western Traffic Manager
	<i>[Signature]</i> Chief Engineer	<i>[Signature]</i> President
	<i>[Signature]</i> For Comptroller	<i>[Signature]</i> President

COMPTROLLER'S RECORD OF NOTICE OF APPROVAL AND OF COMPLETION

Form No. 1345 issued Work begun Work finished

The proposed tracks provide for the log trains from the camps pulling in to them directly, and the switch engine working from these tracks direct to the ponds, and building up the trains of empties on these tracks for return direct to the camps.

This will reduce the handling of cars materially and will relieve the congestion in Head of Bay Yard very decidedly.

A careful estimate of the probable results indicates a saving of one switch engine shift per day during about nine months of the year, or a saving of approximately \$10,000 per year in actual out-of-pocket expense.

city water way

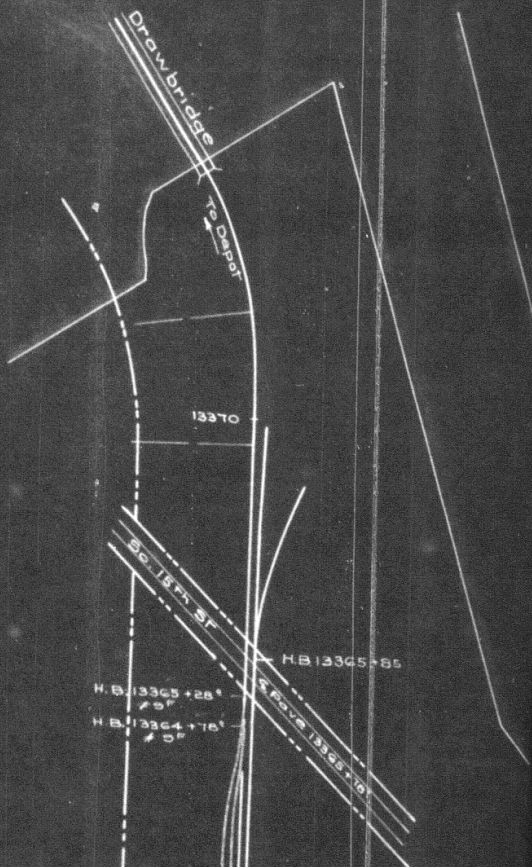

Sketch showing Clearance on Supports for Protection Screen under Lbr. Tram

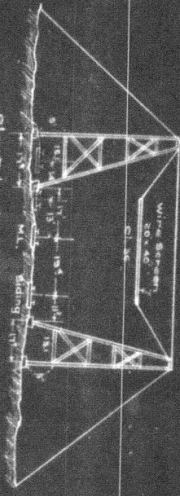

Sp. tower of W. O. Overhead Tram To be moved
H.B. 13358 + 27
H.B. 13358 + 08
Overhead Tram Line
Semaphore To be moved

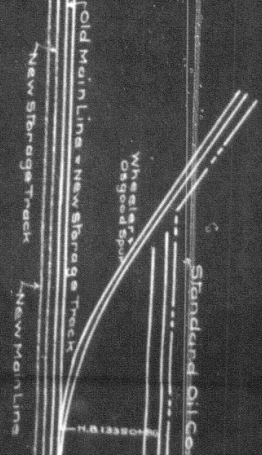

Commencement Bay

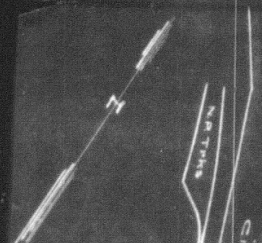

97' P.C.T. Lbr. Co. Spur

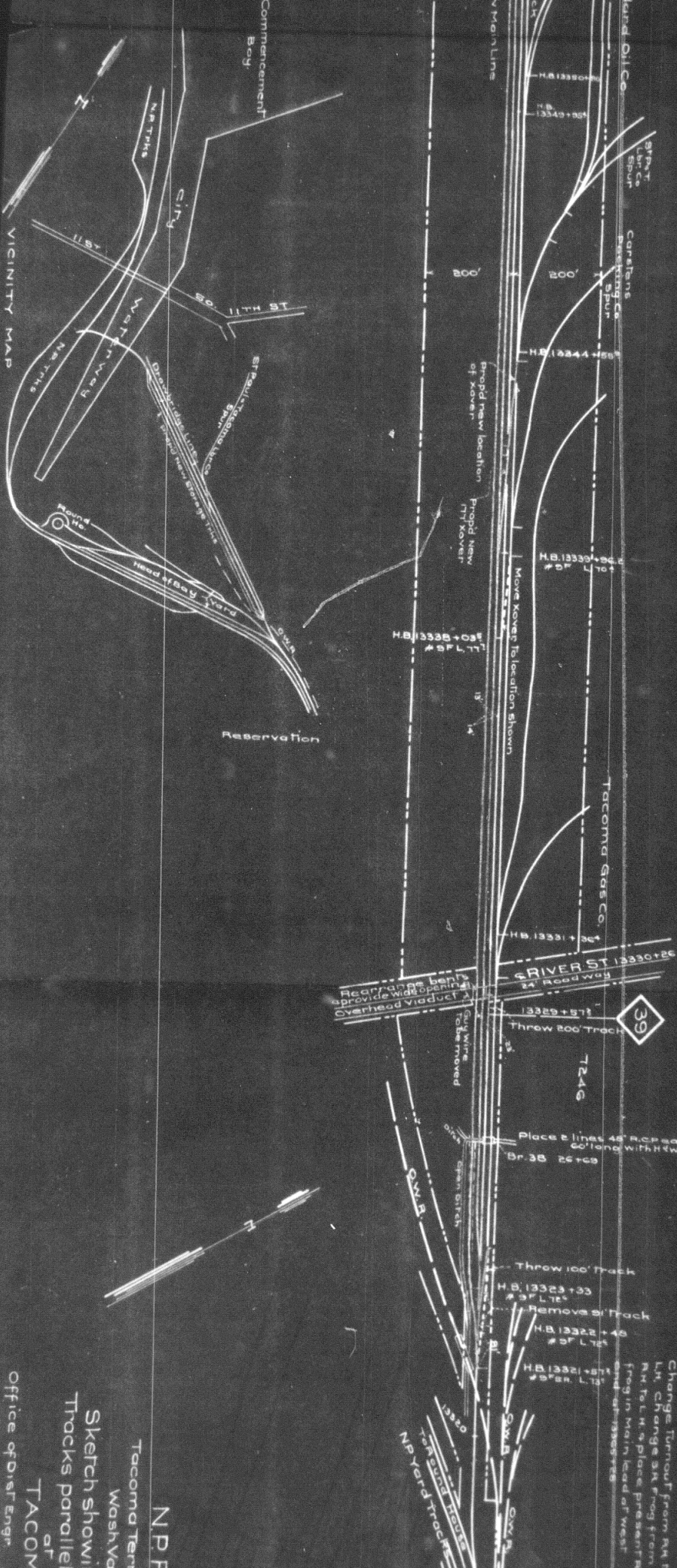

N.P.R.
 Tacoma Term
 Wash Yrd
 Sketch showing
 Tracks parallel
 at
 TACOM
 Office of Dist Engr
 Scale 1" = 200'

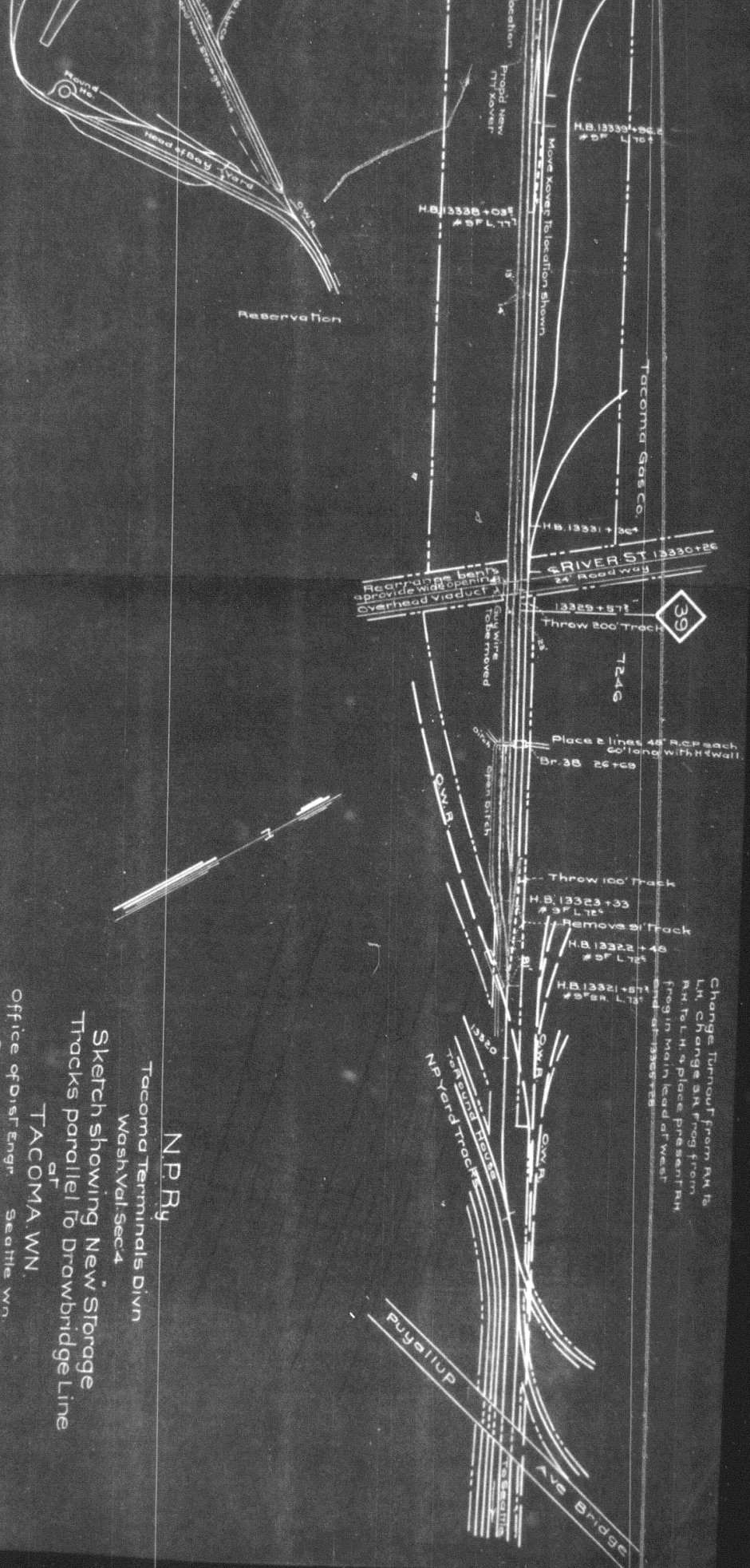

N.P.R.

Tacoma Terminals Divn
Wash. Val. Sec. 4

Sketch showing New Storage
Tracks parallel to Drawbridge Line

TACOMA, W.N.

Office of Dist. Engr. Seattle, Wn.
Scale: 1" = 200'
Oct. 3, 1928.