



N. P. 1363
6-24

NORTHERN PACIFIC RAILWAY COMPANY AUTHORITY FOR EXPENDITURE

SUPERINTENDENT'S No. **16**
No. **1029**

DEPT. No. _____
ENGINEERING DEPT. No. **24-29**

YEAR **1929**
A. F. E. No. **325**

Tacoma Div. **Point Line** DISTRICT STATE **Wash**
BRANCH _____ VAL. SEC. No. **28**

AUTHORITY IS REQUESTED FOR A NET EXPENDITURE OF **(45)**
Accounting distribution as follows: (Distribution to be made in General Office.)

Cost of property retired	Operating Expenses	Profit and Loss	Net Operating Expenses	Net Profit and Loss
Value of salvage		173		
Incidental costs		81		92
Total to Operating Expenses				36
Total to Profit and Loss	P & L 619 Loss on Retired R & E			
To Material and Supplies				128
To Bills for Collection				81
To Other Accounts				
Net charge to investment account—Additions and Betterments				
Total of distribution				173
				36

Original Cost Adjustment
Made in June 1929
Final

Budget reference: **NOT IN BUDGET.**

Joint facility contract reference: **N. P. Ry }
O.W. Ry } 6-1-11**

Class of Work: No. **10**

The location is _____ on this company's property. To secure rights, it will be necessary

Location: **Hispally**
Title: **Removing outfit-car track**
and **Track decrease 210 ft.**

Reasons: **APR 6-1920 provided for making permanent a temporary track which had been put in for spurring out of extra cars; and H&B outfit cars - this being frequently required on account of numerous slides occurring in the vicinity of Hispally. It is not considered that this track will be longer required therefore it is proposed to remove same and salvage the material, as per blue print and estimate furnished by Engineering Department.**

Work to be done by company force under charge of **Superintendent**

Accounting to concentrate in the office of **Division Accountant**

Checked and Examined
President's Office



Signature and Title: _____
Date: **Jan 29 1929**

APPROVED: _____ General Superintendent.	_____ Asst. Chief Engr. or Engr. in-charge of Way.	_____ General Manager.
_____ Mech. Sup't., Supt. Trench or Signal Engr.	_____	_____
_____ Chief Engineer.	_____	_____
_____ For Comptroller.	_____	_____

Date of Final Approval: **MAR 2 1929**

COMPTROLLER'S RECORD OF NOTICE OF APPROVAL AND OF COMPLETION

Form No. 1345 issued _____
Work begun _____
Work finished **March 26 1929**

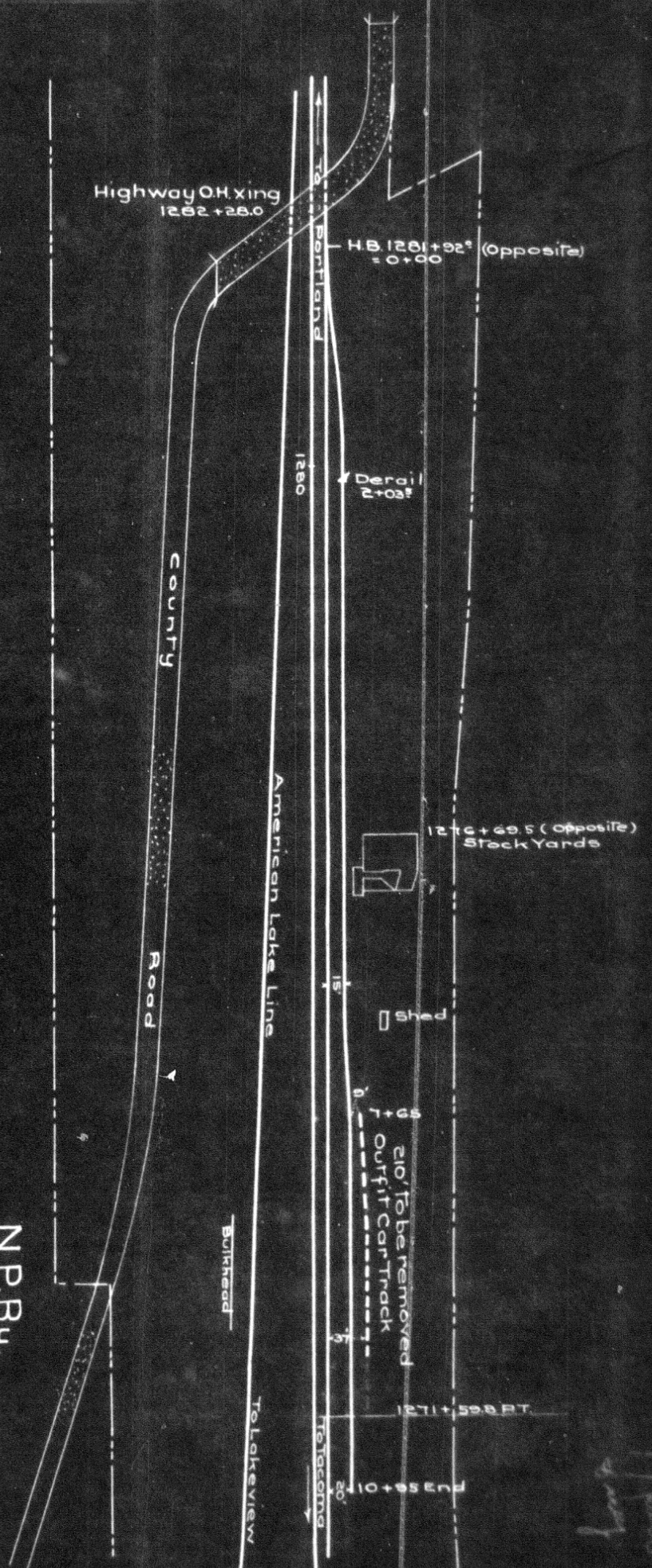

N.P. Ry.
 Tacoma Divn. Pt. Defiance Line
 Wash. Val. Sec. #31
 Sketch showing Proposed Removal
 of Temporary Outfit Car Track.

NISQUALLY WN.
 Office of Dist. Engr. Seattle Wn.
 Scale 1" = 100' Jan. 23 1929