



N. P. 1363
6-24

NORTHERN PACIFIC RAILWAY COMPANY AUTHORITY FOR EXPENDITURE

1929
YEAR 1929

SUPERINTENDENT'S NO. 25
NO.

DEPT. No.
ENGINEERING DEPT. No. 70-29

A. F. E. NO. 323

Seattle Div. Second

DISTRICT STATE Wash VAL. SEC. No. 9

AUTHORITY IS REQUESTED FOR A NET EXPENDITURE OF \$ (1626)

Accounting distribution as follows: (Distribution to be made in General Office.)

Cost of property retired	\$ 2672	Profit and Loss	606	P&L Net Operating Expense	619	Net Profit and Loss	606
Value of salvage	1626		353				
Incidental costs				1046		353	118

Total to Operating Expenses								
Total to Profit and Loss	P & L 619 Loss on Retired R & E						\$ 1626	
To Material and Supplies						1046	✓	
To Bills for Collection						1626	✓	
To Other Accounts	P & L 606 Donations						531	✓
Net charge to investment account—Additions and Betterments						235	✓	
Total of distribution						2907	✓	
						531	✓	

Original Cost Adjustment
Made in 10-11-1929
Janet

Budget reference: NOT IN BUDGET.

Joint facility contract reference: Non Joint

Class of Work: No. 10

The location is on this company's property. To secure rights, it will be necessary

Location: **Frairie, Washington (near)**

Title: **Remove track serving R.R. Wheaton**

and: **Track decrease 1549.8 ft.**

Reason: Under AFE 571-24 a track was constructed near Frairie to serve R.R. Wheaton, the Railway Company furnishing metal and all other expense borne by applicant. All the timber adjacent to this track has been cut and shipped out and there is no further use for the spur, other than to load out three donkey engines owned by Mr. Wheaton, who has been notified and given an opportunity to have these engines removed before removal of the track. The track is covered by Surety Bond for value of rail and cost of removal. It is recommended that track be removed. Track decrease will be 1549.8 ft.

Work to be done by company force under charge of **Divn. Superintendent at Seattle, Wa.**

Accounting to concentrate in the office of **Divn. Accountant at Seattle, Wa.**

Signature and Title: *J. Rogler* Supt. Date Feb. 1 29

APPROVED: <i>[Signature]</i> General Superintendent.	<i>[Signature]</i> Asst. Chg. Engr. or Engr. Maint. of Way	<i>[Signature]</i> General Manager.
<i>[Signature]</i> Mech. Supt., Supt. Telg. or Signal Engr.	<i>[Signature]</i> Western Pacific Manager	<i>[Signature]</i> Vice President.
<i>[Signature]</i> Chief Engineer.	<i>[Signature]</i> GENERAL TRAFFIC MANAGER	
<i>[Signature]</i> For Comptroller.	<i>[Signature]</i> President	Date of Final Approval { MAR 2 1929 } 19.



COMPTROLLER'S RECORD OF NOTICE OF APPROVAL AND OF COMPLETION

Form No. 1345 issued

19 Work begun

19 Work finished

[Signature]

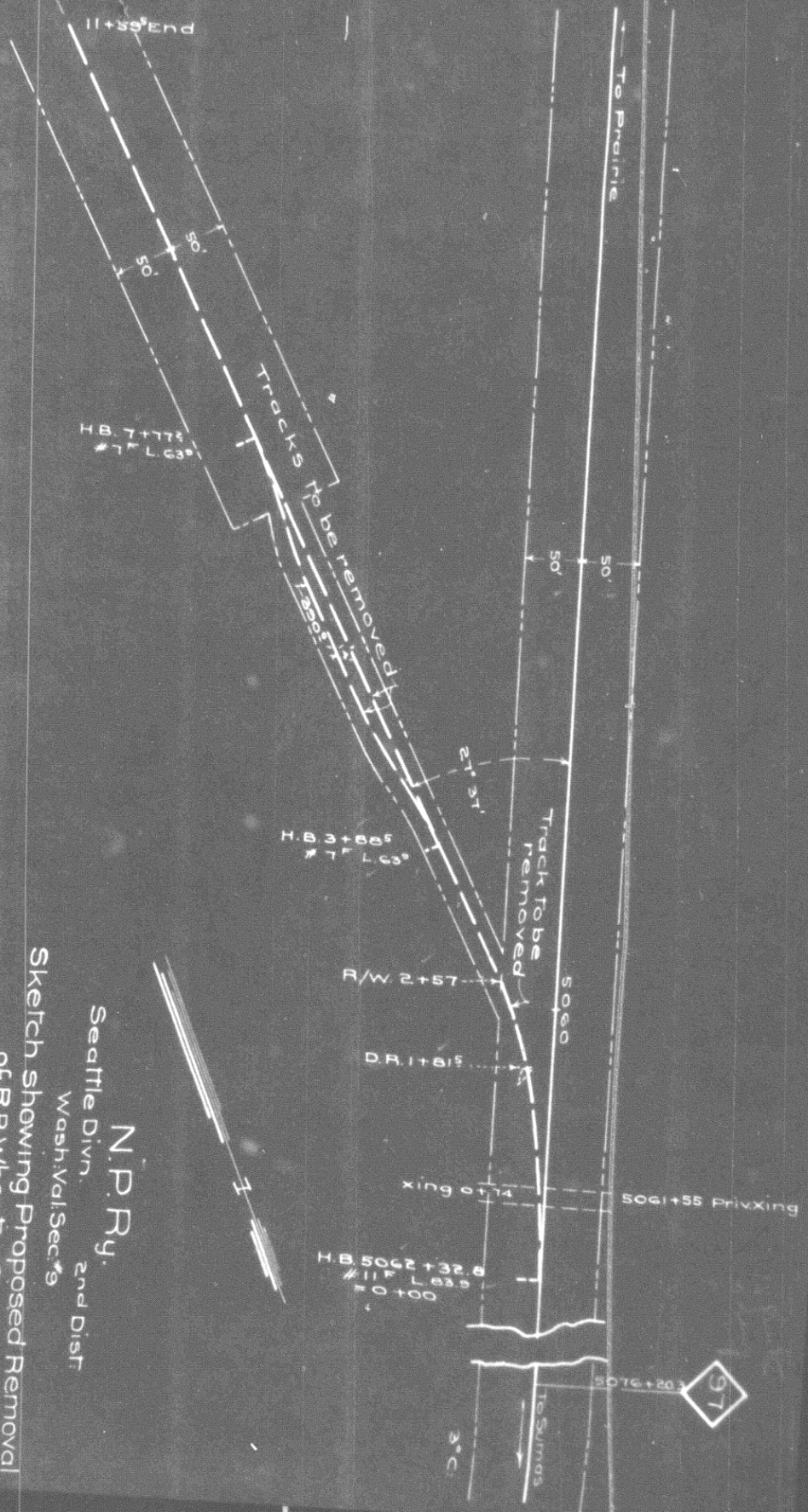

N.P. Ry.
 Seattle Divn. 2nd Dist.
 Wash. Val. Sec. 9
 Sketch showing Proposed Removal
 of R.R. Wheaton Spur
 near
PRAIRIE Wn.
 Office of Dist. Engr. Seattle, Wn.
 Scale 1:100
 Jan 28 1929