



N. P. 1363  
6-24

NORTHERN PACIFIC RAILWAY COMPANY  
AUTHORITY FOR EXPENDITURE 1929  
YEAR 1929

SUPERINTENDENT'S NO. 10

1929

DEPT. NO.

ENGINEERING DEPT. NO. 22-29

A. F. E. NO. 296

P A S C O Div. CONNELL NORTHERN BRANCH STATE WASH. VAL. SEC. NO. 12

AUTHORITY IS REQUESTED FOR A NET EXPENDITURE OF \$982.

Accounting distribution as follows: (Distribution to be made in General Office.)

|  | Operating Expenses | Profit and Loss | Net Operating Expenses | Net Profit and Loss |
|--|--------------------|-----------------|------------------------|---------------------|
| Cost of property retired.....                                    |                    |                 |                        |                     |
| Value of salvage .....   |                    |                 |                        |                     |
| Incidental costs .....   |                    |                 |                        |                     |
| Total to Operating Expenses .....                                |                    |                 |                        | \$                  |
| Total to Profit and Loss .....                                   |                    |                 |                        | \$                  |
| To Material and Supplies .....                                   |                    |                 |                        |                     |
| To Bills for Collection .....                                    |                    |                 |                        |                     |
| To Other Accounts .....  |                    |                 |                        |                     |
| Net charge to investment account—Additions and Betterments ..... |                    |                 |                        | 982 ✓               |
| Total of distribution .....                                      |                    |                 |                        | 982 ✓               |

Budget reference: 1516 157-1929

Class of Work: No. 1

Joint facility contract reference: Non Joint

The location is on this company's property. To secure rights, it will be necessary

Location: Wheeler (near), Washington

Title: Placing Riprap at MP 43.

and

Reason: There is a natural waterway near MP 43, which is dry most of the year, excepting at times of unusually heavy rainfall or during the Spring flood following a heavy snowfall, at which time the channel runs bank full causing dangerous wash against the roadbed. This item was included on Form 134 after inspection during the Fall of 1928. The condition of the roadbed at this time necessitates the placing of riprap before Spring floods, in order to avoid serious damage. It is recommended that this work be authorized in accordance with the attached sketch and estimate.

(Work authorized under authority of General Manager dated December 22nd, 1928.)

This impression is the duplicate of Form 134.

Work to be done by company force under charge of Superintendent

Accounting to concentrate in the office of Division Accountant

Checked and Entered  
President's Office

Date Feb. 4th 1929

|   |   |   |
|---|---|---|
| Signature and Title<br><i>L. M. ...</i><br>Superintendent       | Date Feb. 4th 1929  |   |
| APPROVED:<br><i>[Signature]</i><br>General Superintendent.      | <i>[Signature]</i><br>Asst. Chief Engr. or Engr. Maint. of Way. | <i>[Signature]</i><br>General Manager.    |
| <i>[Signature]</i><br>Mech. Supt., Supt. Telgh. or Signal Engr. |   |   |
| <i>[Signature]</i><br>Chief Engineer.                           |   | <i>[Signature]</i><br>Vice President.     |
| <i>[Signature]</i><br>For Comptroller.                          | <i>[Signature]</i><br>President                                 | Date of Final Approval { FEB 27 1929 } 19 |

COMPTROLLER'S RECORD OF NOTICE OF APPROVAL AND OF COMPLETION

Form No. 1345 issued 19 Work begun 19 Work finished March 21 1929



To Comell

50  
23  
950

43

948+50  
End Prop. Riprap

947+19  
End present  
Riprap

945

942+72  
End present and  
Prop. Riprap.

160  
150  
100  
130  
150  
200  
150

Letico.

940

Proposed Riprap  
Old riprap

Location Sketch.  
Scale: 1" = 100'

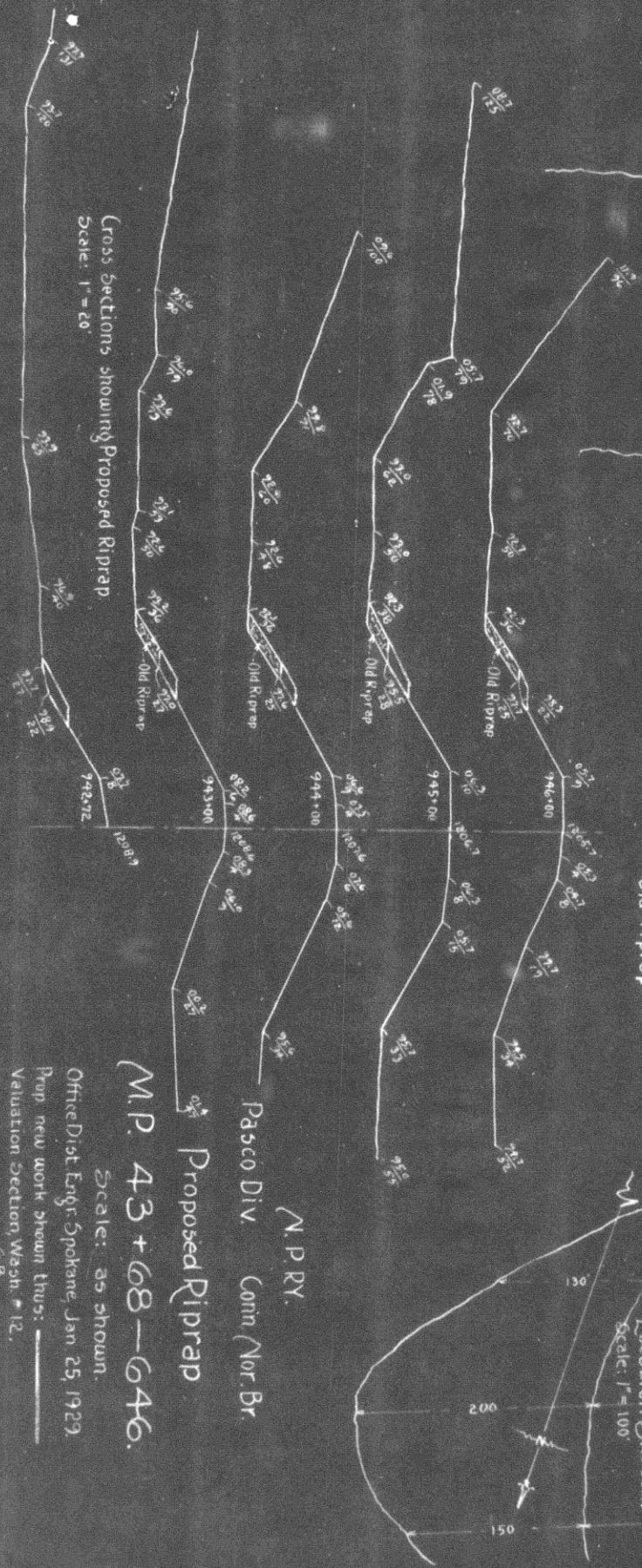

Cross Sections showing Proposed Riprap  
Scale: 1" = 60'

N.P.R.Y.

Pasco Div. Conn. Nor. Br.

Proposed Riprap

M.P. 43 + 68 - 646.

Scale: as shown.

Office Dist. Engr. Spokane, Jan 25, 1929.

Prop. new work shown thus: ———

Retention Section, Wash. + 12.  
G.B.