



N. P. 1363
6-24

NORTHERN PACIFIC RAILWAY COMPANY

AUTHORITY FOR EXPENDITURE

COMPTROLLER'S COPY

1929
1929
YEAR 1929

SUPERINTENDENT'S No. 56
No.

DEPT. No.

A. F. E. NO. 277

ENGINEERING DEPT. No. 45

Rocky Mtn Div. Third

DISTRICT BRANCH STATE Montana VAL. SEC. No. 19

AUTHORITY IS REQUESTED FOR A NET EXPENDITURE OF \$ 9595

Accounting distribution as follows: (Distribution to be made in General Office.)

	Operating Expenses	Profit and Loss	Net Operating Expenses	Net Profit and Loss
Cost of property retired	\$ 7235.			
Value of salvage	3576.		3659	
Incidental costs			1483	
Total to Operating Expenses				\$ 5142. ✓
Total to Profit and Loss				
To Material and Supplies			3576.	✓
To Bills for Collection				
To Other Accounts				
Net charge to investment account—Additions and Betterments				4453. ✓
Total of distribution				\$ 13171. ✓

Budget reference: Item 75 *Change Class of Work* *Made in 10-6 30* Class of Work: No. 3 ✓
Joint facility contract reference: Not Joint *Figure*

The location is on this company's property. To secure rights, it will be necessary

Location: Between Cyr & Westfall - Montana *Original Cost Adjustment*
Title: Between Cyr & Westfall - Curve Relays *Made in 1-29 1931*
Supplementary

Reason: After joint inspection by rail and track inspector, and division officers, and in accordance with system program, it is recommended that the badly worn 90# OH rail be replaced with 100# and 130# RE rail on Curves 164-B, 166, 173-A and 173-B, Third Sub-division.

Work to be done by company force under charge of Superintendent

Accounting to concentrate in the office of Superintendent

Signature and Title: *J. Johnson* Superintendent Date Jan. 15 19 29

<i>[Signature]</i> General Superintendent.	<i>[Signature]</i> Asst. Chief Eng. or Eng. Maint. of Way.	<i>[Signature]</i> General Manager.
<i>[Signature]</i> Mech. Supt., Supt. Telgh. or Signal Engr.	<i>[Signature]</i> Chief Engineer.	<i>[Signature]</i> Vice President.
<i>[Signature]</i> For Comptroller.	<i>[Signature]</i> President.	Date of Final Approval: FEB 25 1929

COMPTROLLER'S RECORD OF NOTICE OF APPROVAL AND OF COMPLETION

Firm No. 1346 issued 19. Work begun 19. Work finished June 22 19 29

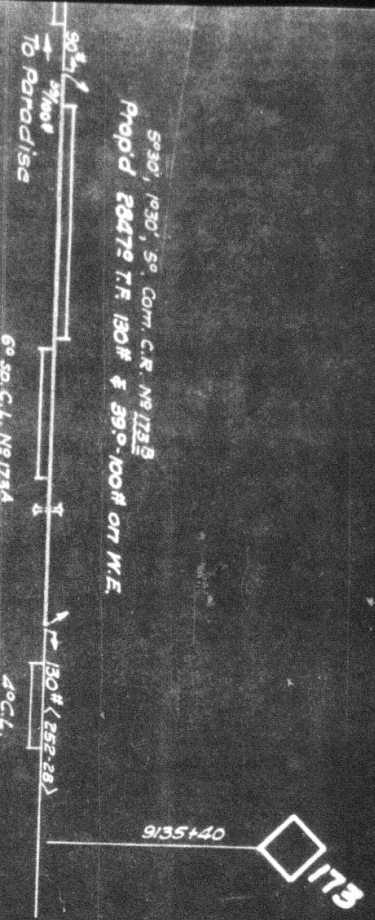

9165+74 M.P. 173+3034 12' C.A.

MAT'L FOR RELAY

Lin. Ft.	130# rail	
Prs.	130-100# corner joints	8258
"	100-90# "	350
"	130# angle bars	10
Pcs.	130# bolts with nut locks	208
"	100# "	852
"	90# "	40
"	130# tie plates	20
"	100# "	4760
"	130# rail anchors	225
"	100# "	1902
"	90# "	90
Lbs.	spikes	6234

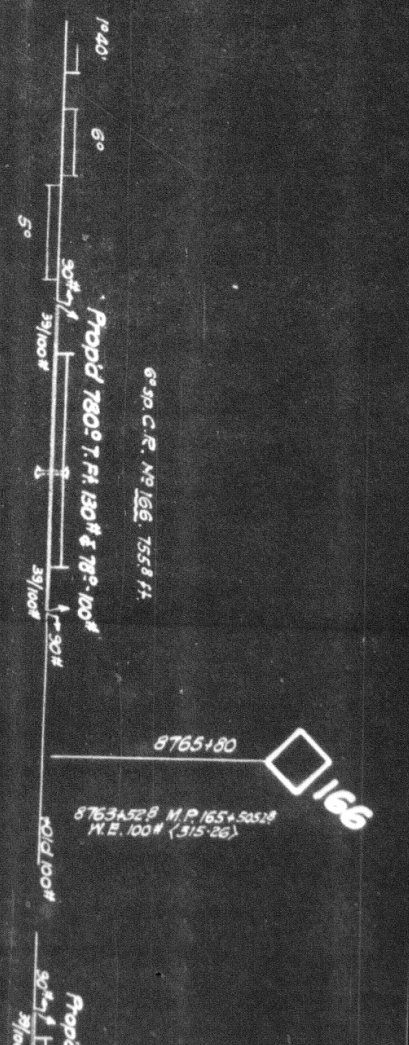

8776+85 M.P. 166+1105 12' C.A.

R.M. DIV. DWG
 Prop'd M.L. CURRY TO
 R.E. ROLL ON
 164 B
 Office Dist. Engineer
 Prop'd New Mt
 Val. Section
 191

9155 + 193, M.P. 173 + 4979.3 WE Relay	390 100° 2' Cl R.E. OH III	84 + 30.0 E.S.
Curve No 173 A	2854 6' 130° 1st Cl 1st Qd R.E. OH III	5° 30' C.
	147 Pk. 130° Angle bars HT	1° 30' C.
	2 Pr. 130/100 Q & C. Comp. Joints	5° 00' C.
	1 Pr. 100/90 Q & C. Comp. Joints	73 + 37.3 P.S.
	1 Pr. 100/90 Du Well Comp. Joints	73 + 00.2 E.S.
	2 Pr. 130° Insulated Joints R.J.Co.	6° 00' C.
	3310 Pk. 130° 8x12 6 hole tie plates	67 + 59.3 P.S.
	44 Pk. 100° 7 1/2 x 10 1/8 tie plates	
	1153 Pk. 130° Rail anchors Fair	
	16 Pk. 100° Rail anchors Erickson	
	592 Pk. 130° bolts with H.P. nut locks	
	8 Pk. 100° bolts with H.P. nut locks	
	4 Rk. 90° bolts with H.P. nut locks	
	2854 6' 90° 1st Cl 1st Qd R.E. OH III	
	390 100° R.E. OH III Removed	
	8938 Pk. spikes under 130° Rail	
	4 Spikes per tie under 100° Rail	

9156 + 25.7 M.P. 173 + 2085.7 E.E. Relay (Joins 130° rail imp 252-28)

8791 + 09.0, M.P. 166 + 1529 WE Relay	7800 130° 1st Cl 2nd Qd R.E. OH III	80 + 48.2 E.S.
Curve No 166	306 Pk. 130° Angle bars HT	6° 00' C.
	4 Pr. 130/100 Q & C. Comp. Joints	
	4 Pr. 100/90 Q & C. Comp. Joints	
	2 Pr. 130° Insulated Joints R.J.Co.	
	919 Pk. 130° 8x12 6 hole tie plates	
	67 Pk. 100° 7 1/2 x 10 1/8 tie plates	
	303 Pk. 130° Rail anchors Fair	
	26 Pk. 100° Rail anchors Erickson	
	152 Pk. 130° bolts with H.P. nut locks	
	16 Pk. 100° bolts with H.P. nut locks	
	8 Pk. 90° bolts with H.P. nut locks	
	8385 90° 1st Cl 1st Qd R.E. OH III	
	6 Spikes per tie under 130° rail	
	4 Spikes per tie under 100° rail	

8772 + 70.5, M.P. 166 + 690.5 E.E. Relay

8682 + 57.5, M.P. 164 + 2237.5 WE Relay	5267 130° 1st Cl 2nd Qd R.E. OH III	82 + 30.7 E.S.
Curve No 164 B	28 Pr. 130° Angle bars HT	6° 40' C.
	4 Pr. 130/100 Q & C. Comp. Joints	
	4 Pr. 100/90 Q & C. Comp. Joints	
	611 Pk. 130° 8x12 6 hole tie plates	
	70 Pk. 100° 7 1/2 x 10 1/8 tie plates	
	230 Pk. 130° Rail Anchors Fair	
	23 Pk. 100° Rail anchors Erickson	
	108 Pk. 130° bolts with H.P. nut locks	
	16 Pk. 100° bolts with H.P. nut locks	
	8 Pk. 90° bolts with H.P. nut locks	
	5877 90° 1st Cl 1st Qd R.E. OH III	
	6 Spikes per tie under 130° rail	
	4 Spikes per tie under 100° rail	

RAIL 100° R.E. OH III	Total	158.5
RAIL 130° R.E. OH III	Total	4161.3
ANGLE BARS 130° T-6-9	Total	208 Pr
COMP Jts. 130/100 Q & C.	Total	10 Pr
COMP Jts. 100/90 Q & C.	Total	9 Pr
COMP Jts. 100/90 Du Well	Total	1 Pr
INSULATED Jts. R.J.Co.	Total	2 Pr
RAIL PLATES 130° T-4-15	Total	4840
RAIL PLATES 100° T-4-12A	Total	181
RAIL ANCHORS Fair 130°	Total	1696
RAIL ANCHORS Erickson	Total	65
Bolts 130° T-8-5	Total	852
Bolts 100° T-8-4	Total	40
Bolts 90° T-8-3	Total	20
RAIL RELEASED 90° 1st Cl 1st Qd	Total	4280.8
RAIL RELEASED 100° 1st Cl 1st Qd	Total	390
Spikes % 6" T-10-1	Total	13,802

CYR AND WESTFALL RELAY CURVES

No Scale

Track relaid shown

Office of Asst. Engr. Missoula Mont. Oct 9, 1929.

Valuation section

Authorized under imp. No 277-29 dated 2-25-29

Work begun June 1929

Work completed June 22-1929

Mont. No 19

June 1929

June 22-1929

R.M.DIV

BETWEEN

3rd DIST

N.P.RY

173

166

164

to Missoula