



N. P. 1363  
6-24

# NORTHERN PACIFIC RAILWAY COMPANY AUTHORITY FOR EXPENDITURE

COMPTROLLER'S OFFICE

SUPERINTENDENT'S NO. **41**  
NO.

DEPT. NO.

ENGINEERING DEPT. NO. **42**

A. F. E. NO.

**272**

**Montana**

Div.

**First**

~~Rocky~~

DISTRICT STATE

**Montana**

VAL. SEC. NO.

**2**

AUTHORITY IS REQUESTED FOR A NET EXPENDITURE OF \$ **102323.00**

Accounting distribution as follows: (Distribution to be made in General Office.)

	Operating Expenses	Profit and Loss	Net Operating Expenses	Net Profit and Loss
Cost of property retired	\$	\$	\$	\$
Value of salvage				
Incidental costs				
Total to Operating Expenses				\$ 54905 ✓
Total to Profit and Loss				
To Material and Supplies				
To Bills for Collection				
To Other Accounts				
Net charge to investment account—Additions and Betterments				47418 ✓
Total of distribution				\$ 102323 ✓

Budget reference **Item 42**

Class of Work: No. **2** ✓

Joint facility contract reference: **Not Joint.**

The location is \_\_\_\_\_ on this company's property. To secure rights, it will be necessary

Location: **Between Misko and Oneida, Montana.**

Title: **Washed Ballast MP 34 to MP 53.**

and

Reason:

This track has been ballasted at various times with pit run ballast. Ballast is worn out and track is churning badly, causing rough riding track and the cost of maintaining is excessive. In order to place track in good condition, it is recommended that 52000 cu. yds. of washed ballast be furnished for this territory as per attached estimate.

Work to be done by ~~company~~ force under charge of **Superintendent.**

Accounting to concentrate in the office of **Superintendent.**

Signature and Title

*[Signature]*  
**Superintendent.**

Date **Jan. 9th '29**

APPROVED

<i>[Signature]</i> Superintendent	<i>[Signature]</i> Asst. Chief Eng. or Engr. in Charge of Work	<i>[Signature]</i> General Manager
--------------------------------------	---	---------------------------------------

Signal Engr.

Engineer

Vice President

*[Signature]*  
President

Date of Final Approval \_\_\_\_\_ 19\_\_

RECORD OF NOTICE OF APPROVAL AND OF COMPLETION

Work begun \_\_\_\_\_

Work finished \_\_\_\_\_

**24 30 '29**

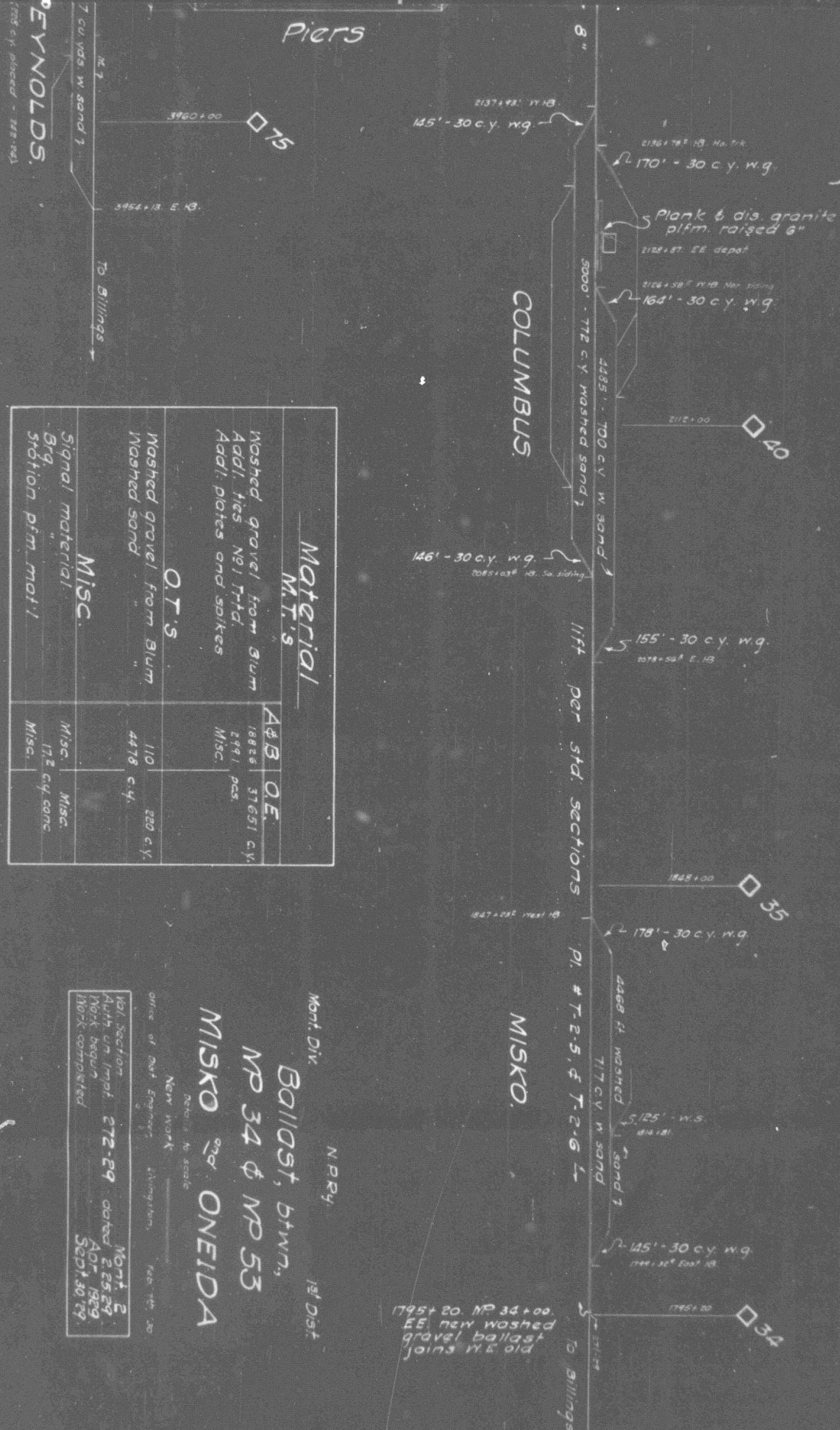

Material		A&B	O.E.
Washed gravel from Blum		18825	37651 c.y.
Add: ties No. 1 Trfd.		2991	pcs.
Add: plates and spikes		Misc.	
O.T.'s			
Washed gravel from Blum		110	280 c.y.
Washed sand		4478	c.y.
MISC.			
Signal material		Misc.	Misc.
Brq		Misc.	172 c.y. cone
Station plm. mat'l		Misc.	

Mont. Div. N.P.R.Y. 1st Dist.  
 Ballast, btw'n,  
 NP 34 & NP 53  
 MISKO ONEIDA  
 Details to scale  
 New Work  
 Office of Dist. Engineer, Livingston, Feb. 14, '30  
 1st Section  
 Auth. on Imp. 272-29 dated 2.25.29  
 Work begun A.O. 1929  
 Work completed SGP, 30.12.29.

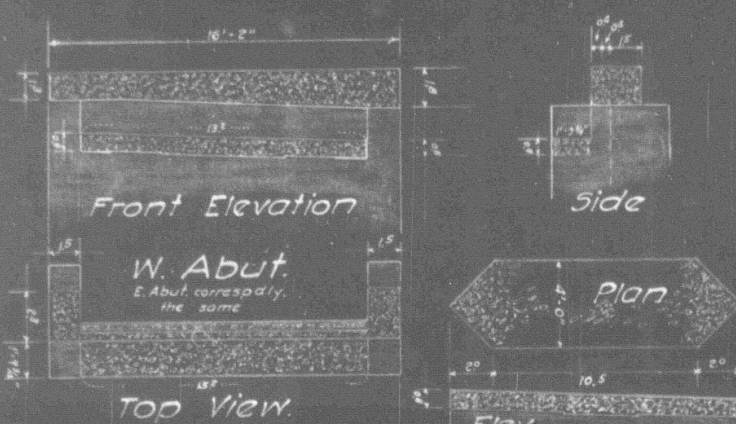

**BRIDGE 52.**

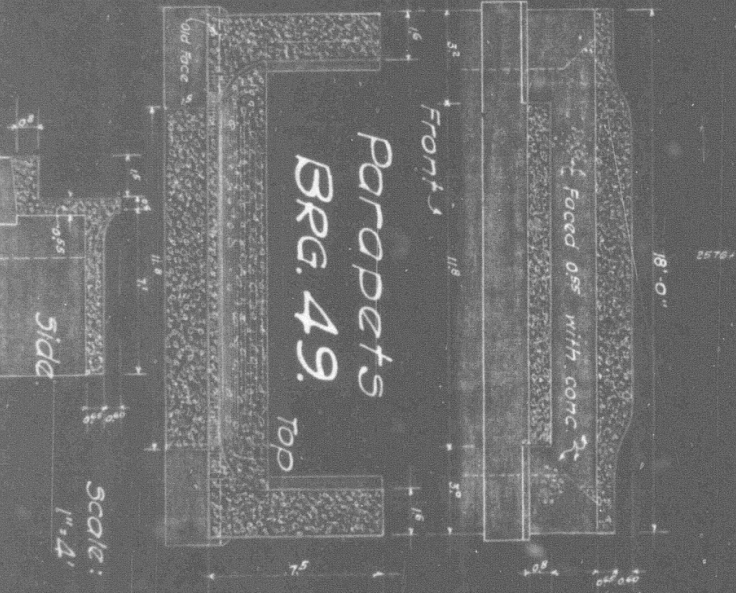
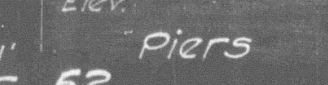

**BRIDGE 48.**

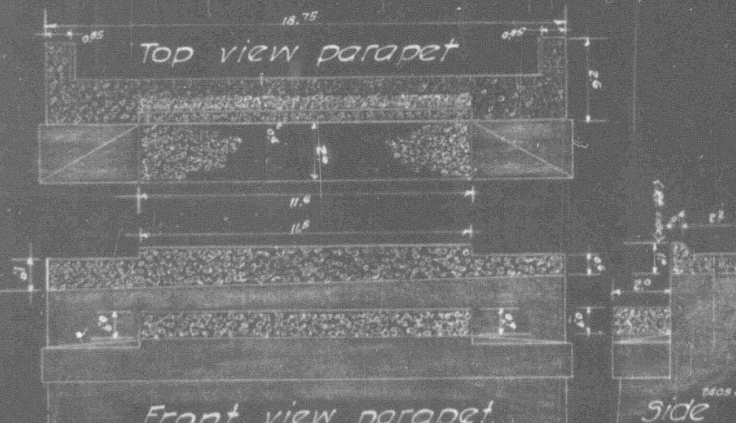

**BRIDGE 48.**

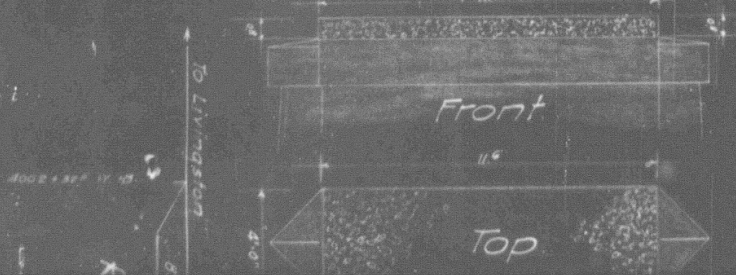

#52

#49

#48

CRAVER

WATAGA

