



N. P. 1963  
6-24

# NORTHERN PACIFIC RAILWAY COMPANY AUTHORITY FOR EXPENDITURE

1929  
YEAR

SUPERINTENDENT'S NO. 5

DEPT. NO.

ENGINEERING DEPT. NO. 26-29

A. F. E. NO. 250

Seattle Div. Seattle Terminal DISTRICT STATE Wash VAL. SEC. No. 8-C

AUTHORITY IS REQUESTED FOR A NET EXPENDITURE OF \$ 352

Accounting distribution as follows: (Distribution to be made in General Office.)

	Operating Expenses	Profit and Loss	Net Operating Expenses	Net Profit and Loss
Cost of property retired	\$ 165	\$ 251		
Value of salvage	63	60		
Incidental costs			102	191
			98	38

Total to Operating Expenses 200 ✓

Total to Profit and Loss P & L Loss on Retired R & E 229 ✓

To Material and Supplies 123 ✓

To Bills for Collection 477 ✓

To Other Accounts

Net charge to investment account—Additions and Betterments 77 ✓

Total of distribution 952 ✓

Budget reference: NOT IN BUDGET.

Added to First Valuation

Month JAN 1930

50%  
1930  
Committee

Class of Work: No. 10 ✓

Joint facility contract reference: CWR&N Co. 6-27-11 and 6-20-11, CWR&N & CM&STP&P&GN 6-20-11, 7-21-14 and 12-1-09

The location is on this company's property. To secure rights, it will be necessary

Location: Seattle, Washington.

Title: Remove Mullins Sawmill Spur.

and Track decrease 49 ft.

Reasons: Under AFE 2705-19 a spur track serving the Seattle Mill & Mfg. Co., was relocated to serve the Mullens Sawmill Co., on the joint Klickitat Ave., track. The Railways stood cost of spur up to franchise line and balance of spur was placed at the expense of the Mill Company. The Mill Company has ceased operations and the spur has not been used since 1921. In order to salvage material and remove a turnout, as there appeared to be no further use for the spur the turnout was removed during July 1928. As rail in Klickitat Ave., on either side of this spur was 90# when turnout was removed the 56# rail in Klickitat Ave., for a distance of 385 feet was relaid with 90# rail. This RFE is submitted for record purposes to cover work completed in July 1928. Track decrease 98 ft.

COMPLETED

Work to be done by company, force under charge of Divn. Superintendent at Seattle, Wn.

Accounting to concentrate in the office of Divn. Accountant at Seattle, Wn. Checked and Entered President's Office

Signature and Title: J.R. Bailes

Supt. Date Jan. 7 1929

APPROVED: J.R. Bailes General Superintendent.	J. F. Buchanan Asst. Chief Engr. or Engr. Maint. & Wry.	[Signature] General Manager.
[Signature] Mech. Supt., Supt. Teleg. or Signal Engr.	[Signature] Chief Engineer.	[Signature] Vice President.
[Signature] For Comptroller.	[Signature] President.	Date of Final Approval: Feb 20 1929

COMPTROLLER'S RECORD OF NOTICE OF APPROVAL AND OF COMPLETION

1929 issued \_\_\_\_\_ 19 \_\_\_\_\_ Work begun \_\_\_\_\_ 19 \_\_\_\_\_ Work finished July 31 1929



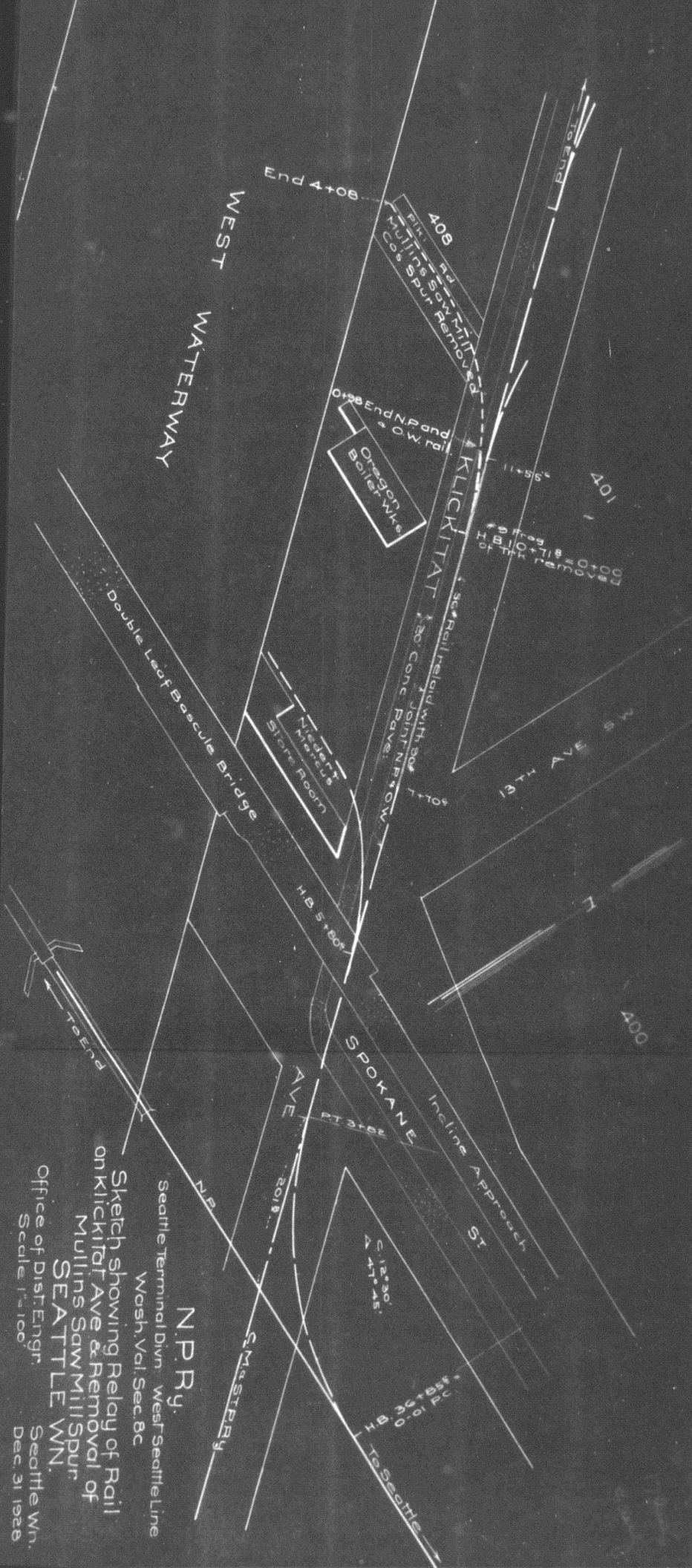

Sketch showing Relay of Rail  
 on Klickitat Ave & Removal of  
 Mullins Sawmill Spur  
**SEATTLE** WN.  
 Office of Dist. Engr.  
 Seattle Wn.  
 Dec. 31 1928

**N.P.R.Y.**  
 Seattle Terminal Div. West Seattle Line  
 Wash. Vol. Sec. 8c