



N. P. 1363  
6-24

NORTHERN PACIFIC RAILWAY COMPANY

AUTHORITY FOR EXPENDITURE

1929

1929

1929 1929  
YEAR 1929

SUPERINTENDENT'S No. 206  
No.

DEPT. No.

ENGINEERING DEPT. No. 18-29

A. F. E. NO. 225

Tacoma Div. Buckley Line

DISTRICT STATE Wash VAL. SEC. No. 10

AUTHORITY IS REQUESTED FOR A NET EXPENDITURE OF 288

Accounting distribution as follows: (Distribution to be made in General Office.)

	Operating Expenses	Profit and Loss	Net Operating Expenses	Net Profit and Loss
Cost of property retired	\$	715	\$	\$
Value of salvage		448	267	
Incidental costs			160	
Total to Operating Expenses				427
Total to Profit and Loss	619			427 ✓
To Material and Supplies				448 ✓
To Bills for Collection				
To Other Accounts				
Net charge to investment account—Additions and Betterment				715 ✓
Total of distribution				160 ✓

Original Cost Adjustment  
Made in J. H. H. 1929  
Final

Budget reference: NOT IN BUDGET

Class of Work: No. 10 ✓

Joint facility contract reference: Non Joint

The location is on this company's property. To secure rights, it will be necessary

Location: Birch (Enumclaw)

Title: Removal of Sundown Lumber Company spur  
and Track decrease 704 ft.

Reason: AFE 722-13 authorized construction of a track for the Sundown Lumber Company at Mile Post 7 plus 2485 feet, Birch, and as the Timber Company finished operations at that point some time ago, and there are no prospects whatever for the use of this track by any other industry, it is recommended that the track be removed and the material salvaged. This track was originally constructed on the basis of Railway Company furnishing metal only, all other expense to be borne by applicant.

Engineer's blue print and estimate attached.



Work to be done by company force under charge of Superintendent

Accounting to concentrate in the office of Division Accountant

Signature and Title: [Signature] Date Nov 30 19 28

APPROVED: [Signature] General Superintendent	[Signature] Superintendent	[Signature] General Manager
[Signature] Mech. Supt., Supt. Telph. or Signal Engr.	[Signature] Asst. Chief Engr. or Engr. Maint. of Way	[Signature] General Manager
[Signature] Chief Engineer	[Signature] Gen'l Traffic Manager	[Signature] Vice President
[Signature] For Comptroller	[Signature] President	Date of Final Approval { FEB 5 1929 }

COMPTROLLER'S RECORD OF NOTICE OF APPROVAL AND OF COMPLETION

Form No. 1345 issued 19 Work begun 19 Work finished March 15 1929

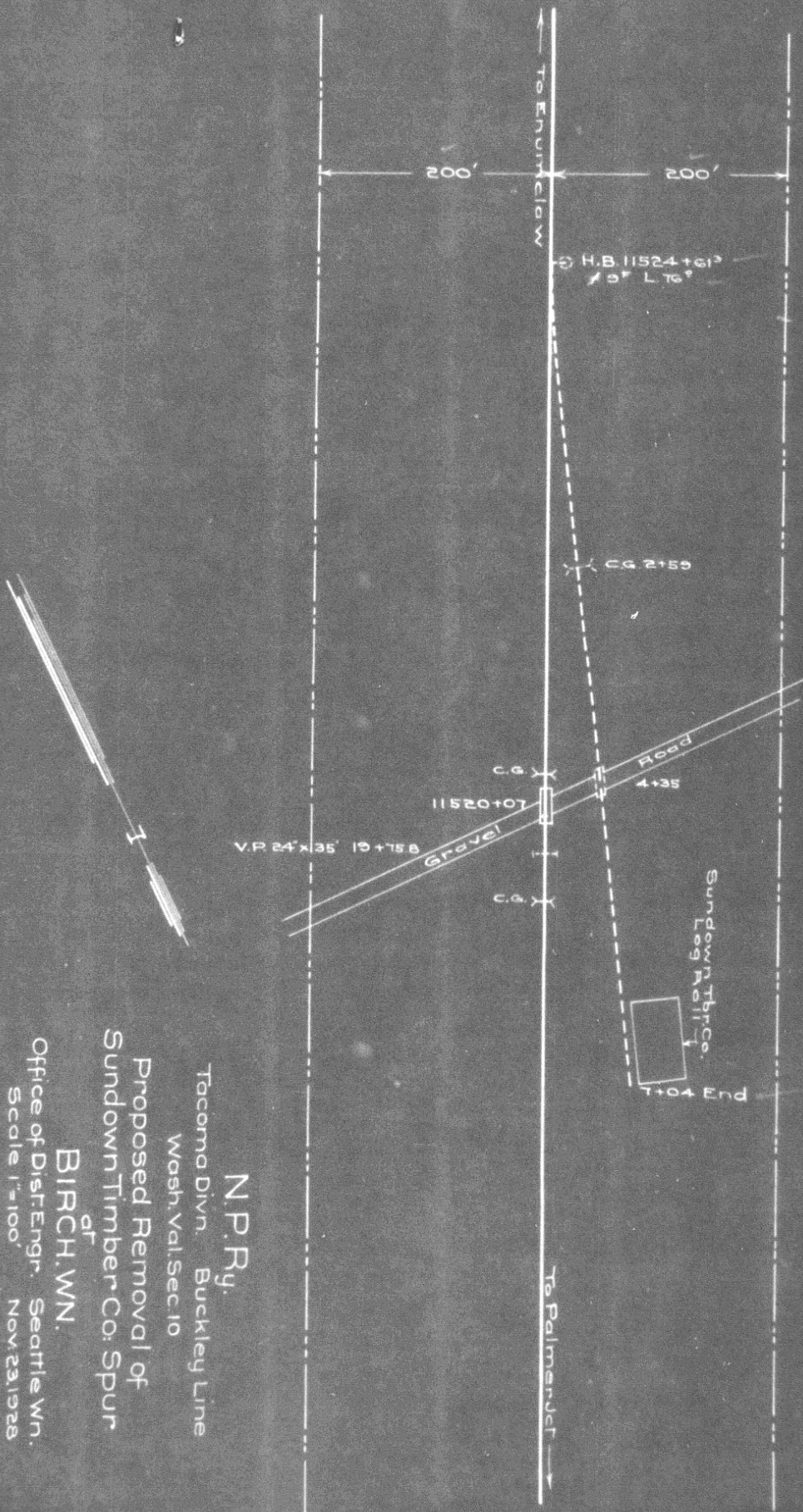

N.P. Ry.  
 Tacoma Divn. Buckley Line  
 Wash. Val. Sec. 10  
 Proposed Removal of  
 Sundown Timber Co. Spur  
 at  
 BIRCH, W.N.  
 Office of Dist. Engr. Seattle Wn.  
 Scale 1"=100' Nov. 23, 1928