



N. P. 1363
6-24

NORTHERN PACIFIC RAILWAY COMPANY AUTHORITY FOR EXPENDITURE

1929 YEAR 1929
A. F. E. NO. 222

DEPT. No. ENGINEERING DEPT. No. 17-29

VAL. SEC. No. 5

SUPERINTENDENT'S No. 5
No.

DISTRICT STATE
Brownish Mont.
557

Idaho Div.

First

AUTHORITY IS REQUESTED FOR A NET EXPENDITURE OF \$

Accounting distribution as follows: (Distribution to be made in General Office.)	Operating Expenses	Profit and Loss	Net Operating Expenses	Net Profit and Loss
Cost of property retired	200	600	200	600
Value of salvage			251	
Incidental costs				
Total to Operating Expenses				451 ✓
Total to Profit and Loss				600 ✓
To Material and Supplies				
To Bills for Collection				
To Other Accounts				
Net charge to investment account—Additions and Betterments				494 ✓
Total of distribution				557 ✓

Original Cost Adjustment
Made in 8/10/1929

Budget reference: NOT IN BUDGET.

Joint facility contract reference: Non Joint.

The location is on this company's property. To secure rights, it will be necessary

Location:
Title:
and
Reason:

Trout Creek, Montana
Replacing two box car bodies.

On December 5, 1928, the signal maintainer's living quarters, consisting of 4 box car bodies, were burned. It is planned to move one box car body from Paradise and one from Eddy to replace those burned. Car body to be moved from Paradise was placed there without formal authority and should therefore be charged to capital accounts.



Work to be done by company force under charge of Superintendent.
contract Division Accountant.

Accounting to concentrate in the office of Supt.

Signature and Title: *[Signature]* Supt.

APPROVED: *[Signature]* General Superintendent.

[Signature] Mech. Supt., Supt. Tel. or Signal Engr.

[Signature] Chief Engineer.

[Signature] For Comptroller.

[Signature] Asst. Chief Engr. or Engr. Maint. of Woz.

[Signature] President.

[Signature] General Manager.

[Signature] Vice President.

Date 1-7-29

COMPTROLLER'S RECORD OF NOTICE OF APPROVAL AND OF COMPLETION

19 Work begun

Work finished

Jan. 17, 1929

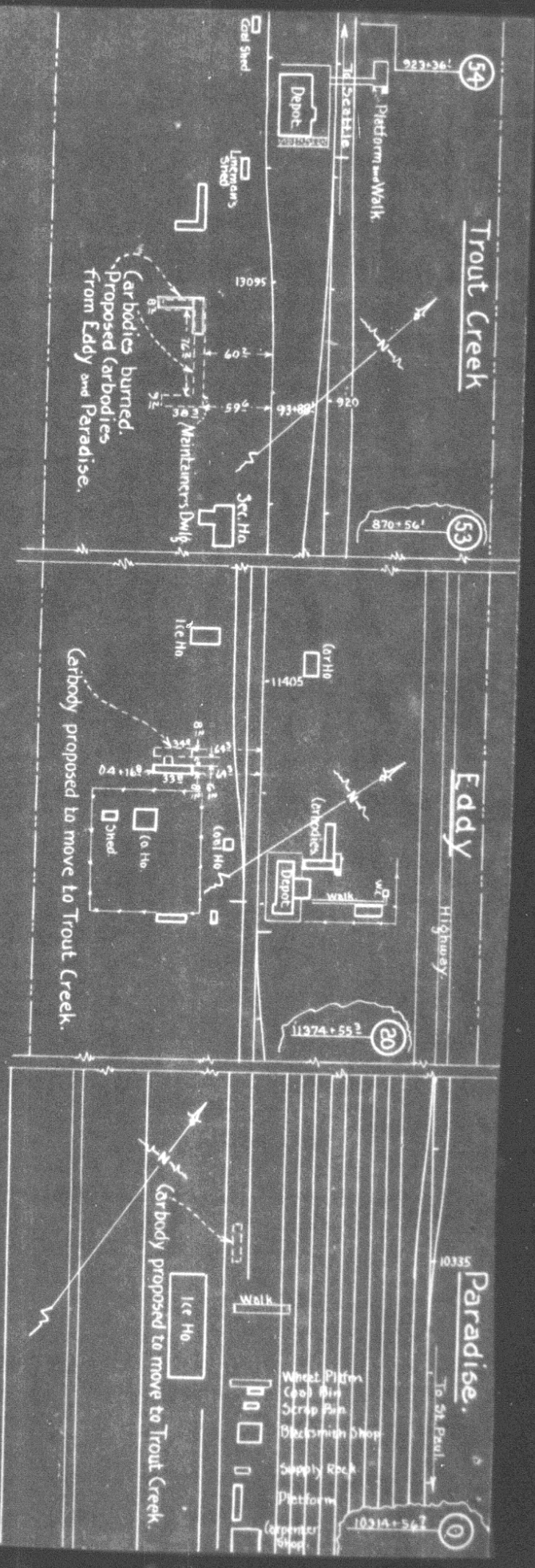

N. P. RY.
 Idaho Div. Main Line.
 Proposed to Replace Carbodies Destroyed by Fire
 at Trout Creek, Montana.

Scale: 100' = 1"
 Office Dist. Engr. Spokane, Dec. 21, 1928.
 Prop. new work shown thus: _____
 Carbodies destroyed " _____
 Valuation Section, Mont. # 5.
 G.J.