



N. P. 1363
6-24

NORTHERN PACIFIC RAILWAY COMPANY AUTHORITY FOR EXPENDITURE

1929 YEAR 1929

SUPERINTENDENT'S NO. 6

DEPT. NO.

A. F. E. NO. 212

No. 1

ENGINEERING DEPT. NO. 23-29

Seattle

DIV. Lake Wash. Belt Line ~~Branch~~ BRANCH

STATE Wash

VAL. SEC. NO. 8-A

AUTHORITY IS REQUESTED FOR A NET EXPENDITURE OF \$ 679

Accounting distribution as follows: (Distribution to be made in General Office.)

	Operating Expenses	Profit and Loss	Net Operating Expenses	Net Profit and Loss
Cost of property retired.....	\$	\$	\$	\$
Value of salvage				
Incidental costs				\$
Total to Operating Expenses				
Total to Profit and Loss				
To Material and Supplies				
To Bills for Collection				
To Other Accounts				
Net charge to investment account—Additions and Betterments				\$ 679 ✓
Total of distribution				\$ 679 ✓

Class of Work: No. 1 ✓

Budget reference: NOT IN BUDGET.

Joint facility contract reference: Non Joint.

The location is on this company's property. To secure rights, it will be necessary

Location: Woodinville, Washington (near)

Title: Drain pipe placed through property of T.B.Klock

and

Reason:

Under the terms of an agreement dated May 4th, 1928 between the Northern Pacific Ry. Co., and T.B.Klock and wife, the Railway Company agreed to place 222 ft. of 24" pipe connecting with culvert at Station 61 plus 41 to carry drainage water across the Klock property. The placing of this pipe was completed on October 15th, 1928 in accordance with the agreement and this RFA is prepared for record purposes to cover work already done.

COMPLETED

Work to be done by contract force under charge of Divn. Superintendent at Seattle, Wn.

Accounting to concentrate in the office of Divn. Accountant at Seattle, Wn.

Signature and Title:

APPROVED:

General Superintendent

Asst. Chief Engr. or Engr. Maint. of Way

Mech. Supt., Supt. Telg. or Signal Engr.

Chief Engineer

For Comptroller

Checked and Entered
Final Office

Supt. Date Jan. 4, 1929 19

General Manager

Vice President

Date of Final Approval

FEB 1 1929

COMPTROLLER'S RECORD OF NOTICE OF APPROVAL AND OF COMPLETION

Work begun

Work finished

Oct. 31 1928



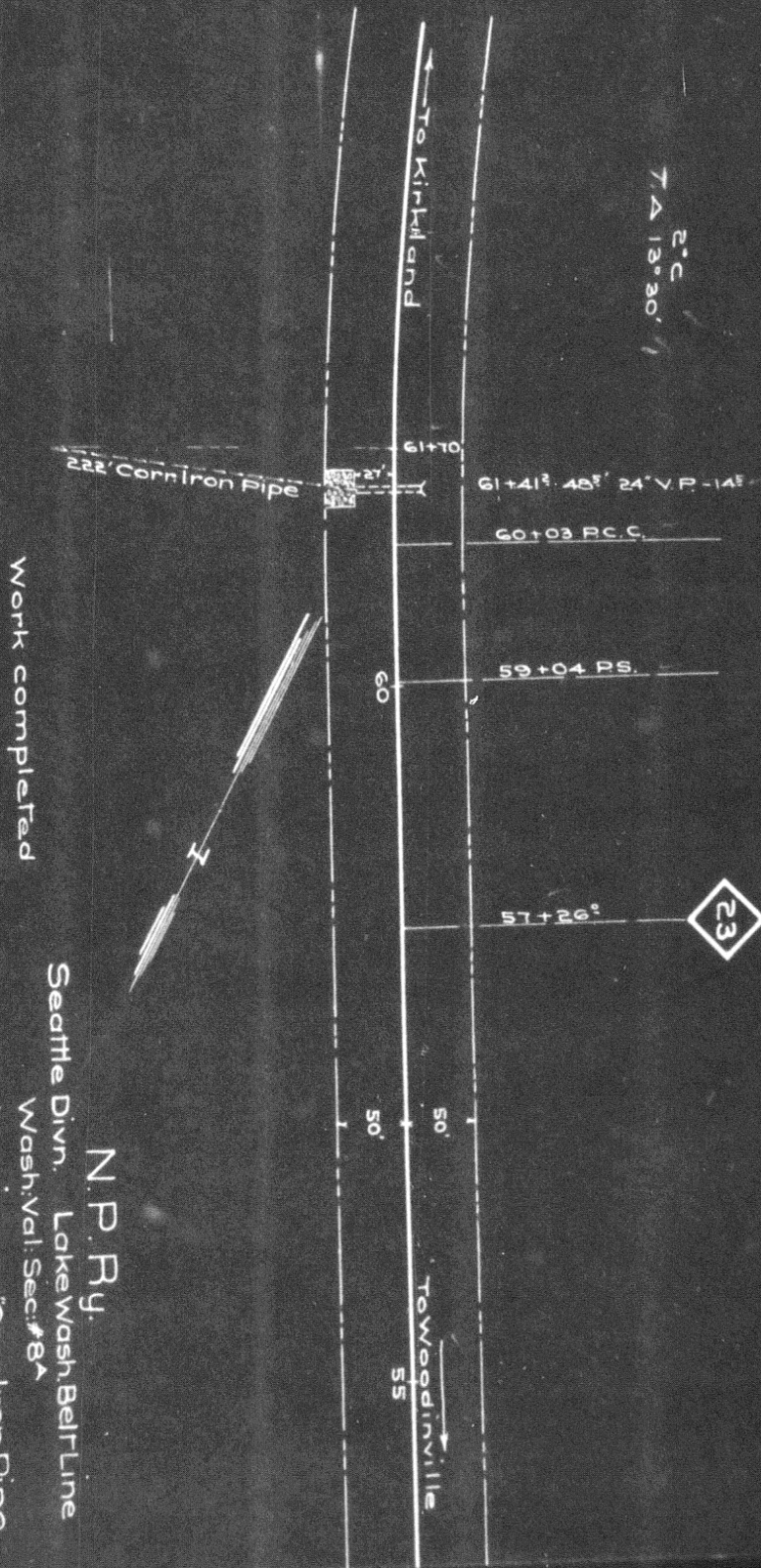

N.P.Ry.
 Seattle Divn. Lake Wash. Belt Line
 Wash. Val. Sec. #84
 Sketch showing 24" Corn Iron Pipe
 placed for drainage thru property
 of T.B. Klock
 near
 WOODINVILLE WN
 Office of Dist. Engr. Seattle WN
 Scale 1"=100'
 Dec. 31 1928