



N. P. 1363
6-24

NORTHERN PACIFIC RAILWAY COMPANY
AUTHORITY FOR EXPENDITURE

CONTROLLER'S COPY

1929/1929
YEAR 1929

SUPERINTENDENT'S No. 5

1929

DEPT. No.

ENGINEERING DEPT. No. 20

A. F. E. No. 207

Montana Div. First

DISTRICT STATE Montana VAL. Sec. No. 2

AUTHORITY IS REQUESTED FOR A NET EXPENDITURE OF \$ 115.00

Accounting distribution as follows: (Distribution to be made in General Office.)

	Operating Expenses	Profit and Loss	Net Operating Expenses	Net Profit and Loss
Cost of property retired	80			
Value of salvage			80	
Incidental costs			5	
Total to Operating Expenses				85 ✓
Total to Profit and Loss				
To Material and Supplies				
To Bills for Collection				
To Other Accounts				
Net charge to investment account—Additions and Betterments				30 ✓
Total of distribution				115 ✓

Original Cost Adjustment
Made in March 1929
Edna

Budget reference: Not in Budget

Class of Work: No. 8 ✓

PART OF GENERAL PLAN

Joint facility contract reference: Not Joint.

The location is --- on this company's property. To secure rights, it will be necessary

Location: Big Timber, Montana (Near)

Title: Replace Two Plank Private Crossings with Texaco Cold Patch.

Reason:

In accordance with Mr. Blum's letter of April 27, 1927 two Texaco Cold Patch farm crossings were installed on the Main Line, First District - one crossing being located at Milepost 78 plus 2800 and put in August 11, 1928 - the other crossing being located at Milepost 83 and constructed on August 6th, 1928. On account of cost of installation of these crossings exceeding \$100 this AFE is submitted in order that cost can be entered into Capital Account.

It is therefore recommended that work be approved as per attached blue print and estimate.

Work completed.

COMPLETED.

Work to be done by company force under charge of Superintendent.

Accounting to concentrate in the office of Superintendent.

Checked and Entered
President's Office



Signature and Title: Edna Superintendent.

Superintendent.

Date Dec. 11 1928

APPROVED:

Henry
General Superintendent.

John
Asst. Chief Engr. or Engr. in Charge of Way.

Harvey
General Manager.

Mech. Supt., Supt. Telgr. or Signal Engr.

Blum
Chief Engineer.

Blum
Vice President.

Blum
For Comptroller.

Charles
President.

Date of Final Approval FEB 4 1929

COMPTROLLER'S RECORD OF NOTICE OF APPROVAL AND OF COMPLETION

Form No. 1346 issued

19

Work begun

19

Work finished

Aug. 11 1928

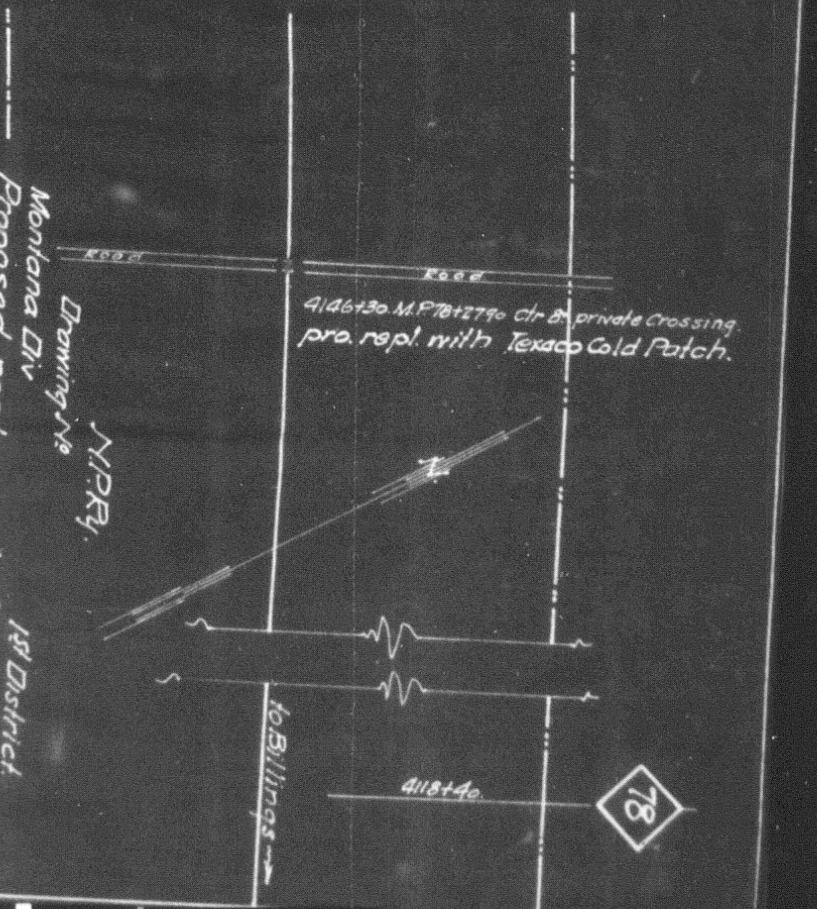
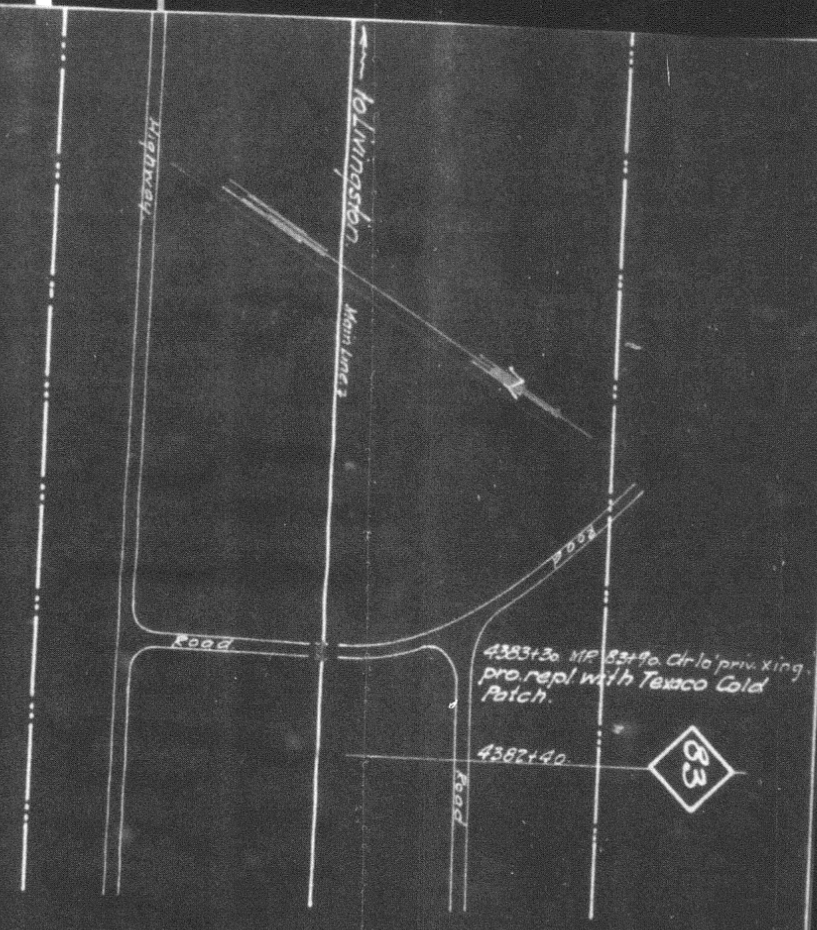

Montana Div
 Drawing No
 N.P.R.
 1st District
 Proposed replacement of 2 plant private
 Crossings with Texaco Cold Patch.
 near
Big Timber.
 Scale: 1" = 100 ft.
 Office of Dist. Engr. Livingston, Mont Nov. 23rd 1928.
 Proposed New mark shown
 Valuation Section Mont #2.
 Mark Completed.