

N. P. 1363
6-24

NORTHERN PACIFIC RAILWAY COMPANY AUTHORITY FOR EXPENDITURE

COMPTROLLER'S COPY
1929
YEAR 1929

SUPERINTENDENT'S No. 40

DEPT. No.
ENGINEERING DEPT. No. 28-29

A. F. E. NO. 197

Rocky Mtn Div. Third

DISTRICT STATE Montana VAL Sec. No. 19

AUTHORITY IS REQUESTED FOR A NET EXPENDITURE OF \$ 9611

Accounting distribution as follows: (Distribution to be made in General Office.)

Cost of property retired	Operating Expenses	Profit and Loss	Net Operating Expenses	Net Profit and Loss
	1700		1700	
Value of salvage				
Incidental costs				
Total to Operating Expenses			1665	
Total to Profit and Loss				
To Material and Supplies				1866 ✓
To Bills for Collection				
To Other Accounts				
Net charge to investment account—Additions and Betterments				
Total of distribution				7746 ✓

Budget reference: Item 25
Joint facility contract reference: Not Joint Account

Class of Work: No. 1 ✓

The location is _____ on this company's property. To secure rights, it will be necessary

Location: 3 Miles West of Westfall - Montana
Title: Concrete Retaining Wall

Reason: The 1928 fall bridge inspection disclosed the necessity for concrete block retaining wall replacing timber crib at above location, as per estimate and blue print attached.

Work to be done by company force under charge of Superintendent

Accounting to concentrate in the office of Superintendent

Checked and Estimated
President's Office



Signature and Title: *J. H. ...* Superintendent

APPROVED:

<i>W. ...</i> General Superintendent	<i>J. ...</i> Asst. Chief Engr. - in Charge - Material Work	<i>H. ...</i> General Manager
<i>D. ...</i> Chief Engineer		
<i>C. ...</i> For Comptroller	<i>W. ...</i> Vice President	

Date: Jan. 1 1929

Date of Final Approval: JAN 30 1929

COMPTROLLER'S RECORD OF NOTICE OF APPROVAL AND OF COMPLETION

Form No. 1348 issued
18 Work begun
19 Work finished April 15 1929

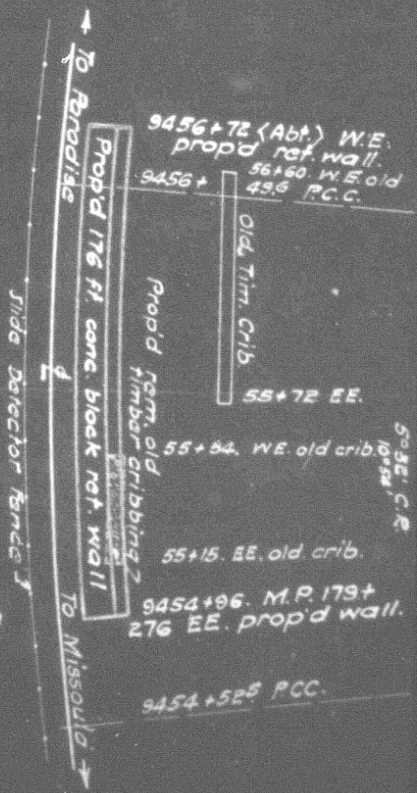
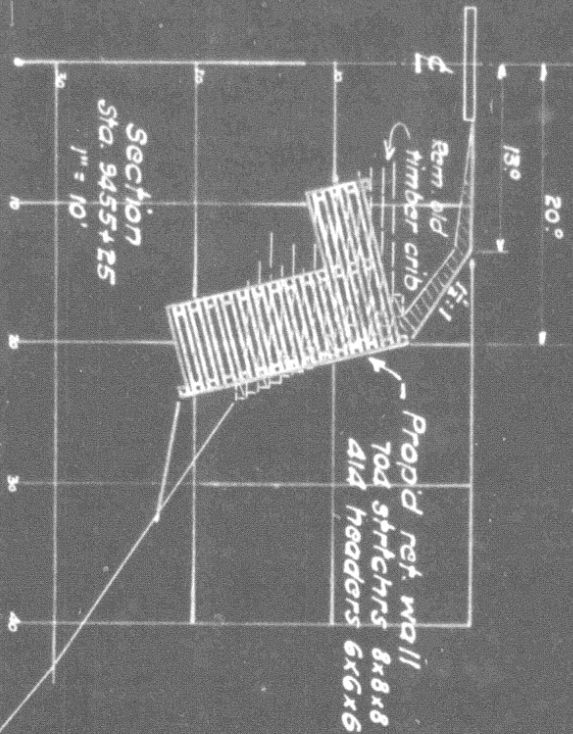

R.M. Div.
 Prop'd precast conc. block retaining wall 176 ft
 long, at M.P. 179+276, - 3
 miles west of
Westfall
 10' x 50'

Office of Dist. Engineer, Livingston, Mont.
 Prop'd new work
 narrow gis
 Vol. Section
 1929 budget item.

N.P.R.Y.
 Dwg. No. _____
 3rd Dist.
 Dec. 6, 1928
 Mont. No. 19

9452+20
 179