



N. P. 1363
8-24

NORTHERN PACIFIC RAILWAY COMPANY

AUTHORITY FOR EXPENDITURE

COMPTROLLER'S COPY

SUPERINTENDENT'S No. 39

1929 1929

1929 1929

No.

DEPT. No.

ENGINEERING DEPT. No. 27-29

A. F. E. NO. 196

Rocky Mtn Div. Third

DISTRICT BRANCH STATE Montana

VAL. SEC. No. 19

AUTHORITY IS REQUESTED FOR A NET EXPENDITURE OF \$ 12349

Accounting distribution as follows: (Distribution to be made in General Office.)

	Operating Expenses	Profit and Loss	Net Operating Expenses	Net Profit and Loss
Cost of property retired	3000			
Value of salvage			3000	
Incidental costs			166	
Total to Operating Expenses				
Total to Profit and Loss				3166 ✓
To Material and Supplies				
To Bills for Collection				
To Other Accounts				
Net charge to investment account—Additions and Betterments				
Total of distribution				9184 ✓
				12349 ✓

Original Cost Adjustment
Made in 11-30-1927
Final

Budget reference: Item 25

Joint facility contract reference: Not Joint

Class of Work No. 1 ✓

The location is on this company's property. To secure rights, it will be necessary

Location: 2 3/4 Miles West of Westfall - Montana

Title Concrete Retaining Wall

and

Reason: The 1928 fall bridge inspection disclosed the necessity for concrete block retaining wall replacing timber crib at above location, as per estimate and blue print attached.

Work to be done by company force under charge of Superintendent

Accounting to concentrate in the office of Superintendent

Signature and Title: J. H. Johnson Superintendent

Checked and Forwarded
President's Office

Date Jan. 1 1929

<i>[Signature]</i> General Superintendent	<i>[Signature]</i> Asst. Chief Engr. or Engr. in Charge	<i>[Signature]</i> General Manager
<i>[Signature]</i> Chief Engineer	<i>[Signature]</i> Vice President	
<i>[Signature]</i> Per Comptroller	<i>[Signature]</i> President	Date of Final Approval { JAN 30 1929

COMPTROLLER'S RECORD OF NOTICE OF APPROVAL AND OF COMPLETION

Form No. 1346 issued

19

Work begun

19

Work finished

April 30 1929

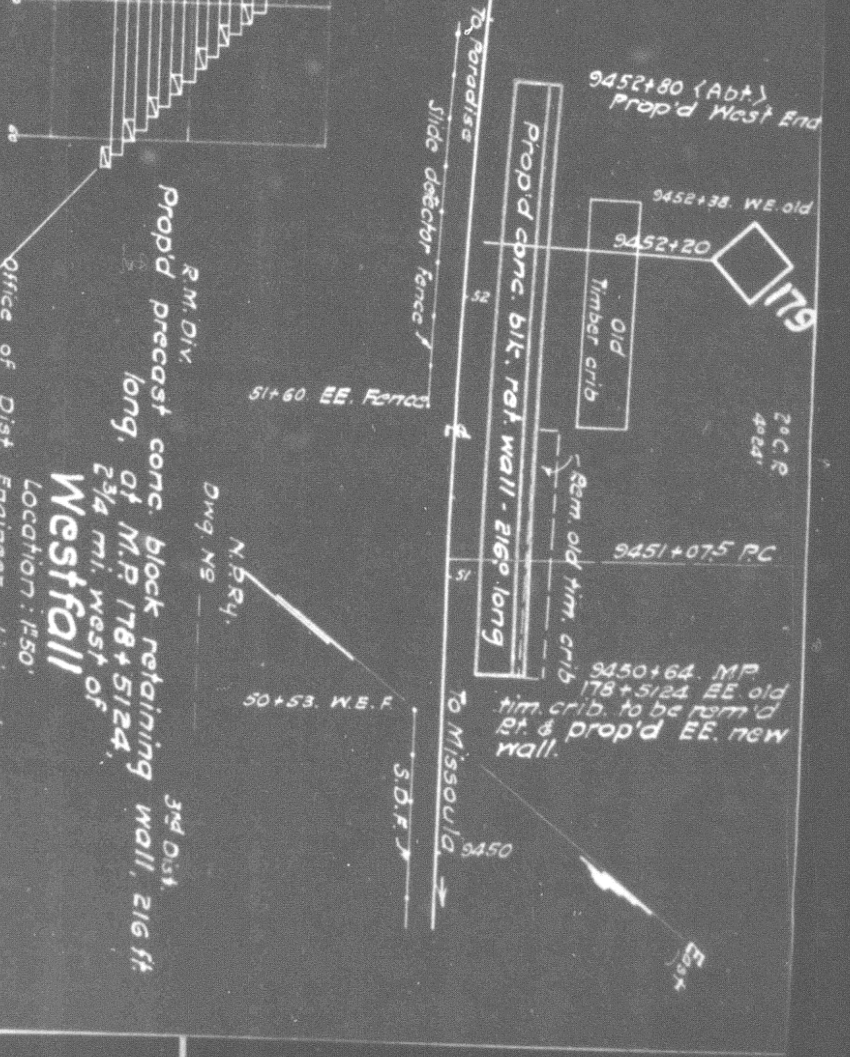
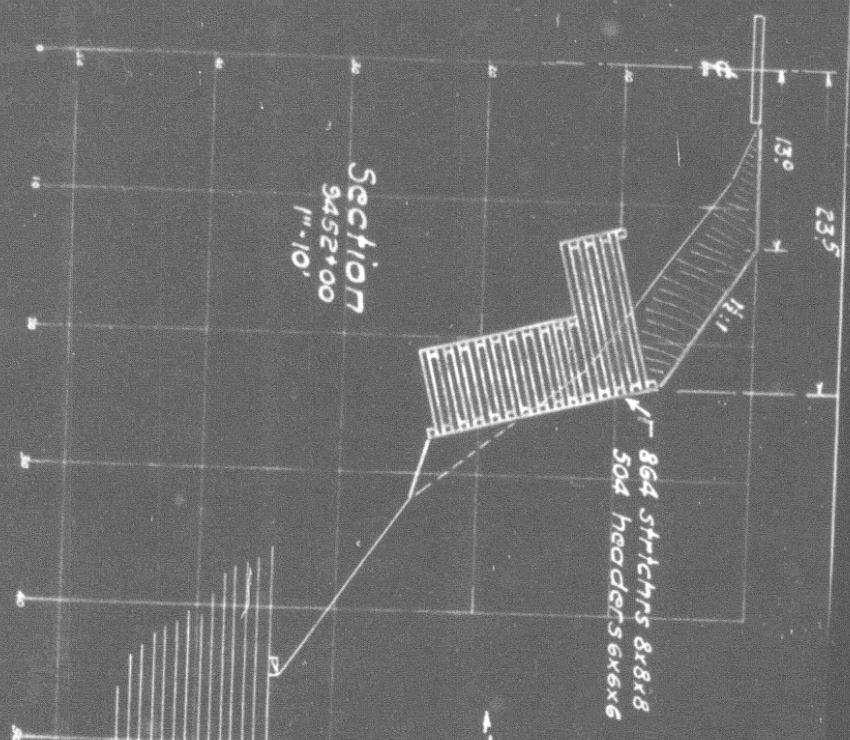

R.M. Div.
 Prop'd precast conc. block retaining wall, 216 ft.
 long, at M.P. 178+5124,
 2 3/4 mi. west of
Westfall
 Location: 1750.
 Office of Dist. Engineer, Livingston, Mont., Dec. 6, 1928
 Prop'd new work
 removals
 1929 budget item
 Vol. Sec. Mont. #19