

N. P. R.

NORTHERN PACIFIC RAILWAY COMPANY
AUTHORITY FOR EXPENDITURE

COMPTROLLER'S

1929 1029
YEAR

Superintendent's No. 36

DEPT. No.

ENGINEERING DEPT. No.

A. F. E. NO. 194

Rocky Mtn

Div.

Third

DISTRICT STATE Montana

VAL. SEC. No. 19

AUTHORITY IS REQUESTED FOR A NET EXPENDITURE OF \$ 12823

Accounting distribution as follows: (Distribution to be made in General Office.)

	Operating Expenses	Profit and Loss	Net Operating Expenses	Net Profit and Loss
Cost of property retired				
Value of salvage				
Incidental costs				
Total to Operating Expenses				815 ✓
Total to Profit and Loss				
To Material and Supplies				
To Bills for Collection				
To Other Accounts				
Net charge to investment account—Additions and Betterments				12008 ✓
Total of distribution				12823 ✓

Cost Adjustment
11-30-29
Fina!

Budget reference:

Class of Work: No. 1 ✓

Joint facility contract reference:

The location is _____ on this company's property. To secure rights, it will be necessary

Location: 2 1/4 Miles West of Rivulet - Montana

Title: Concrete Retaining Wall

and

Reason: The 1928 fall bridge inspection disclosed the necessity for concrete block retaining wall replacing timber crib at above location, as per estimate and blue print attached.

Work to be done by company force under charge of Superintendent

Accounting to concentrate in the office of Superintendent

Signature and Title: Superintendent

Date Jan. 1 1929

<i>[Signature]</i> General Superintendent	<i>[Signature]</i> Asst. Chief Eng. or Chief Eng.	<i>[Signature]</i> Chief Eng.
<i>[Signature]</i> Chief Engineer	<i>[Signature]</i> Per Comptroller	<i>[Signature]</i> Per [Title]



COMPTROLLER'S RECORD OF NOTICE OF APPROVAL AND OF COMPLETION

Form No. 100 issued _____ Work began _____ Work Completed March 5 1929

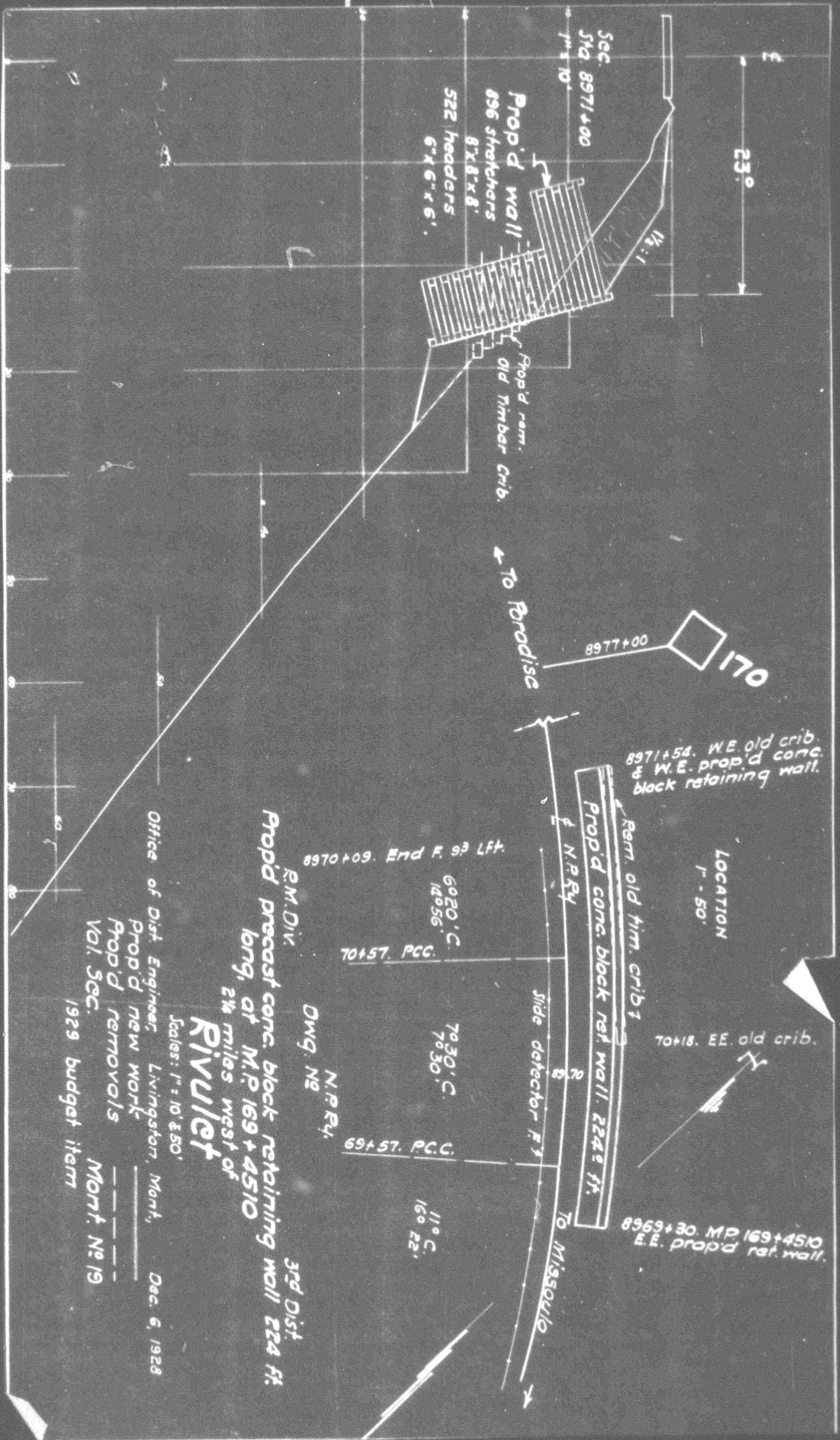

Office of Dist. Engineer, Livingston, Mont., Dec. 6, 1928
 Prop'd new work
 Prop'd removals
 Vol. 50C.
 1929 budget item
 Mont. No 19
 3rd Dist.
 Prop'd precast conc. block retaining wall 224 ft.
 long, at M.P. 169 + 4510
 2 1/4 miles west of
Rivulet
 Scales: 1" = 10' & 50'

R.M. Div.
 Dwg. No. N.P.Ry.
 8970+09. End F. 93 Lft.
 70+57. P.C.C.
 6920' C. 14056'
 70+30' C. 7030'
 69+57. P.C.C.
 11° C. 160' 22'