



N. P. 1363  
6-24

# NORTHERN PACIFIC RAILWAY COMPANY AUTHORITY FOR EXPENDITURE

COMPTROLLER'S COPY

1929

1929  
YEAR 1929

SUPERINTENDENT'S No.

M.F.C. No.

DEPT. No.

ENGINEERING DEPT. No. 5

A. F. E. NO.

189

TACOMA

Div.

First

DISTRICT

STATE

Wash.

VAL. SEC. No. 6

AUTHORITY IS REQUESTED FOR A NET EXPENDITURE OF \$ 9 100.

Accounting distribution as follows: (Distribution to be made in General Office.)

	Operating Expenses	Profit and Loss	Net Operating Expenses	Net Profit and Loss
Cost of property retired	\$ 1 000.			
Value of salvage	30.			
Incidental costs			970.	
			290.	
Total to Operating Expenses				\$ 1 260. ✓
Total to Profit and Loss				
To Material and Supplies				30. ✓
To Bills for Collection				
To Other Accounts				
Net charge to investment account—Additions and Betterments				7 840. ✓
Total of distribution				\$ 9 130. ✓

Original Cost Adjustment  
Made in 19

Budget reference: Item 178- 1929 Budget

Joint facility contract reference: G.N.Ry. } 7-1-1909  
O.W.R. & N.Co. } Valuation

Class of Work: No. 4 ✓

The location is on this company's property. To secure rights, it will be necessary to do nothing

Location: Near Kelso, Washington, Bridge 101-1, Undercrossing.

Title: Replace Timber Trestle with reinforced concrete trestle.

and

Reason: The present structure consists of a 45 foot double track pile trestle 12 feet high, built in 1915. The timber has reached the end of its life and must be renewed in 1929. It is proposed to replace it with a 48 foot reinforced concrete trestle.

Cost of Permanent Work	\$9 100.
Cost to Renew in Kind	2 810.
Annual Cost Permanent Work	546.
Annual Cost Renewal in Kind	522.

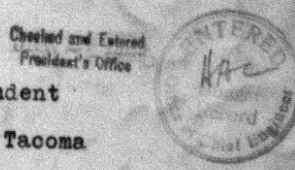

Work to be done by company force under charge of **Division Superintendent**

Accounting to concentrate in the office of **Division Superintendent at Tacoma**

Signature and Title: *M. B. Clements* **Bridge Engineer**

Date **Nov. 14, 1928**

APPROVED:

General Superintendent.	Asst. Chief Engr. or Engr. Maint. of Way.	General Manager.
Mech. Supt., Supt. Telgh. or Signal Engr.		
<i>Bernard Blum</i> Chief Engineer.		<i>[Signature]</i> Vice President.
<i>[Signature]</i> For Comptroller.	<i>Charles W. [Signature]</i> President	Date of Final Approval { <b>JAN 29 1929</b> } 19

COMPTROLLER'S RECORD OF NOTICE OF APPROVAL AND OF COMPLETION

Form No. 1346 issued

19

Work begun

19

Work finished

19

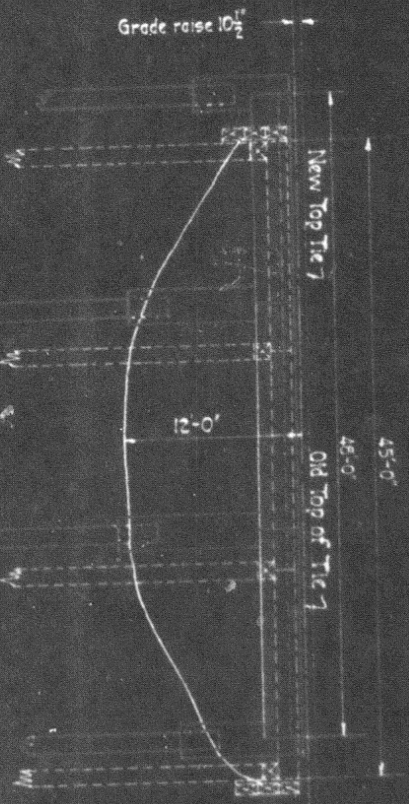
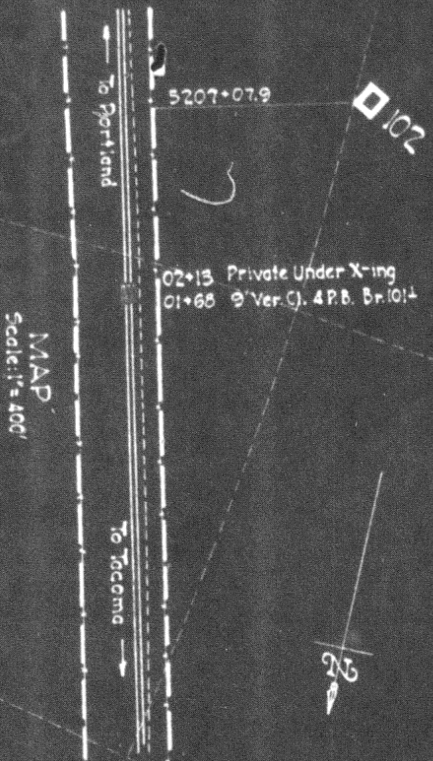
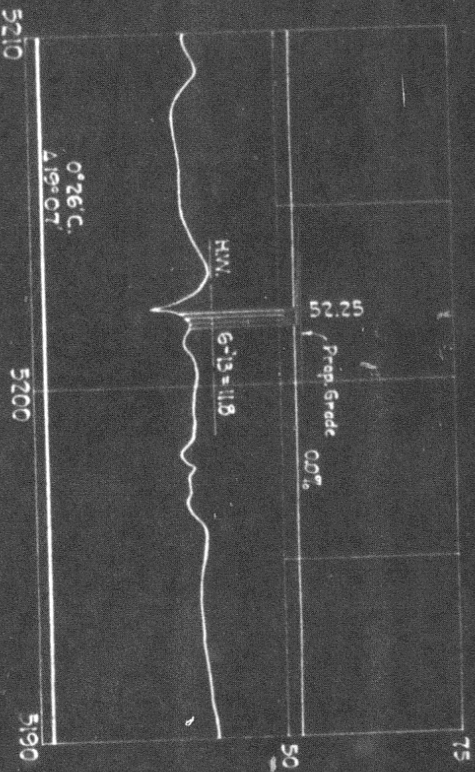

NORTHERN PACIFIC RAILWAY  
 TACOMA DIVISION FIRST SUBDIVISION  
 Valuation Section Wash. S  
 BRIDGE 101 UNDERCROSSING  
 NEAR KELSO, WASHINGTON  
**REPLACE PILE TRESTLE  
 WITH 3-16FT REINFORCED CONCRETE SPANS**

Office of Bridge Engineer St. Paul, Minn. Nov. 13, 1926  
 SCALES AS NOTED