



N. P. 1363  
6-24

# NORTHERN PACIFIC RAILWAY COMPANY AUTHORITY FOR EXPENDITURE

COMPTROLLER'S COPY

1929 1929  
YEAR 1929

SUPERINTENDENT'S No. **1929**  
M. F. No. **1929**

DEPT. No. **2**  
ENGINEERING DEPT. No. **2**

A. F. E. NO. **188**

Tacoma

Div.

First

DISTRICT STATE  
~~BRANCH~~ Wash.

VAL. SEC. No. **7**

**AUTHORITY IS REQUESTED FOR A NET EXPENDITURE OF \$ 33 580.**

Accounting distribution as follows: (Distribution to be made in General Office.)

	Operating Expenses	Profit and Loss	Net Operating Expenses	Net Profit and Loss
Cost of property retired.....	4 660.		4 460.	
Value of salvage.....	200.		2 330.	
Incidental costs.....				
Total to Operating Expenses.....				\$ 6 790.
Total to Profit and Loss.....				200.
To Material and Supplies.....				
To Bills for Collection.....				
To Other Accounts.....				
Net charge to investment account—Additions and Betterments.....				26 790.
Total of distribution.....				\$ 33 780.

Original Cost Adjustment  
Made in 12-13 1929  
Final

Adjusted 1933  
FEB

Adjusted 1932  
JUN

Budget reference: **Item 174, 1929 Budget**

Month: **MAR 1931**

Class of Work: No. **4**

Joint facility contract reference: **O.W.R. & N. and G.N. Ry. 7-1-09**

The location is --- on this company's property. To secure rights, it will be necessary to do nothing

Location: **Near Ridgefield, Washington - Bridge 124, Farm Undercrossing and stream.**

Title: **Replace pile trestle with a permanent bridge.**

Reason: **The present structure consists of double track 135 foot pile trestle 35 feet high, on a two degree curve, built in 1915. The timber has reached the end of its life and must be replaced in 1929. It is proposed to place 1-60 foot deck plate girder and 2-35 foot I Beam spans on concrete masonry.**

Cost of Permanent Work	\$33 780.
Cost to Renew in Kind	10 320.
Annual Cost Permanent Work	2 026.
Annual Cost Renewal in Kind	2 064.



Work to be done by ~~contract~~ company force under charge of **Division Superintendent**

Accounting to concentrate in the office of **Division Superintendent**

Checked and signed  
President's Office

Signature and Title: **M.B. Clements** **Bridge Engineer**

Date **Sept. 28, 1928**

APPROVED:	
General Superintendent.	Asst. Chief Engr. or Engr. Maint. of Way.
Mech. Supt., Supt. Teleg. or Signal Engr.	General Manager.
<b>Dennis Johnson</b> Chief Engineer.	<b>[Signature]</b> Vice President.
<b>[Signature]</b> For Comptroller.	<b>Charles H. Hensley</b> President

Date of Final Approval **JAN 29 1929**

COMPTROLLER'S RECORD OF NOTICE OF APPROVAL AND OF COMPLETION

Form No. 1948 issued 19... Work begun... 19... Work finished **Sept 30 29** 19...

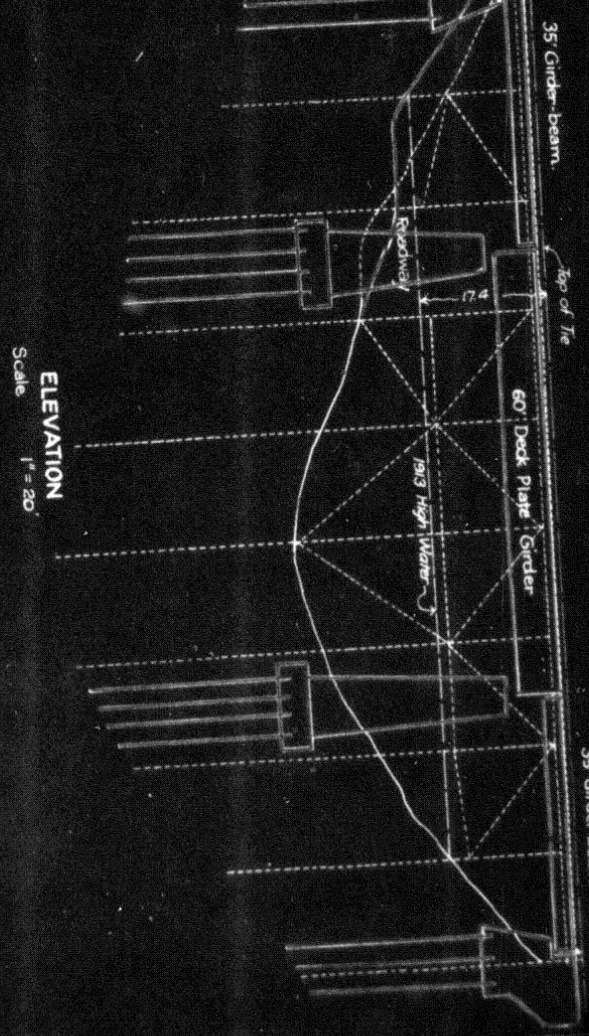
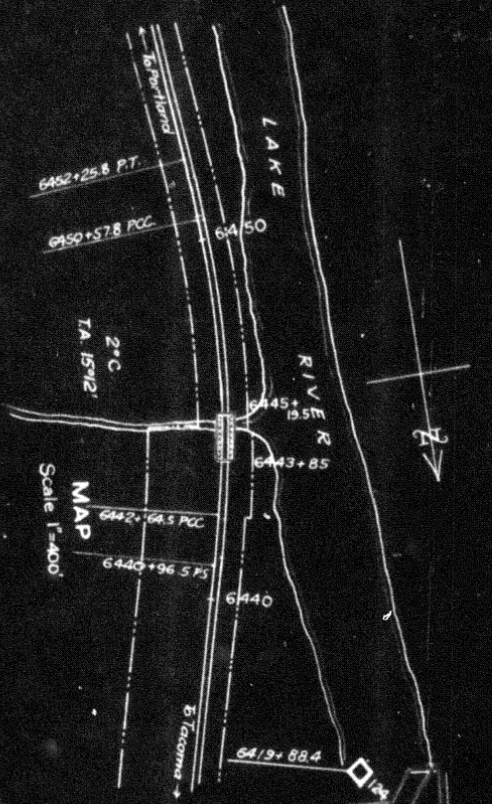
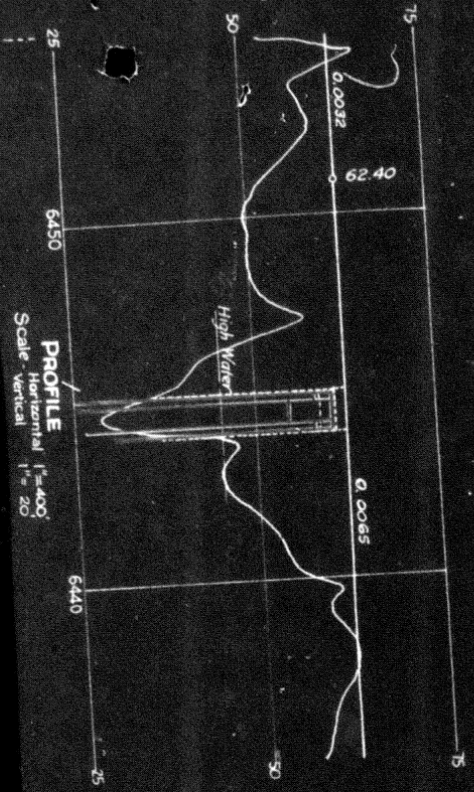

Length of present double track pile bridge 135 ft.  
 Length of proposed steel bridge 132 ft.

**ELEVATION**  
 Scale 1" = 20'

**PROFILE**  
 Scale - Horizontal 1" = 400'  
 Vertical 1" = 20'

N.P.R.V.  
 FIRST SUBDIVISION  
**RIDGEFIELD**  
 BRIDGE 124 - FARM UNDERCROSSING AND STREAM  
 REPLACE PILE TRESTLE WITH A PERMANENT BRIDGE

SCALES AS NOTED

Office of Bridge Engineer, St. Paul, Minn. Sept. 28, 1928  
 Proposed New Work  
 Proposed Retirements

VALUATION SECTION: WASHINGTON # 7.