



N. P. 1363
6-24

NORTHERN PACIFIC RAILWAY COMPANY
AUTHORITY FOR EXPENDITURE

COMPTROLLER'S COPY

1929/1929
YEAR 1929

SUPERINTENDENT'S NO. 18
No.

DEPT. No.
ENGINEERING DEPT. No. 33

A. F. E. NO. 35

Yellowstone Div.

Fourth DISTRICT STATE Montana VAL. SEC. No. 1-A

AUTHORITY IS REQUESTED FOR A NET EXPENDITURE OF \$ 365.

Accounting distribution as follows: (Distribution to be made in General Office.)

	Operating Expenses	Profit and Loss	Net Operating Expenses	Net Profit and Loss
Cost of property retired				
Value of salvage				
Incidental costs				
Total to Operating Expenses				
Total to Profit and Loss				
To Material and Supplies				
To Bills for Collection				
To Other Accounts				
Net charge to investment account—Additions and Betterments				265
Total of distribution				265

Budget reference: 1929 budget item 21

Added to Joint Valuation MAR 1931

Class of Work: No. 1

Joint facility contract reference: Joint with CB&Q Ry contract dated 9-1-1922.

The location is on this company's property. To secure rights, it will be necessary to do nothing.

Location: 2 miles west of Huntley

Title Estimated cost of riprap to protect roadbed against the Yellowstone River between MP 215-1735 and MP 215-1800 as per sketch dated Dec 1, 1928.

Reason:

At the point indicated in the attached blue print the Yellowstone River during periods of high water cuts into our embankment and to prevent further damage it is recommended that riprapping be done as per the estimate attached. This recommendation is the result of survey made during the fall of 1928 by Roadmasters and a Representative of the Engineering Department.

Work to be done by company force under charge of Division Superintendent

Accounting to concentrate in the office of Division Superintendent

Signature and Title: P. T. Taylor Supt

Checked and Entered President's Office Date Dec 13th 1928

<i>[Signature]</i> General Superintendent.	<i>[Signature]</i> Asst. Chief Engr. in Charge Maint.-of-Way.	<i>[Signature]</i> General Manager.
<i>[Signature]</i> Mech. Supt., Supt. Telegraph or Signal Engr.	<i>[Signature]</i> Chief Engineer.	<i>[Signature]</i> Vice President.
<i>[Signature]</i> For Comptroller.	<i>[Signature]</i> President.	Date of Final Approval { JAN 18 1929 }

COMPTROLLER'S RECORD OF NOTICE OF APPROVAL AND OF COMPLETION

Form No. 1345 issued 19 Work begun 19 Work finished Feb 1 1929

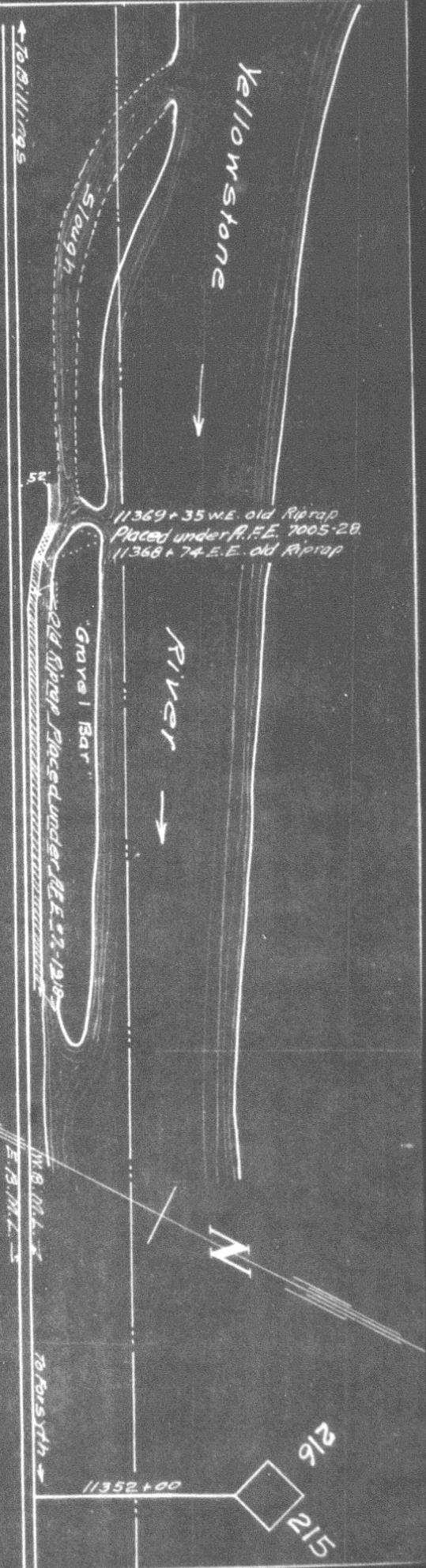

11370+00 W.E.
 Prop'd Ext. Riprap 65 Cu. Yds. "Loose"
 11369+35 E.E.

11369+35 W.E. Old Riprap
 Placed under R.F.E. 7005-28.
 11368+74 E.E. Old Riprap

"Gravel Bar"
 Old Riprap Placed under R.F.E. #2-12-18

N.P.R.
 Drawing No. _____
 4th Dist.
 Yellow Div.
 Proposed Riprap to Protect Roadbed
 Between
 M.P. 215+1735 & M.P. 215+1800
 2 Miles West of Huntley
 Scale: 1" = 200'
 Office of Dist. Engr. Livingston, Mont. Dec. 1-1928
 Project New Work Shown _____
 Valuation Section Mount No. 1.A
 1929 Budget Item _____