



N. P. 1363
6-24

NORTHERN PACIFIC RAILWAY COMPANY

AUTHORITY FOR EXPENDITURE

1929
YEAR 1928

SUPERINTENDENT'S No. 204
No.

DEPT. No.
ENGINEERING DEPT. No. 229-28

A. F. E. NO. 16

Tacoma
Div. Green River Branch DISTRICT STATE Wash VAL. SEC. NO. 2-C

AUTHORITY IS REQUESTED FOR A NET EXPENDITURE OF \$ 525
(Distribution to be made in General Office.)

Accounting distribution as follows:	Operating Expenses	Profit and Loss	Net Operating Expenses	Net Profit and Loss
Cost of property retired	24		24	
Value of salvage			11	35 ✓
Incidental costs				
Total to Operating Expenses				
Total to Profit and Loss				
To Material and Supplies				375 ✓
To Bills for Collection				865 ✓
To Other Accounts				525 ✓
Net charge to investment account—Additions and Betterments				
Total of distribution				

P & L 606 Donations
Original Cost Adjustment
Made in 10-17-1929
Final

Class of Work: No. 10 ✓

Budget reference:
Joint facility contract reference: **Non Joint**

The location is _____ on this company's property. To secure rights, it will be necessary

Location: **Kerriston**
Title: **Spur track for Kerriston Shingle Company**
and
Reason: **Track increase 250 ft.**

The Kerriston Shingle Company have secured enough timber to provide for operating their plant for at least ten years, and state they have about two million feet of veneer blocks besides poles, etc., to get out. The Kerriston Company are also planning on putting up a small hemlock mill to be also served by this spur and expect to make steady shipments of about 3 cars per week.

I would therefore recommend that track be constructed on the basis of Railway Company bearing that portion of expense from head block to clearance point - balance of track from clearance point to end to be constructed at expense of the applicant. Form 802 dated November 29th attached. Informal authority to proceed with construction of track received November 23rd, 1928 and material is now being assembled.

Informally auth. by V. R.
11-23-1928

Work to be done by company force under charge of **E2222**

Superintendent
Division Accountant

Checked and Entered
President's Office
Date Dec 3 1928

Accounting to concentrate in the office of _____

Signature and Title: _____ Superintendent

APPROVED: _____
General Superintendent

_____ Asst. Chief Engr. or Engr. Maint. of Wks.

_____ Western Traffic Manager

_____ Chief Engineer

_____ Vice President

For Comptroller: _____
Date of Final Approval { JAN 9 1929

COMPTROLLER'S RECORD OF NOTICE OF APPROVAL AND OF COMPLETION
19 _____ Work begun _____
19 _____ Work finished _____

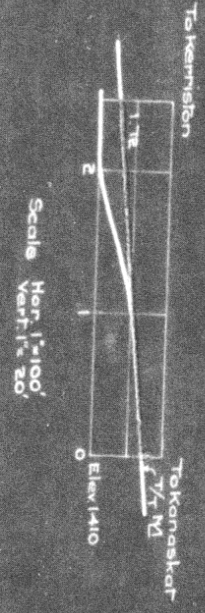
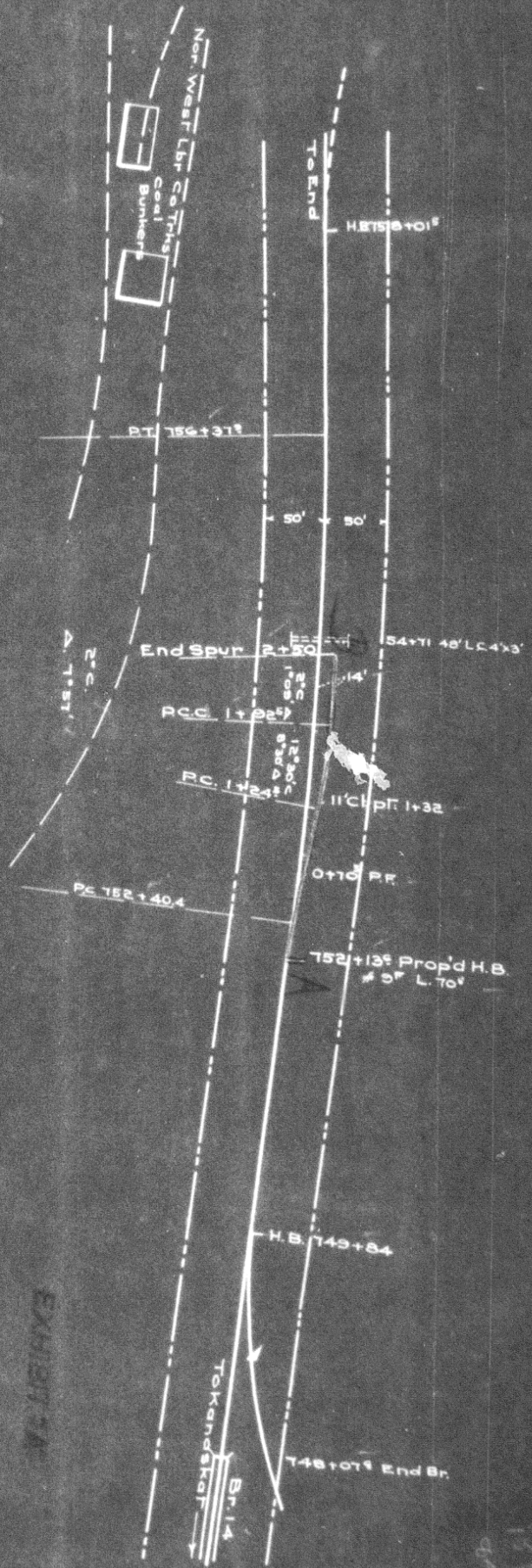

N.P. Ry
 Tacoma Div. Green River Br.
 Wash. Val. Sec. 2c
Proposed Spur for
KERRISTON Wn.
 Office of Dist. Engr. Seattle Wn.
 Scale 1"=100' Nov. 16, 1928

EXHIBIT