



N. P. 1363  
6-24

# NORTHERN PACIFIC RAILWAY COMPANY AUTHORITY FOR EXPENDITURE

1928  
YEAR 1928

SUPERINTENDENT'S No. 97  
No.

DEPT. No.  
ENGINEERING DEPT. No. 115-28

A. F. E. NO. 14

Idaho Div. First District DISTRICT STATE Idaho VAL. Sec. No. 1  
BRANCH

AUTHORITY IS REQUESTED FOR A NET EXPENDITURE OF \$189

Accounting distribution as follows: (Distribution to be made in General Office.)

	Operating Expenses	Profit and Loss	Net Operating Expenses	Net Profit and Loss
Cost of property retired		6000		5070
Value of salvage		930		715
Incidental costs				
Total to Operating Expenses				5785 ✓
Total to Profit and Loss				930 ✓
To Material and Supplies				
To Bills for Collection				
To Other Accounts				5974 ✓
Net charge to investment account—Additions and Betterments				741 ✓
Total of distribution				

Acct. 619 Loss on Retired R & E

Original Cost Adjustment  
Made in 10-17-1929  
Final

Class of Work: No. 20

Budget reference: NOT IN BUDGET.

Joint facility contract reference: Non Joint

The location is on this company's property. To secure rights, it will be necessary

Location: Cabinet, Idaho.

Title Estimated cost to abandon and remove water station facilities.

Reason: The water station at Cabinet has not been used for a number of years. The pump house and machinery were removed some time ago. The water tank is worn out and useless.

Work to be done by company force under charge of contract

Checked and Entered  
President's Office

Date 12/2- 1928

Accounting to concentrate in the office of

Signature and Title: *[Signature]* Supt.

APPROVED: *[Signature]* General Superintendent. *[Signature]* Asst. Chief Engr. or Engr. Maint. of Way. *[Signature]* General Manager.

*[Signature]* Mech. Supt., Supt. Telgh. or Signal Engr. *[Signature]* Vice President.

*[Signature]* Chief Engineer. *[Signature]* President.

*[Signature]* For Comptroller. *[Signature]* President.

Date of Final Approval { JAN 6 1929

COMPTROLLER'S RECORD OF NOTICE OF APPROVAL AND OF COMPLETION

19 Work begun 19 Work finished

101-3716  
101-466  
101-471

34+54 End 12" C.I.P.  
14834+08 Stand Pipe Box 6' x 6' removed

To South  
Pipe abandoned

14825+596 PCC

14823+948 RS

14823+26 End Pipe removed

14820

CABINET

1500' 12" C.I.P. removed  
148121  
14810  
14808+26 Beg Pipe removed

Sec. 28 T. 55 N. R. 3 E B. 17  
27 55 3

148121  
14810  
14808+26 Beg Pipe removed

H.B. 14808+47# Ld. C&E  
14807+96 Stand Pipe  
to be removed

Signal/Maintainer 3/4" Con.

14805+17' PT

5-33' Chs  
2° 30' Δ  
Section  
14803+52' PCC. No.

3250' 4" C.I.P. from Spring  
3° C.  
20' 46" Δ

14796+598 PCC  
5-33' Chs  
2° 30' Δ

14794+948 RS

To be removed  
14801+103' W.T.  
24' Δ

14800

To be removed  
14801+103' W.T.  
24' Δ  
W.P. discharge  
abandoned  
14801+103' W.T.  
24' Δ  
14801+103' W.T.  
24' Δ  
14801+103' W.T.  
24' Δ

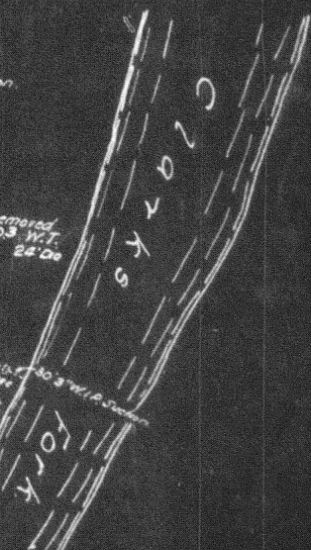

CABINET

N.P.R.  
Idaho Div. 1st. subdi.  
Propd. to remove water service  
Station facilities  
of  
CABINET  
Scale: 1" = 300'  
Office Dist. Engr. Spokane AS-28  
facilities removed or abandoned  
Idaho Div. 1st. subdi.  
Propd. service pipe thus