



N. P. 1363
6-24

NORTHERN PACIFIC RAILWAY COMPANY
AUTHORITY FOR EXPENDITURE

1929
YEAR 1928

SUPERINTENDENT'S No. 203
No. 1929

DEPT. No.
ENGINEERING DEPT. No. 228-28

A. F. E. NO. 11

Tecome DIV. Main Line

DISTRICT STATE Oregon VAL. SEC. No. 2

AUTHORITY IS REQUESTED FOR A NET EXPENDITURE OF \$ 842

Accounting distribution as follows: (Distribution to be made in General Office.)

Cost of property retired	Operating Expenses	Profit and Loss	Net Operating Expenses	Net Profit and Loss
Value of salvage				
Incidental costs				
Total to Operating Expenses				
Total to Profit and Loss				
To Material and Supplies				
To Bills for Collection				
To Other Accounts				
Net charge to investment account—Additions and Betterments				
Total of distribution				\$ 842 ✓

Budget reference: SP&S Ry }
G.N. Ry }
Joint facility contract reference: N.P. Ry } 12-1-09

Class of Work: No. 13 ✓

The location is on this company's property. To secure rights, it will be necessary

Location: Willbridge (near)

Title: Installation of submarine cable across Willamette River

Reason: The present telephone submarine cable across the Willamette River was placed in 1921 and since then has been struck by boats and is badly damaged, there being six defective conductors in it at present.

It is proposed to lay an entire new submarine cable from shore to shore and in this way eliminate danger of having it struck by boats. The present aerial wire and supports, together with cable, to be left in place for emergency purposes. Work to be done by SP&S Ry under its AFE 5002. This RFA is submitted to cover Northern Pacific Railway proportion of cost.

Estimate and blue print furnished by Engineering Department attached.

Work has been completed.

Cost in association 1924-57 No 50380-1949

Work to be done by company ~~force~~ under charge of

Superintendent *Telegraph*

Accounting to concentrate in the office of

Division Accountant *Telegraph*

Signature and Title:

APPROVED: <i>[Signature]</i> General Superintendent.	<i>[Signature]</i> Superintendent Asst. Chief Engr. or Engr. Maint. of Way.	Date Nov 30 1928 <i>[Signature]</i> General Manager.
<i>[Signature]</i> Mech. Supt., Supt. T-Inst. or Signal Engr.	<i>[Signature]</i> Chief Engineer.	<i>[Signature]</i> Vice President.
<i>[Signature]</i> For Comptroller.	<i>[Signature]</i> Charles J. Connelly President.	Date of Final Approval { JAN 7 1929 } 19

COMPTROLLER'S RECORD OF NOTICE OF APPROVAL AND OF COMPLETION

Form No. 1345 issued. 19 Work begun 19 Work finished 19

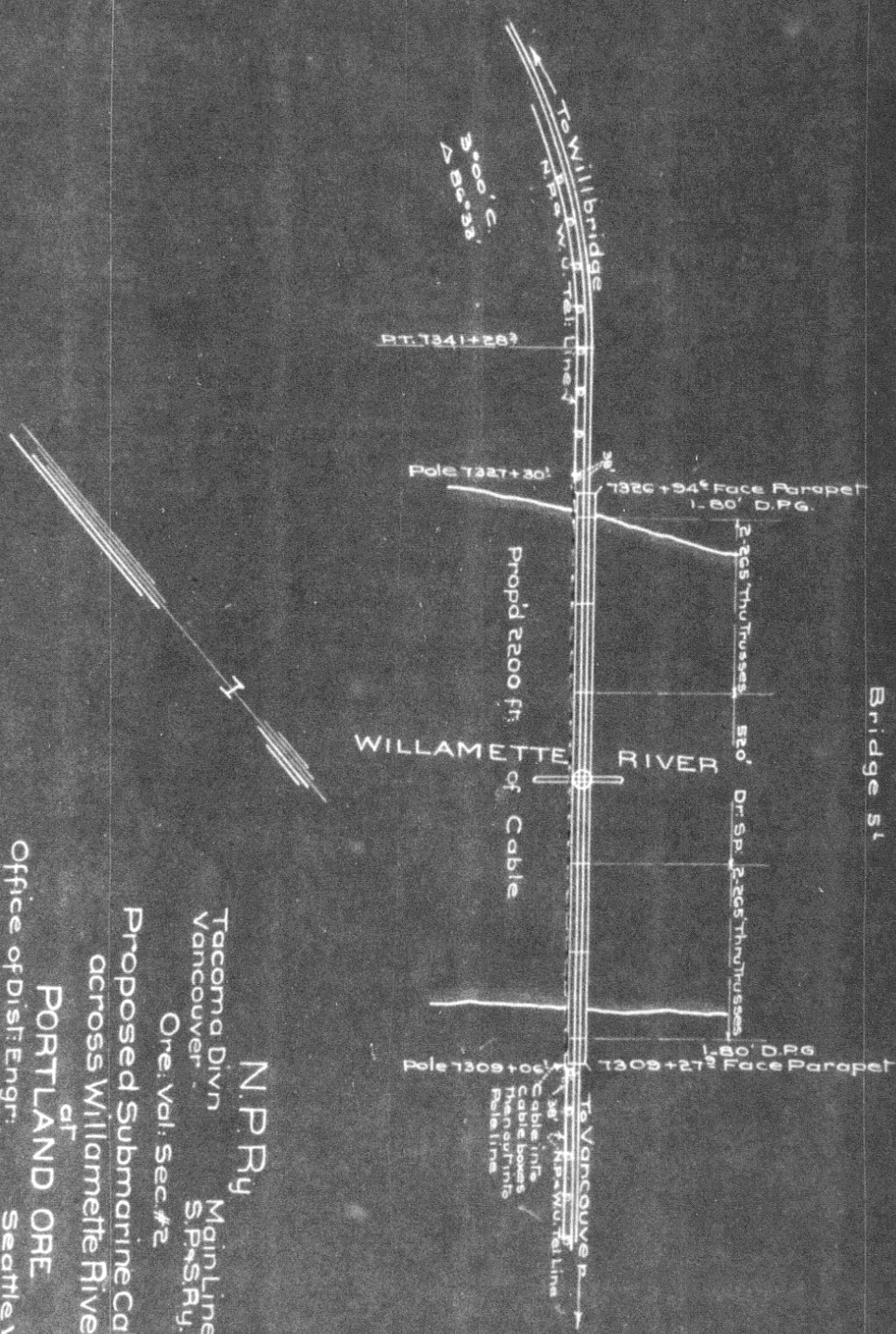

N.P.Ry
 Tacoma Divn
 Vancouver
 Ore. Vol. Sec. #2
 Proposed Submarine Cable
 across Willamette River
 at
PORTLAND ORE
 Office of Dist. Engr.
 Seattle Wn
 Nov 27 1928
 Scale 1"=400'