



N. P. 1363
6-24

NORTHERN PACIFIC RAILWAY COMPANY
1929 AUTHORITY FOR EXPENDITURE 1929

COMPTROLLER'S COPY.

SUPERINTENDENT'S No.

M.F.C. No.

DEPT. No.

ENGINEERING DEPT. No. 3

A. F. E. NO. 183

Seattle

Div.

First

DISTRICT STATE

Wash.

VAL. SEC. No. 2

AUTHORITY IS REQUESTED FOR A NET EXPENDITURE OF \$ 8 360.

Accounting distribution as follows: (Distribution to be made in General Office.)

	Operating Expenses	Profit and Loss	Net Operating Expenses	Net Profit and Loss
Cost of property retired	\$ 800.			
Value of salvage	120.		680.	
Incidental costs			410.	
Total to Operating Expenses				\$ 1 090.
Total to Profit and Loss				
To Material and Supplies				120.
To Bills for Collection				
To Other Accounts				
Net charge to investment account—Additions and Betterments				7 270.
Total of distribution				\$ 8 480.

Original Cost Adjustment
Made in 10-30-1929
Jual
Aug-11-11-31

Budget reference: Item 157, 1929 Budget

Class of Work: No. 4

Joint facility contract reference: None

The location is --- on this company's property. To secure rights, it will be necessary to do nothing

Location: Near Eagle Gorge, Washington - Bridge 72, Dean Creek.

Title: Replace pile trestle with 50 foot Deck Plate Girder.

and

Reason: The present structure consists of a 73 foot pile trestle 14 feet high, built in 1913 and 1922. The timber has reached the end of its life and must be replaced in 1929. It is proposed to place a 50 foot Deck Plate Girder Span designed for E-65 loading, on concrete masonry.

Cost of Permanent Work	\$8 360.
Cost of Renewal in Kind	2 200.
Annual Cost Permanent Work	502.
Annual Cost Renewal in Kind	440.

Work to be done by company force under charge of Division Superintendent

Accounting to concentrate in the office of Division Superintendent

Signature and Title: M. Clements Bridge Engineer

Date Sept. 25, 1928

APPROVED:		
General Superintendent.	Ast. Chief Engr. or Engr. Maint. of Way.	General Manager.
Mech. Supt., Supt. Trench or Signal Engr.		
Chief Engineer.		Vice President.
For Comptroller.	President	Date of Final Approval { JAN 25 1929

COMPTROLLER'S RECORD OF NOTICE OF APPROVAL AND OF COMPLETION

Form No. 1345 issued. 19. Work begun. 19. Work finished.

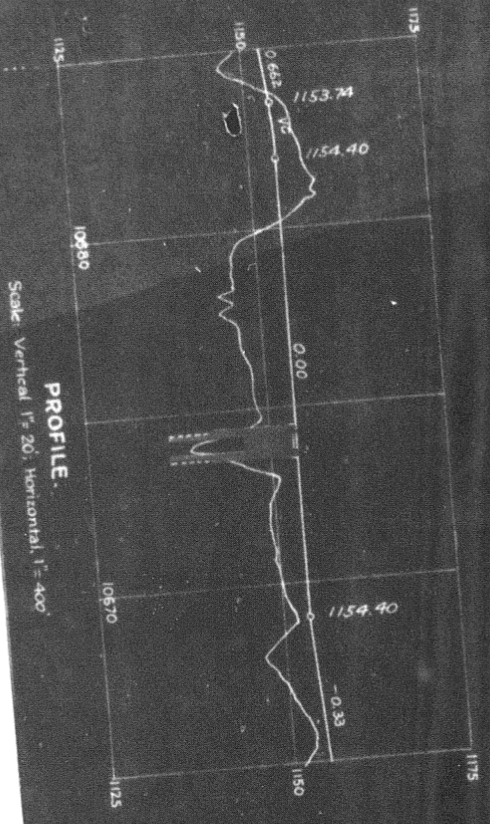

MAP
Scale 1" = 400'

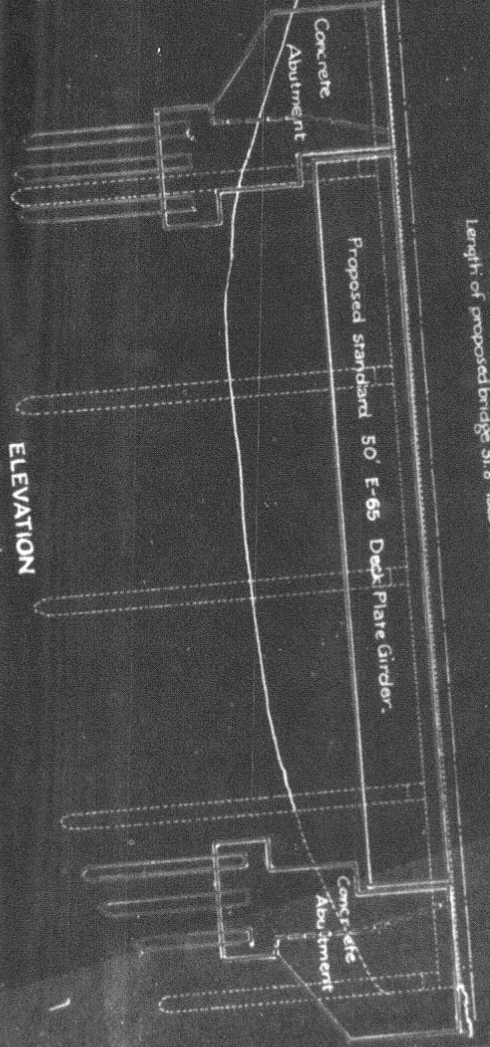
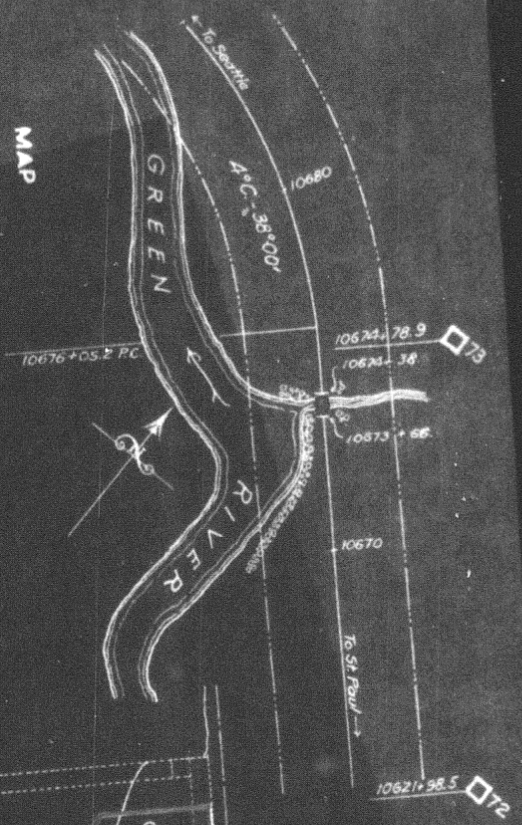

Length of present pile trestle - 72'
Length of proposed bridge 51.8' face to face of parapet

ELEVATION
Scale 1" = 10'

N. P. RY.
FIRST SUBDIVISION
SEATTLE DIVISION
EAGLE GORGE
DEAN CREEK
BRIDGE 72'-
REPLACE PILE TRESTLE WITH 50 FOOT DECK PLATE GIRDER
SCALES VARIOUS:
Office of Bridge Engineer, St. Paul, Minn., Sept 25, 1928
Proposed new work
Proposed retracements
VALUATION SECTION WASHINGTON # 2.