



N. P. 1363  
6-24

# NORTHERN PACIFIC RAILWAY COMPANY AUTHORITY FOR EXPENDITURE

COMPTROLLER'S COPY

SUPERINTENDENT'S No. **63**

1929

1929

1929

No. **1**

DEPT. No. **31-1929**

ENGINEERING DEPT. No. **101-28**

A. F. E. NO.

**182**

**P A S C O**

Div.

**FIRST SUB-DIVN.**

DISTRICT STATE

**WASH.**

VAL. SEC. No. **1**

AUTHORITY IS REQUESTED FOR A NET EXPENDITURE OF \$ **486.**  
Accounting distribution as follows: (Distribution to be made in General Office.)

|  | Operating Expenses | Profit and Loss | Net Operating Expenses | Net Profit and Loss |
|--|--------------------|-----------------|------------------------|---------------------|
| Cost of property retired                                   | \$ 300             |                 |                        |                     |
| Value of salvage   | 273                |                 |                        |                     |
| Incidental costs   |                    |                 | 27                     |                     |
| Total to Operating Expenses                                |                    |                 | 263                    |                     |
| Total to Profit and Loss                                   |                    |                 |                        | \$ 290 ✓            |
| To Material and Supplies                                   |                    | 19              |                        |                     |
| To Bills for Collection                                    |                    |                 |                        | 273 ✓               |
| To Other Accounts  |                    |                 |                        |                     |
| Net charge to investment account—Additions and Betterments |                    |                 |                        | 196 ✓               |
| Total of distribution                                      |                    |                 |                        | \$ 759 ✓            |

Budget reference: *Sten 89-1929*

Joint facility contract reference: **Non Joint.**

Class of Work: No. **3** ✓

The location is \_\_\_\_\_ on this company's property. To secure rights, it will be necessary

Location: **Hatton, Washington**

Title: **Replace Light Rail East End Passing Track With Heavier Rail.**

Reason: **There are approximately 1146' of 66# rail and a small amount of 72# rail in the East end of the passing track, which should be replaced with heavier rail because of the difficulty in maintaining the lighter rail under the heavy power now in use. It is recommended that this rail be replaced with third class 85# rail in accordance with the attached sketch and estimate.**

Work to be done by company force under charge of **Superintendent**

Accounting to concentrate in the office of **Division Accountant**

Signature and Title: *[Signature]*

Superintendent

Checked and Entered  
President's Office



Date: **July 30th 1928**

APPROVED: *[Signature]*  
General Superintendent.

*[Signature]*  
Asst. Chief Engr. or Engr. Maint. of Way.

*[Signature]*  
General Manager.

*[Signature]*  
Mech. Supt., Supt. Telgh. or Signal Engr.

*[Signature]*  
Chief Engineer.

*[Signature]*  
For Comptroller.

*[Signature]*  
President

*[Signature]*  
Vice President.

Date of Final Approval: **JAN 20 1929**

COMPTROLLER'S RECORD OF NOTICE OF APPROVAL AND OF COMPLETION

Form No. 1345 issued

19 \_\_\_\_\_ Work begun

19 \_\_\_\_\_ Work finished

*Oct 26 1928*

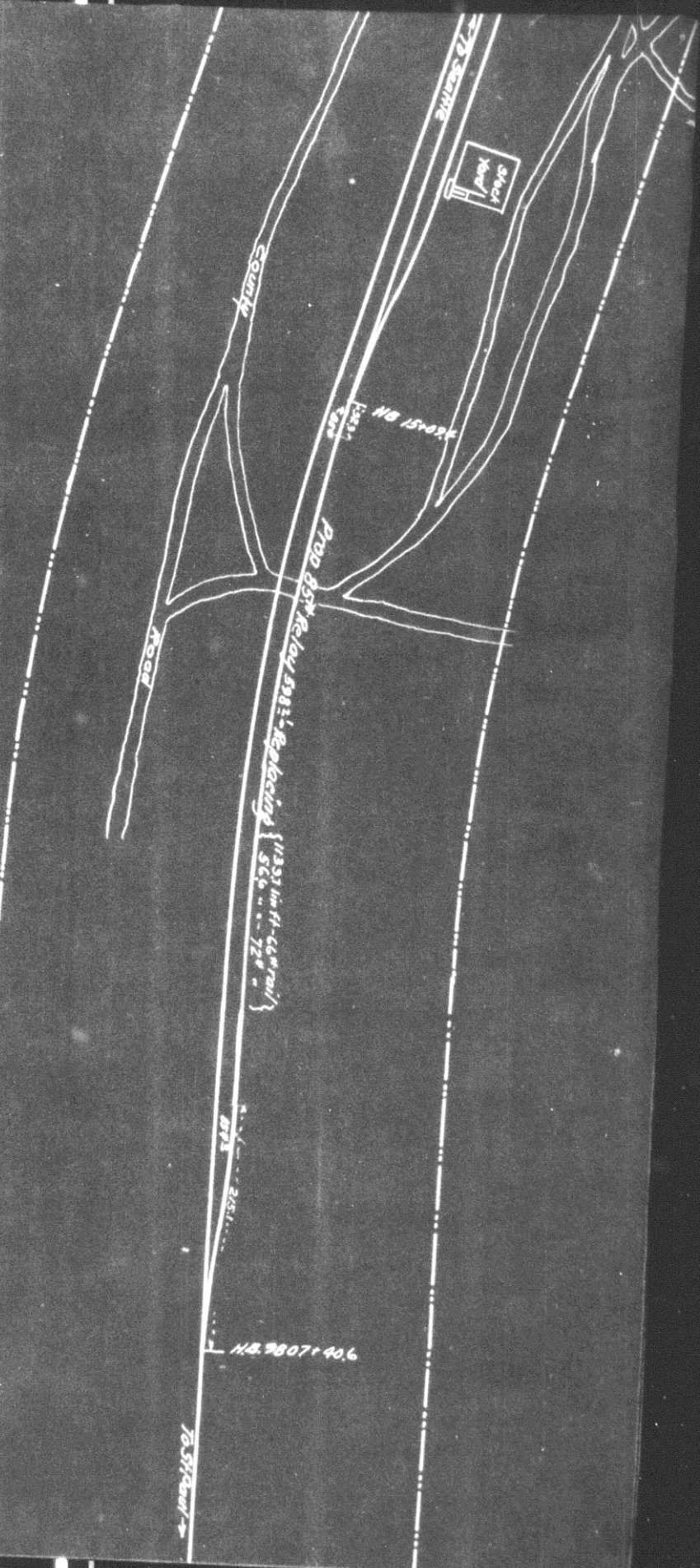

NASH  
 Pasco Div. 1st Dist.  
 Prop. Relay of East End Passing Track  
 at  
 HANTON WASH.  
 Scale 1/4" = 100'  
 Office Dist. Engr. Spokane 7-18-28  
 Kelvahan Sechar WASH. /  
 Prop. New Work HUS