



N. P. 1363
6-24

NORTHERN PACIFIC RAILWAY COMPANY
AUTHORITY FOR EXPENDITURE

1929
YEAR 1929

SUPERINTENDENT'S No. 65
No.

DEPT. No. 10-1929
ENGINEERING DEPT. No. 99-28

A. F. E. NO. 180

P A S C DIV. FIRST SUB-DIVN.

DISTRICT STATE WASH. VAL. SEC. No. 1
BRANCH

AUTHORITY IS REQUESTED FOR A NET EXPENDITURE OF \$560.

Accounting distribution as follows: (Distribution to be made in General Office.)

	Operating Expenses	Profit and Loss	Net Operating Expenses	Net Profit and Loss
Cost of property retired	411			
Value of salvage	335		76	
Incidental costs			278	
Total to Operating Expenses				354 ✓
Total to Profit and Loss				335 ✓
To Material and Supplies				
To Bills for Collection				
To Other Accounts				215 ✓
Net charge to investment account—Additions and Betterments				904 ✓
Total of distribution				19 ✓

COST AT CURRENT ADJUSTMENT
MADE IN

Budget reference: 89-1929
67-1928

Class of Work: No. 3 ✓

Joint facility contract reference: Non Joint.

The location is on this company's property. To secure rights, it will be necessary

Location: Lind, Washington

Title: Replace Light Rail in Westward Siding.

Reason: The present siding contains a small amount of 66# and 72# rail which is difficult to maintain under heavy power. It is recommended that this rail be replaced with third class 85# rail in accordance with the attached sketch and estimate.

Work to be done by company force under charge of Superintendent

Accounting to concentrate in the office of Division Accountant

Signature and Title: L. Newton Superintendent Date July 30th 1928

APPROVED: E. Cronin General Superintendent. Asst. Chief Engr. or Engr. Maint. of Way. General Manager.

Mech. Supt., Supt. Telgh. or Signal Engr.

Dennis Olson Chief Engineer. Vice President.

For Comptroller. Charles J. ... President. Date of Final Approval { JAN 29 1929

COMPTROLLER'S RECORD OF NOTICE OF APPROVAL AND OF COMPLETION

Form No. 1345 issued 19 Work begun 19 Work finished Oct. 27 1928



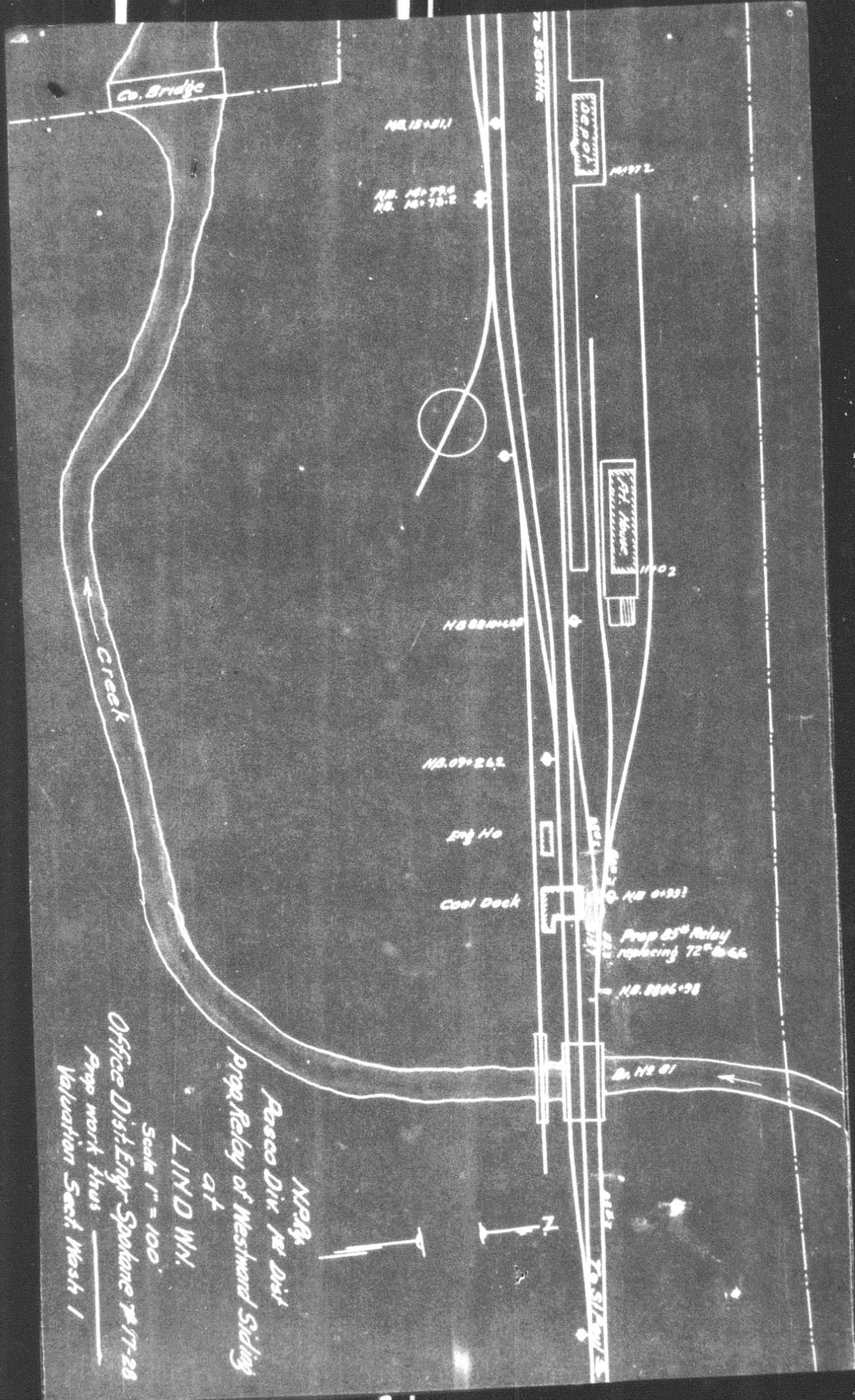

N.P.R.
 Assoc Dir. for Dist
 Prop. Relay of Westward Siding
 at
 LIND WH.
 Scale 1" = 100'
 Office Dist. Engr. Spokane #17-28
 Prop work thus
 Valuation Sect. Wash 1