



N. P. 1363
6-24

NORTHERN PACIFIC RAILWAY COMPANY

COMPTROLLER'S RECORD

1929

AUTHORITY FOR EXPENDITURE

1929

1929

YEAR 1929

SUPERINTENDENT'S No. 25
No.

DEPT. No. 14-29
ENGINEERING DEPT. No.

A. F. E. NO. 149

Rocky Mtn Div. Second DISTRICT STATE Montana VAL. SEC. No. 16

AUTHORITY IS REQUESTED FOR A NET EXPENDITURE OF \$ 1520

Accounting distribution as follows: (Distribution to be made in General Office.)

	Operating Expenses	Profit and Loss	Net Operating Expenses	Net Profit and Loss
Cost of property retired.....	\$	\$	\$	\$
Value of salvage				
Incidental costs				
Total to Operating Expenses				
Total to Profit and Loss				
To Material and Supplies				
To Bills for Collection				
To Other Accounts				
Net charge to investment account—Additions and Betterments				1520 ✓
Total of distribution				1520 ✓

Budget reference: Item No. 26

Class of Work: No. 1 ✓

Joint facility contract reference: Not Joint

The location is ----- on this company's property. To secure rights, it will be necessary

Location: 1 1/2 Miles West of Ross - Montana

Title Riprap MP 12 x 775 to MP 12 x 875

and

Reason: The 1928 fall bridge inspection disclosed the necessity for riprap to protect roadbed against Silver Bow Creek at the above location, as per estimate and blue print attached.

Work to be done by company force under charge of Superintendent

Checked and Entered
President's Office



Accounting to concentrate in the office of Superintendent

Signature and Title: J. C. Johnson Superintendent

Date Jan. 1st 1929

APPROVED: [Signature]	[Signature]	[Signature]
General Superintendent	Asst. Chief Engr. or Engr. in Charge of Work	General Manager
Mech. Supt., Supt. Telegraph or Signal Engr.		
[Signature]	[Signature]	[Signature]
Chief Engineer		Vice President
[Signature]	[Signature]	
For Comptroller	President	

Date of Final Approval: JAN 28 1929

COMPTROLLER'S RECORD OF NOTICE OF APPROVAL AND OF COMPLETION

Form No. 1366 issued 19..... Work begun 19..... Work finished March 27 1929

A&B
 Sloping 50 cu. yds.
 Handplaced 200 cu. yds.
 Ship 272 cu. yds.

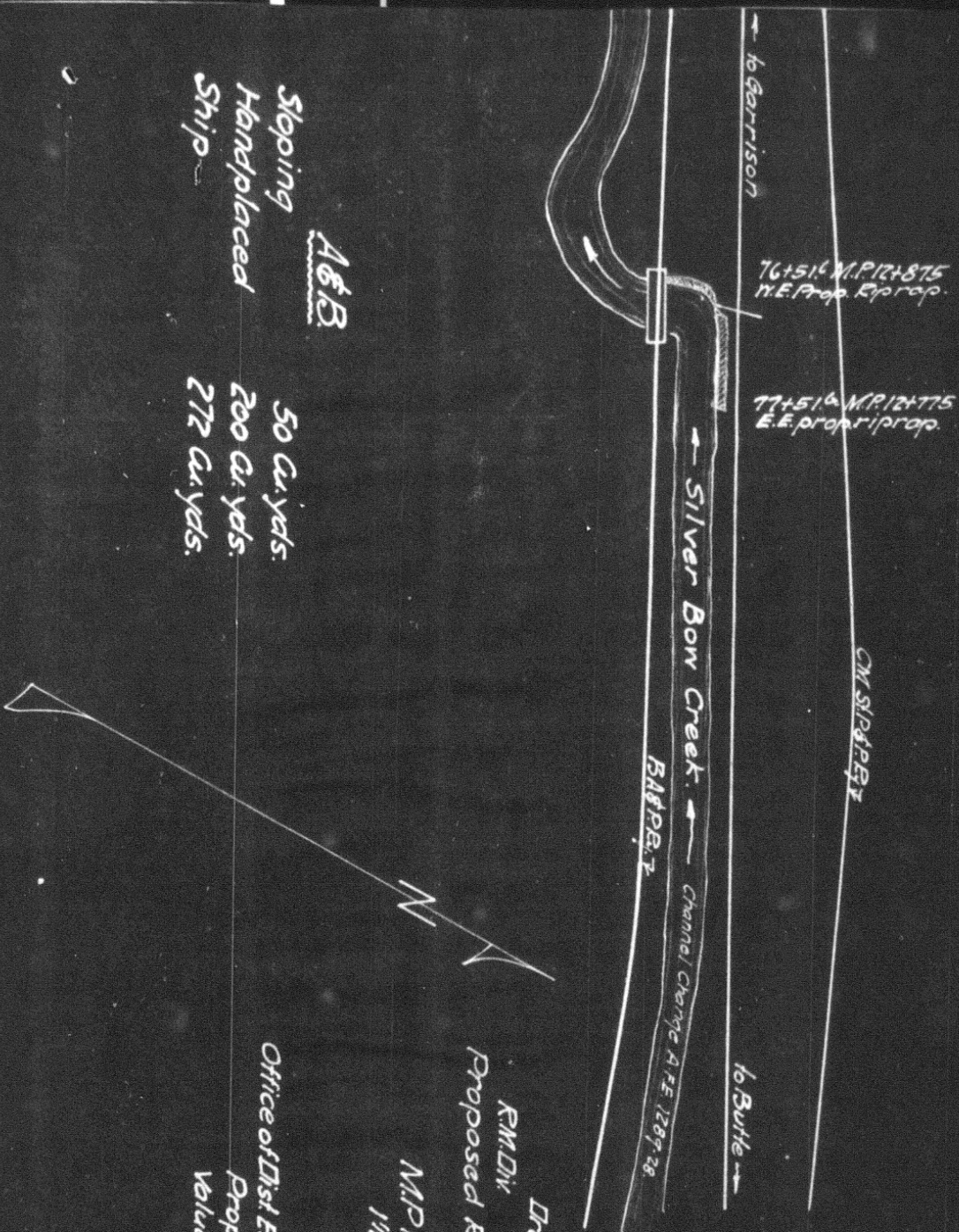

12
 9275802

N.P.R.
 Drawing No
 R.M. Div
 Proposed Riprap to Protect Roadbed
 between
 M.P. 12+775 and M.P. 12+875
 1/2 miles west of
 ROSS
 Scale: 1" = 100 ft.
 Office of Dist Engr. Livingston, Mont. Dec. 1st 1928
 Proposed New Work Shown
 Valuation Section Mont #16.
 1929 Budget Item.