



N. P. 1363
6-24

NORTHERN PACIFIC RAILWAY COMPANY AUTHORITY FOR EXPENDITURE

COMPTROLLER'S COPY

1929 1029
YEAR 1929
A. F. E. NO. **140**

SUPERINTENDENT'S NO.

M.F.C. No.

DEPT. No.

ENGINEERING DEPT. No. 21

Yellowstone Div. Third

DISTRICT ~~Branch~~ STATE **Montana** VAL. SEC. NO. 1

AUTHORITY IS REQUESTED FOR A NET EXPENDITURE OF \$ **7 340.**

Accounting distribution as follows: (Distribution to be made in General Office.)

	Operating Expenses	Profit and Loss	Net Operating Expenses	Net Profit and Loss
Cost of property retired	400.			
Value of salvage	30.		370.	
Incidental costs			530.	
Total to Operating Expenses				900 ✓
Total to Profit and Loss				30 ✓
To Material and Supplies				
To Bills for Collection				
To Other Accounts				
Net charge to investment account—Additions and Betterments				6 440 ✓
Total of distribution				7 370 ✓

Original Cost Adjustment
Made in 4-71-1930
Final

Budget reference: **Item 122-1929 Budget**

Class of Work: No. 4 ✓

Joint facility contract reference: **None**

The location is --- on this company's property. To secure rights, it will be necessary **to do nothing**

Location: **Near Hathaway, Montana, Bridge 104, Sweeney Creek.**

Title: **Reinforce I Beam Spans**

and

Reason: **The present structure consists of 4-30 foot I Beam Spans on concrete abutments and three cylinder piers. The spans are overloaded by Class Q5 power and do not permit the operation of Class "A" power.**

It is proposed to strengthen the spans by placing additional I Beams, making them good for E-65 loading.

Work to be done by company force under charge of **Division Superintendent**

Accounting to concentrate in the office of **Division Superintendent**

Signature and Title: *M. S. Clements* **Bridge Engineer** Date **Oct. 10, 1928**



APPROVED:			
General Superintendent.	Asst. Chief Engr. or Engr. Maint. of Way.		General Manager.
Mech. Supt., Supt. Telgh. or Signal Engr.			
<i>Bernard Blum</i> Chief Engineer		<i>[Signature]</i> Vice President	
<i>[Signature]</i> For Comptroller.	<i>Charles Donnelly</i> President	Date of Final Approval { JAN 28 1929 } 19	

COMPTROLLER'S RECORD OF NOTICE OF APPROVAL AND OF COMPLETION

Form No. 1345 issued. 19 Work begun. 19 Work finished *[Signature]* 1929

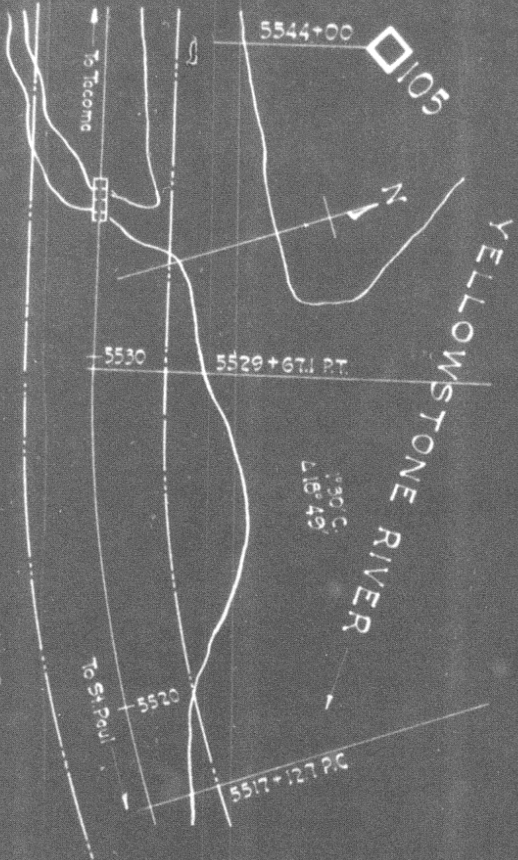

MAP
Scale: 1" = 400'

PROFILE
Horizontal: 1" = 400' Vertical: 1" = 20'

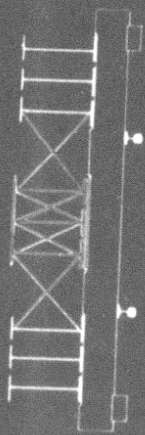
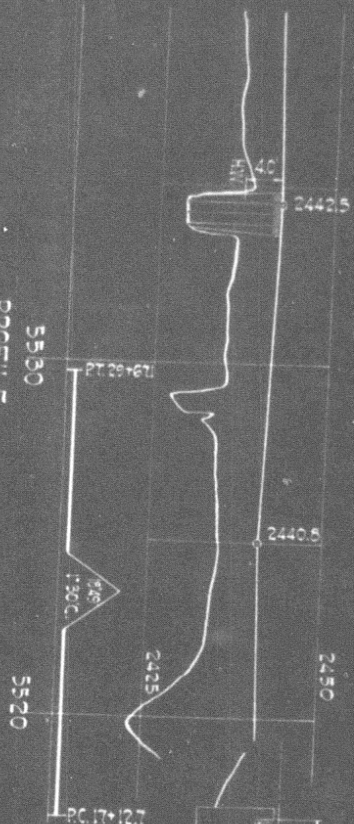

SECTION
Scale 1/2" = 1'-0'

Proposed new work shown in red

NORTHERN PACIFIC RAILWAY
YELLOWSTONE DIVISION THIRD SUBDIVISION
VALUATION SECTION, MONT.
BRIDGE 104 OVER SWEENEY CREEK
NEAR HATHAWAY, MONT.
PROPOSED REINFORCEMENT OF 30 FT. I-BEAM SPANS

Office of Bridge Engineer SA Paul, Minn. Oct. 23, 1925
Scales as Noted

JOPPA



BR. No 104
4 SP. I. B. 1206'

Bridge rebuilt as per Br. Engr's Plans # 63059 & # 172036
I-Beams added, seats remodeld etc.

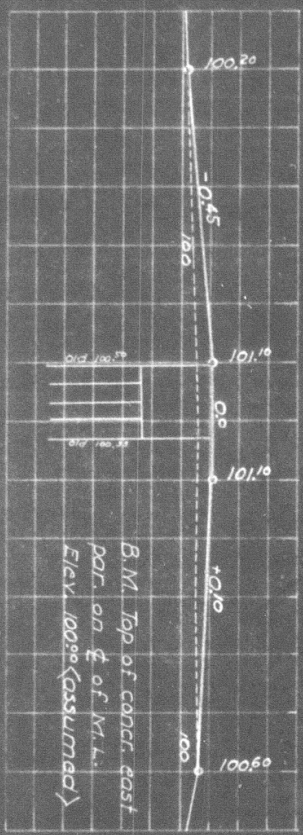

PROFILE
Scale: Hor. 1" = 200'
Ver. 1" = 4'

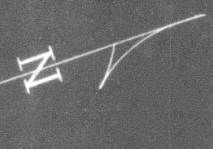

Office of Dist. Engr. Livingston, Jan. 30, 1930.
New work shown _____
Valuation Section Montana # 1
Auth. under Imp't 140-29 dated 1-28-29
Work begun November 1929
Work completed November 27, 1929

Hathaway

Reinforce I-Beam Spans - Bridge No 104
N.P. Ry. 3rd Dist.
Yell. Div. Naor

