



N. P. 1363  
6-24

COMPTROLLER'S COPY

# NORTHERN PACIFIC RAILWAY COMPANY AUTHORITY FOR EXPENDITURE

1929 1929  
YEAR 1929

SUPERINTENDENT'S NO.

M.F.C. NO.

DEPT. NO.

ENGINEERING DEPT. No. 2

A. F. E. NO. 138

Yellowstone

DIV.

Second

DISTRICT  
~~BRANCH~~

STATE No. Dak. VAL. SEC. No. 2

AUTHORITY IS REQUESTED FOR A NET EXPENDITURE OF \$ 8 620.

Accounting distribution as follows: (Distribution to be made in General Office.)

	Operating Expenses	Profit and Loss	Net Operating Expenses	Net Profit and Loss
Cost of property retired	1 270.			
Value of salvage	750.		520.	
Incidental costs			670.	
Total to Operating Expenses				1 190.
Total to Profit and Loss				
To Material and Supplies				750.
To Bills for Collection				
To Other Accounts				
Net charge to investment account—Additions and Betterments				7 430.
Total of distribution				9 370.

Original Cost 11/12/29  
Made in Road

Budget reference: Item 120- 1929 Budget

Class of Work: No. 4

Joint facility contract reference: None

The location is — — on this company's property. To secure rights, it will be necessary to do nothing

Location: Medora, North Dakota, Bridge 148, Sully Creek.

Title: Replace Girder Span with New Steel.

and

Reason: The present structure consists of one 45 foot Deck Plate Girder designed for 146 ton loading, on concrete abutments on the main track. A 71 foot pile trestle, built in 1905, is on the passing track. The steel is overloaded by the new experimental locomotive and requires a slow order. It is proposed to extend the concrete abutments, move the present girder to the passing track and place a new girder designed for E-65 loading on the main track.

Work to be done by Contract under charge of Engineering Dept  
Division Superintendent  
Accounting to concentrate in the office of Division Superintendent

Signature and Title: M.A. Clements Bridge Engineer Date Sept. 25, 1928

APPROVED:		
General Superintendent.	Asst. Chief Engr. or Engr. Maint. of Way.	General Manager.
Mech. Engr., Supt., Triph. or Signal Engr.		
<u>Benedict</u> Chief Engineer.		<u>[Signature]</u> Vice President.
<u>[Signature]</u> Pay Comptroller.	<u>Charles Hamelby</u> President	Date of Final Approval

COMPTROLLER'S RECORD OF NOTICE OF APPROVAL AND OF COMPLETION

Form No. 1345 issued 19 Work begun 19 Work finished 19

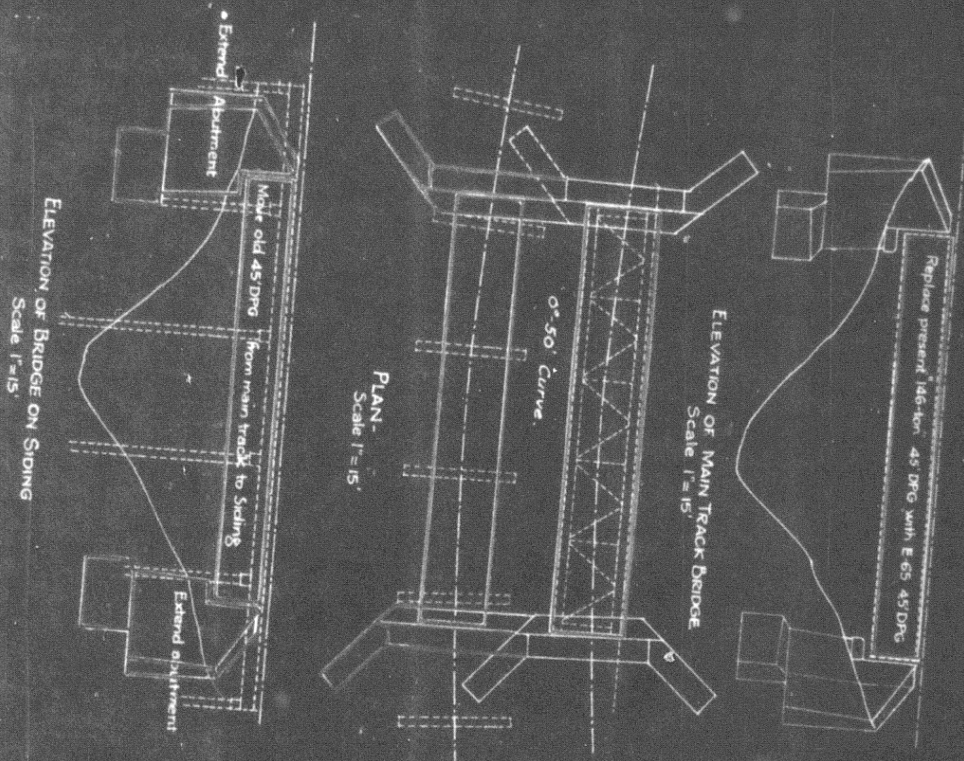

PLAN -  
Scale 1" = 15'

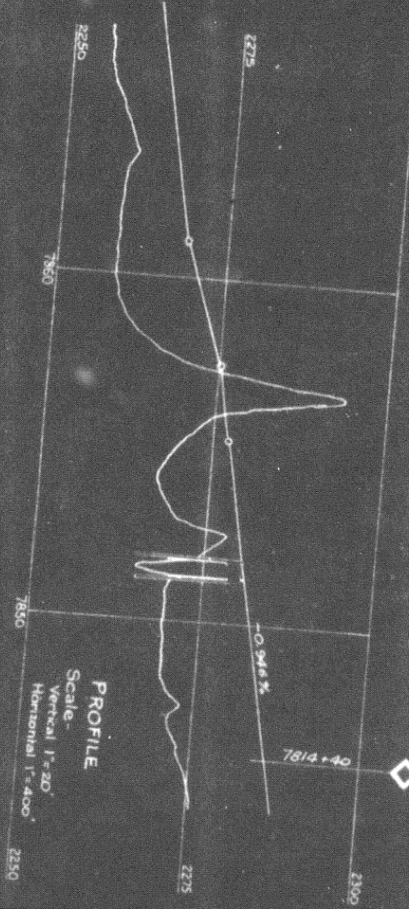
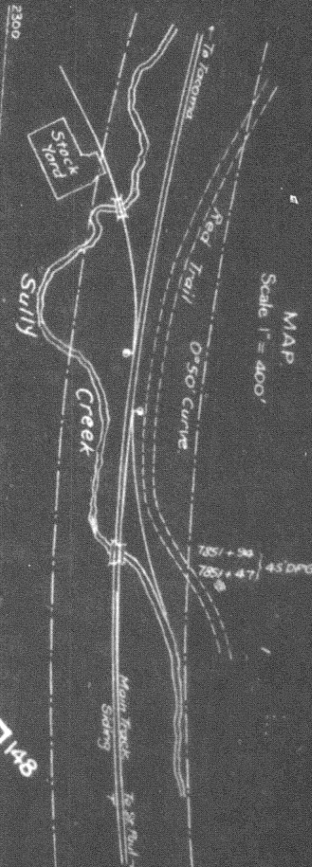

N.P.R.V.  
YELLOWSTONE DIVISION - SECOND SUBDIVISION.  
**MEDORA**  
BRIDGE 148 - SULLY CREEK.  
REPLACE GIRDER SPAN WITH NEW STEEL  
Scales as noted.  
Office of Bridge Engineers, St. Paul, Minn., Sept 25, 1928.  
Proposed New Work.  
Proposed Retirement.

VALUATION SECTION NORTH DAKOTA #2

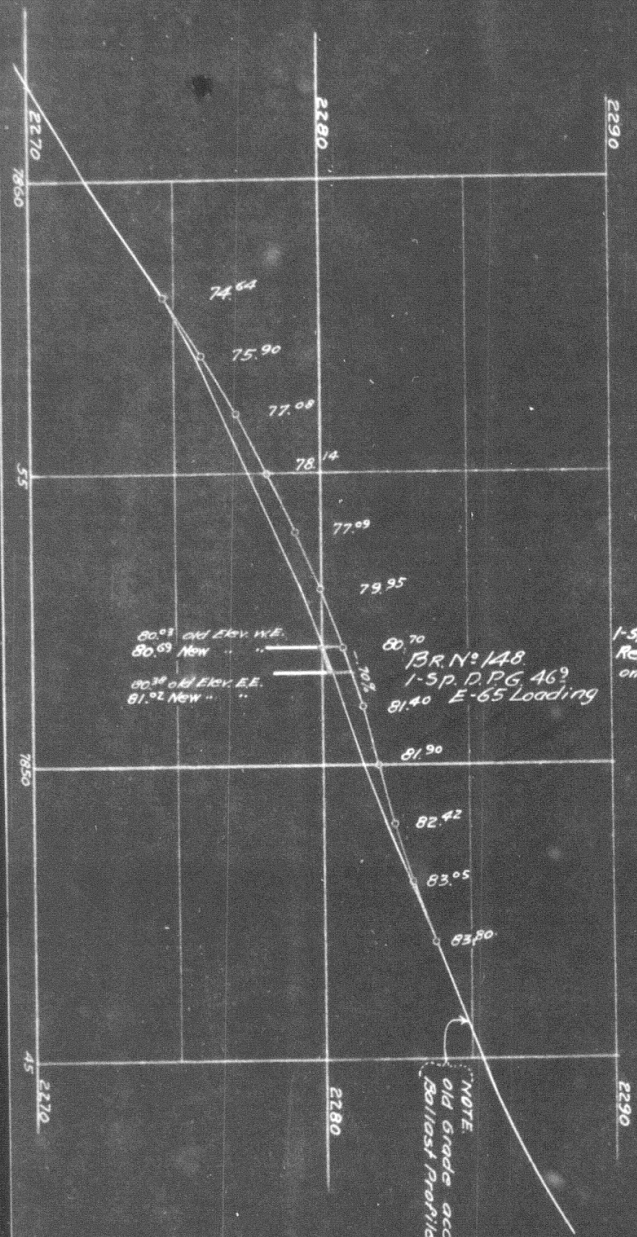

**BR. #148-A.**

1-5p. D.P.G. 46? Moved from ML.  
Reply. 5-5p. P.B. 69?  
on Passing Trk.

**BR. #148**

1-5p. D.P.G. 46? E-65 Loading Reply.  
1-5p. D.P.G. 46? Moved to Pas. Trk.  
8751+54 E.E. M.R. 148+374

0°50' C.  
21°50' A.

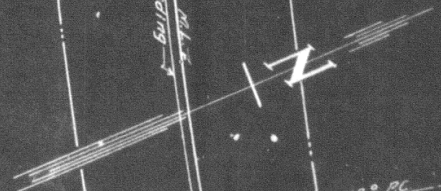

**NOTE:**  
For Detail: See Plans 52018 & 172030.  
Office of Dist. Engr. dated St. Paul, 12-18-29.

**NOTE:**  
Old grade according to  
Ballast Profile. SEE 535-26

Office of Dist. Engr. Livingston, Mont. Feb. 12-1930  
Val. Sec. North Dakota #12.  
Work under Imp'd. N° 138-29 dated 1-28-29.  
Work Begun April 1929.  
Work Completed Nov 11-1929.

N.P.R.Y. 2<sup>nd</sup> Dist  
Yell. Div.  
Replace Span Bridge 148  
Near  
**Medora**  
New Loc  
New Work Shown  
Scale: 1" = 200'

Removals