



N. P. 1363  
6-24

# NORTHERN PACIFIC RAILWAY COMPANY AUTHORITY FOR EXPENDITURE

COMPTROLLER'S OFFICE

1929 1928  
YEAR

SUPERINTENDENT'S No. 198  
No.

DEPT. No.  
ENGINEERING DEPT. No. 219-28

A. F. E. No. 128

Tacoma Div. Grays Harbor Line DISTRICT STATE Wash VAL. SEC. No. 28  
BRANCH

AUTHORITY IS REQUESTED FOR A NET EXPENDITURE OF \$ 509

Accounting distribution as follows: (Distribution to be made in General Office.)

	Operating Expenses	Profit and Loss	Net Operating Expenses	Net Profit and Loss
Cost of property retired				
Value of salvage				
Incidental costs				
Total to Operating Expenses				
Total to Profit and Loss				
To Material and Supplies				
To Bills for Collection				
To Other Accounts				
Net charge to investment account - Additions and Betterments				
Total of distribution				\$ 509 ✓

Original Cost Adjustment  
Made in APR 12 1929  
Final

Budget reference: **NOT IN BUDGET.**

Class of Work: No. 10 ✓

Joint facility contract reference: Non Joint

The location is Aberdeen on this company's property. To secure rights, it will be necessary to secure easement from owner for portion of track on their right of way.

Title: Cinder Track  
and: Track increase 177 ft.

Reason: In June 1926 a temporary cinder track was laid in Aberdeen used to set out empty cinder cars for loading. At the time the track was constructed, it was not the intention that the track should remain permanent - but it has been found that the using of this spur saved considerable money in the handling of cinders, and it is therefore recommended that the track be made permanent, and this REA is submitted for that purpose. Blue prints and estimates attached.

Estimated saving \$40.00 per month.

completed in June 1926

Work ~~to be done~~ by company force under charge of Superintendent

Accounting to concentrate in the office of Division Accountant

Signature and Title:

Checked and Entered  
Per. Office

Date Nov 23 19 28

APPROVED: <i>[Signature]</i> General Superintendent.	<i>[Signature]</i> Superintendent Asst. Chief Engr. or Engr. in Charge of Way.	<i>[Signature]</i> General Manager.
<i>[Signature]</i> Mech. Supt., Supt. Telegraph or Signal Engr.		
<i>[Signature]</i> Chief Engineer.		<i>[Signature]</i> Vice President.
<i>[Signature]</i> For Comptroller.	<i>[Signature]</i> Charles Sommers President.	Date of Final Approval { JAN 26 1929 } 19



COMPTROLLER'S RECORD OF NOTICE OF APPROVAL AND OF COMPLETION

Form No. 1345 issued. 19 Work begun 19 Work finished Jan. 11 1928

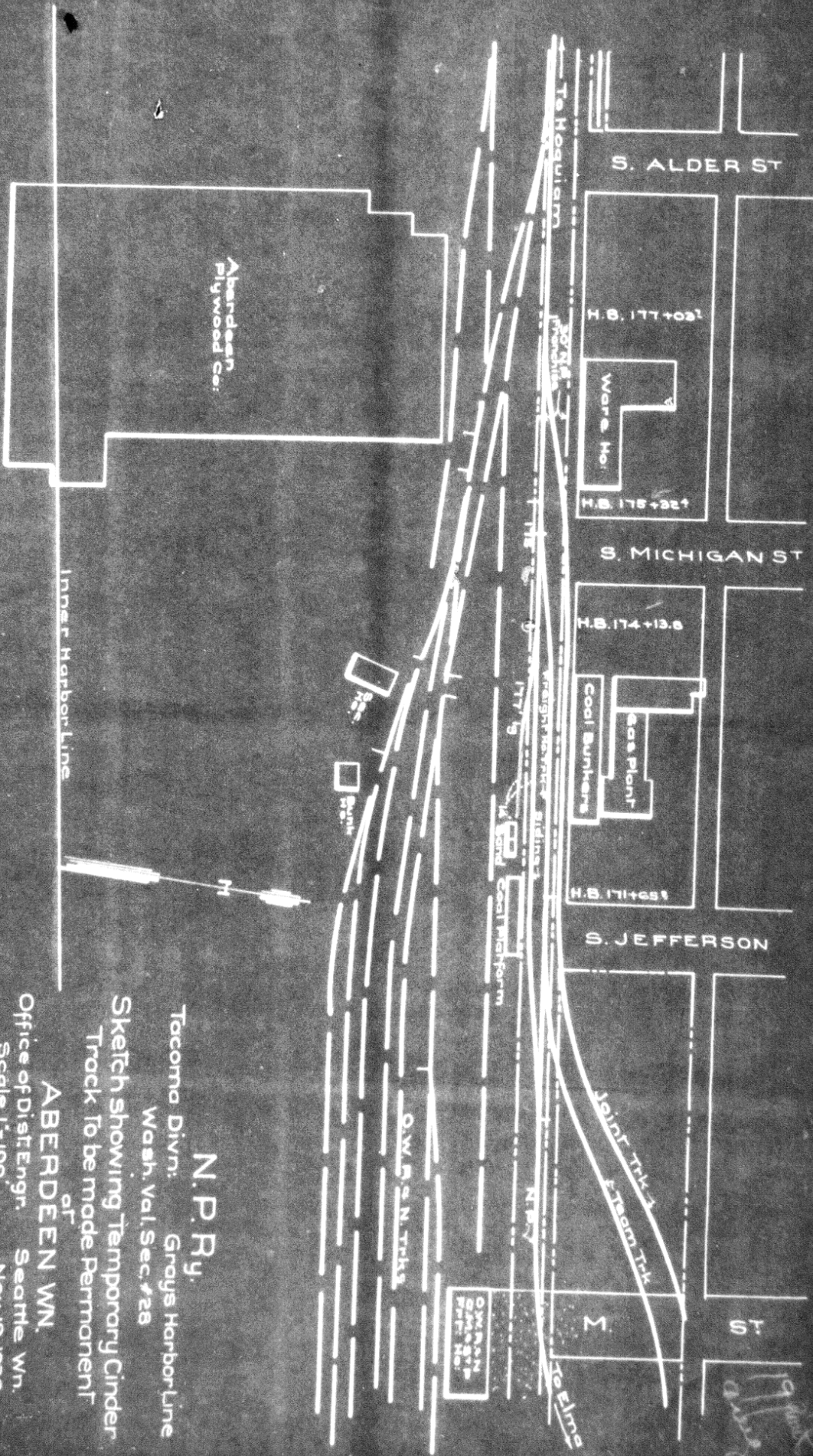

**N.P.Ry.**  
 Tacoma Divn: Grays Harbor Line  
 Wash. Val. Sec. #28  
 Sketch showing Temporary Cinder  
 Track to be made Permanent  
 at  
**ABERDEEN Wn.**  
 Office of Dist. Engr. Seattle Wn.  
 Nov. 19 1928  
 Scale 1"=100'