



N. P. 1363
6-24

NORTHERN PACIFIC RAILWAY COMPANY AUTHORITY FOR EXPENDITURE

COMPTROLLER'S COPY

SUPERINTENDENT'S NO.

M.F.C. NO.

Rocky
Mountain

Div.

Third

DEPT. NO.

ENGINEERING DEPT. NO. 3

DISTRICT
BRANCH

STATE Montana

VAL. SEC. NO. 19

A. F. E. NO.

115

1929
YEAR 1928

AUTHORITY IS REQUESTED FOR A NET EXPENDITURE OF \$ 1 750.

Accounting distribution as follows: (Distribution to be made in General Office.)

	Operating Expenses	Profit and Loss	Net Operating Expenses	Net Profit and Loss
Cost of property retired	\$ 140.			
Value of salvage	10.		130.	
Incidental costs			240.	
Total to Operating Expenses				\$ 370.
Total to Profit and Loss				
To Material and Supplies				10.
To Bills for Collection				
To Other Accounts				
Net charge to investment account—Additions and Betterments				1 380.
Total of distribution				\$ 1 760.

Original Cost Adjustment
Made in 2-13-1930
Final

Budget reference: Item 136-1929 Budget

Class of Work: No. 4

Joint facility contract reference: None

The location is on this company's property. To secure rights, it will be necessary to do nothing

Location: Near Frenchtown, Montana, Bridge 136, Mill Creek

Title Reinforce I Beam Span

and

Reason: The present structure consists of one 30 foot I Beam span on concrete masonry. It is too light for class Q5 power and will not permit the operation of Class "A" power. It is proposed to strengthen it by placing additional I Beams, making it good for E-85 loading.

Work to be done by company force under charge of Division Superintendent

Accounting to concentrate in the office of Division Superintendent

Checked and Entered
President's Office

Signature and Title: *M. B. Clements* Bridge Engineer

Date Oct. 10, 1928



APPROVED:		
General Superintendent.	Asst. Chief Engr. or Engr. Maint. of Way.	General Manager.
Mech. Supt., Supt. Telgh. or Signal Engr.		
<i>Bernard H. ...</i> Chief Engineer.	<i>Charles ...</i> President	<i>J. R. ...</i> Vice President.
<i>W. ...</i> For Comptroller.	<i>Charles ...</i> President	Date of Final Approval { JAN 20 1929 } 19

COMPTROLLER'S RECORD OF NOTICE OF APPROVAL AND OF COMPLETION

Form No. 1345 issued 19 Work begun 19 Work finished 7-11-29

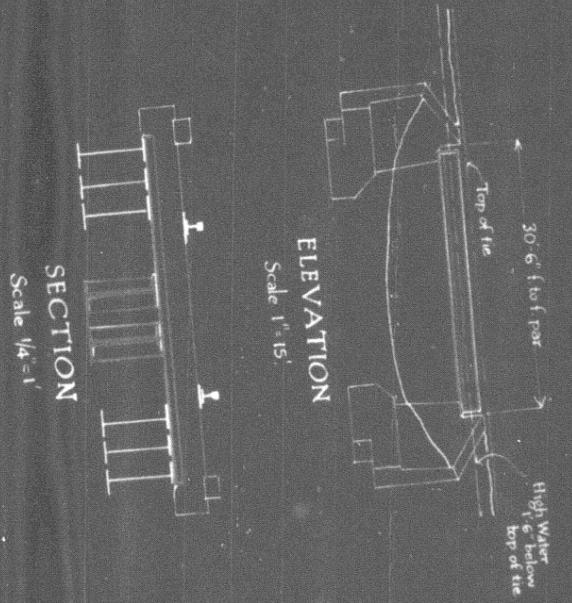
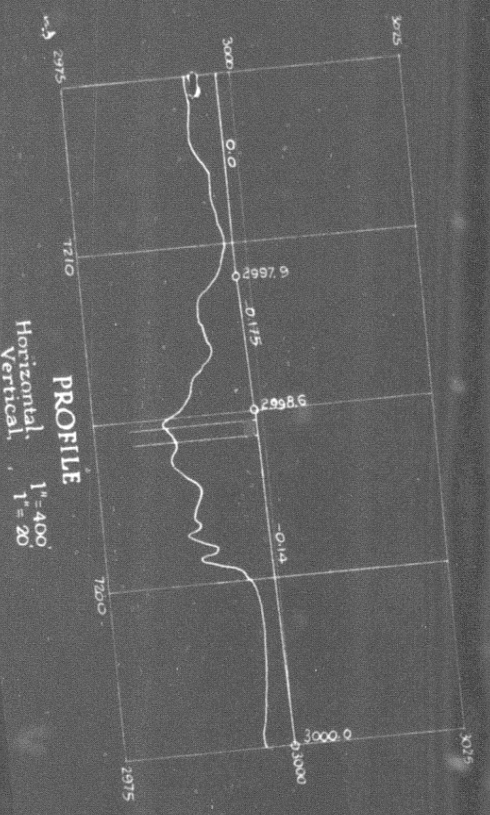
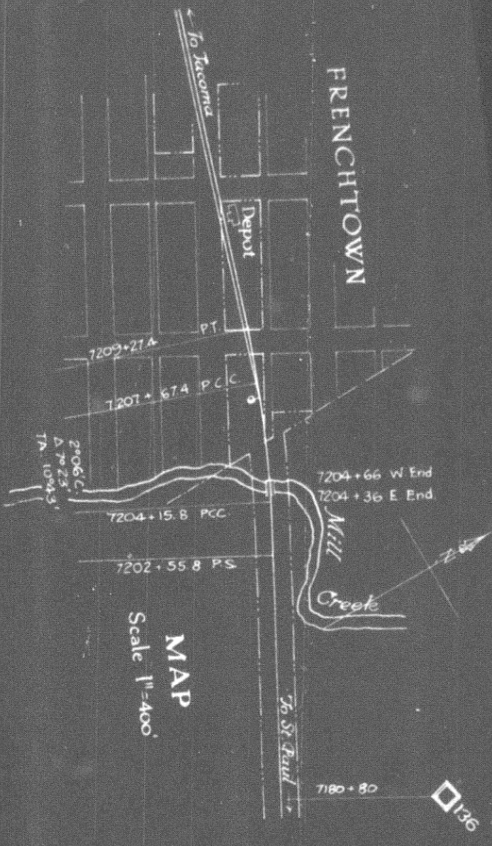

N. P. RY. THIRD SUBDIVISION
 ROCKY MOUNTAIN DIV. - FRENCHTOWN
 MILL CREEK.
 BRIDGE 136.
 REINFORCE I BEAM SPAN
 SCALAS AS NOTED
 Office of Bridge Engineer, Saint Paul, Minn., Oct. 10, 1928.
Proposed new work
Proposed reinforc
 VALUATION SECTION MONTANA NO. 19.

For details see Br Engrs plans # 63044 & # 172036

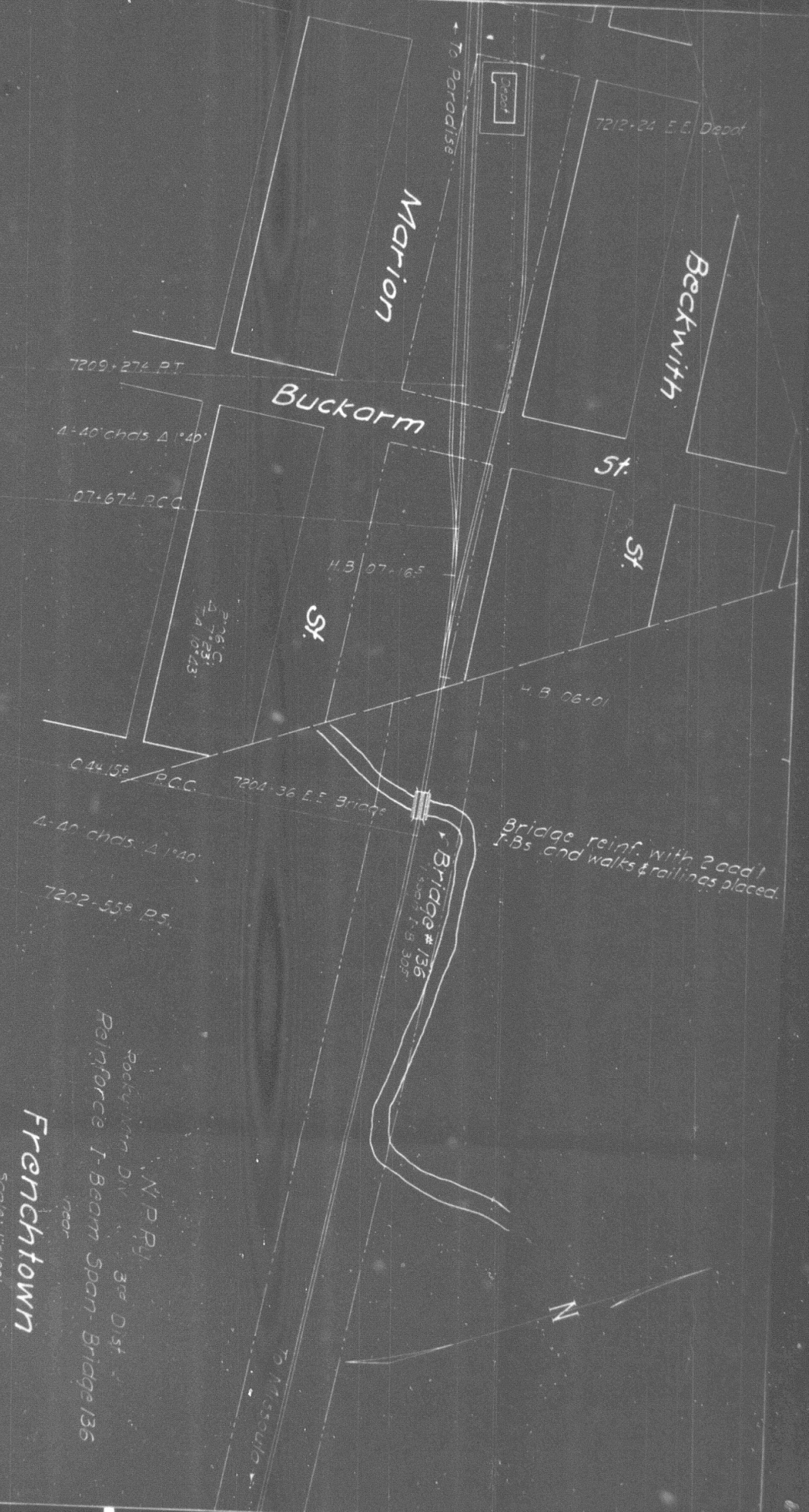

Frenchtown

Scale: 1"=100'

Office Dist Engr Livingston pct 23, 1929
New Work Shown

N.P.P. 3rd Dist
Reinforce I-Beam Span Bridge 136
near

Valuation Section Montana No 19
Auth. under Imp't 1/5-29, dated 1-26-29
Work begun December 1928
Work completed July 11, 1929