



N. P. 1363  
6-24

NORTHERN PACIFIC RAILWAY COMPANY  
AUTHORITY FOR EXPENDITURE

COMPTROLLER'S COPY

SUPERINTENDENT'S NO

M.F.C. NO

DEPT. NO

ENGINEERING DEPT. NO

YEAR 1928

A. F. E. NO 110

Yellowstone Div Third DISTRICT STATE Montana Val. Sec No 1

AUTHORITY IS REQUESTED FOR A NET EXPENDITURE OF \$ 1 220.

Accounting distribution as follows: (Distribution to be made in General Office.)

	Operating Expenses	Profit and Loss	Net Operating Expenses	Net Profit and Loss
Cost of property retired	140.			
Value of salvage	10.		130.	
Incidental costs			240.	
Total to Operating Expenses				\$ 370.
Total to Profit and Loss				10.
To Material and Supplies				
To Bills for Collection				
To Other Accounts				
Net charge to investment account—Additions and Betterments				850.
Total of distribution				\$1 230.

Budget reference Item 1928 Budget

Class of Work No. 4

Joint facility contract reference None

The location is on this company's property. To secure rights, it will be necessary to do nothing

Location: Near Horton, Montana, Bridge 94-1

Title: Reinforce I Beam Span

and

Reason: The present structure consists of 1-30 foot I Beam span on concrete abutments. The span is overloaded by class Q5 power and does not permit the operation of class "A" power. It is proposed to strengthen the spans by placing additional I Beams, making them good for 188 1/2 ton loading.

Work to be done by company force under charge of Division Superintendent

Accounting to concentrate in the office of Division Superintendent

Signature and Title: Bridge Engineer Oct. 11, 1928

APPROVED

General Superintendent

A. F. E. No. 110

General Manager

Mech. Supt. Supt. Telgr. or Signal Eng.

Chief Engineer

Vice President

For Comptroller

President

Date of Final Approval

COMPTROLLER'S RECORD OF NOTICE OF APPROVAL AND OF COMPLETION

Form No. 1345 issued

Work begun

Work finished

1103 28

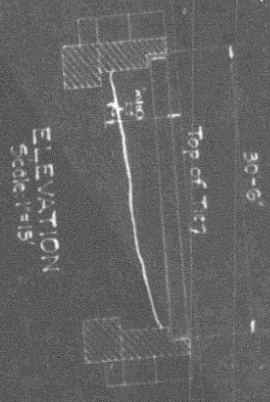
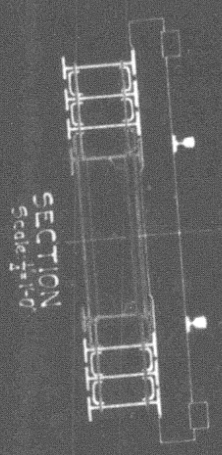
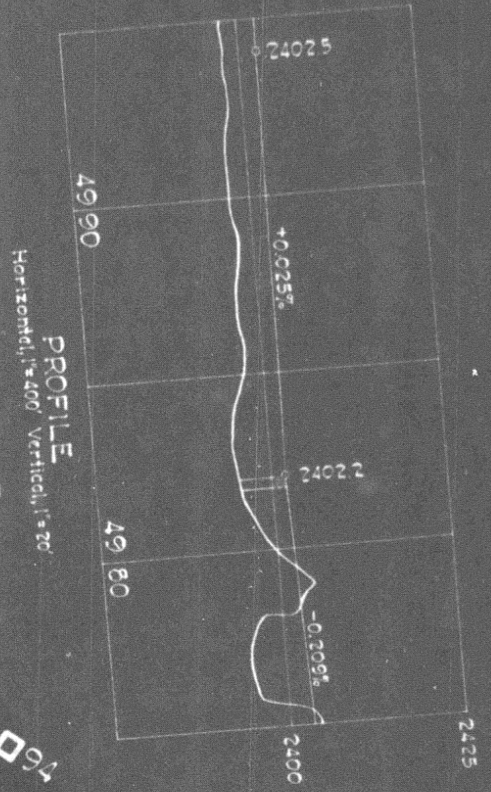
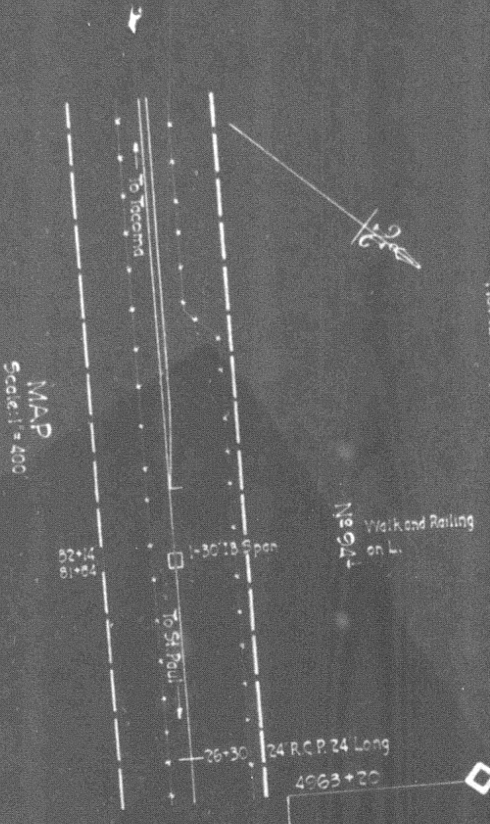

NORTHERN PACIFIC RAILWAY  
 YELLOWSTONE DIVISION THIRD SUBDIVISION  
 Junction Section Mont.  
 BRIDGE 941 NEAR HORTON, MONT.  
**PROPOSED REINFORCEMENT OF 30FT BEAM SPAN**  
 SCALES AS NOTED  
 Office of Bridge Engineer St. Paul, Minn. Oct. 26, 1938  
 Proposed new work shown in red

**CLERMONT**

To Forsyth

Brq. reinfd, raised, deck & walk removed.

Br. No 94.1

150' 18.305' walk on side (30'-17')

216+88.6 Br. 3

EE. 4981+84. NR. 94 + 106.7

00

20

4963+20

94

To Glendive

P.C.

4962+26.5 P.T.

39  
157.4.4  
37.849

4967+25.5 P.C.

NR. 94.2  
150' 18.306'  
(109'.291)

EE. 4966+76. NR. 94 + 356

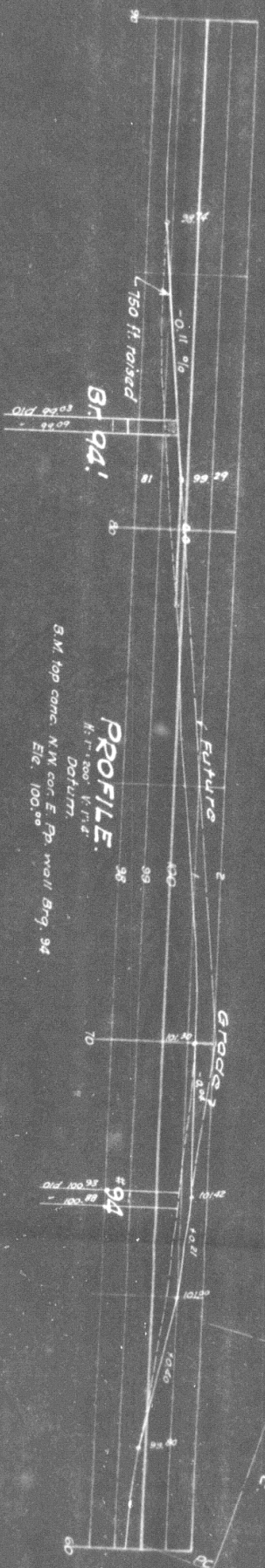

NOTE:

Brq. reinforced for E-65 loading per plan.  
For details see B.E. plan No 63063  
date 2.13.29, and No 172029 B.E. 0.15.28  
REV'd 12.14.28

Yell. Div. N.P. 24  
Reinforce I Beam Span -  
BRIDGE No 94.1  
HORTON

Office of Dist. Engineers,  
NEW WORK  
1" = 200'  
Livingston, N.P.  
Vol. Sec.  
Auth. under Imp'd 110-29  
Work begun  
Work completed.  
Mansona 1  
dated 126.29.  
October 1929.  
Dec. 5, 1929.