



N. P. 1363
6-24

NORTHERN PACIFIC RAILWAY COMPANY AUTHORITY FOR EXPENDITURE

COMPTROLLER'S COPY

SUPERINTENDENT'S NO.

M.F.C. No. **1929**

DEPT. No.

ENGINEERING DEPT. No. **16**

YEAR **1929**
A. F. E. NO. **109**

Yellowstone Div.

Third DISTRICT

BRANCH

STATE

Montana VAL. SEC. No. **1**

AUTHORITY IS REQUESTED FOR A NET EXPENDITURE OF \$ **1 220.**

Accounting distribution as follows: (Distribution to be made in General Office.)

	Operating Expenses	Profit and Loss	Net Operating Expenses	Net Profit and Loss
Cost of property retired	\$ 140.	\$		
Value of salvage	10.			
Incidental costs			130.	240.
Total to Operating Expenses				
Total to Profit and Loss				\$ 370. ✓
To Material and Supplies				10. ✓
To Bills for Collection				
To Other Accounts				
Net charge to investment account—Additions and Betterments				850. ✓
Total of distribution				\$ 1 230. ✓

Original Cost Adjustment
Made in **4-14-30**
[Signature]

Budget reference: **Item 1000 1929 Budget**

Class of Work: No. **4** ✓

Joint facility contract reference: **None**

The location is **---** on this company's property. To secure rights, it will be necessary **to do nothing**

Location: **Near Horton, Montana, Bridge 94**

Title: **Reinforce I Beam Span**

and

Reason: **The present structure consists of 1-30 foot I Beam Span on concrete abutments. The span is overloaded by class Q5 power and does not permit the operation of class "A" power. It is proposed to strengthen the spans by placing additional I Beams, making them good for 188 1/2 ton loading.**



Work to be done by ~~company force~~ **under charge of** **Division Superintendent**

Accounting to concentrate in the office of **Division Superintendent**

Checked and Entered President's Office

Signature and Title: *[Signature]* **Bridge Engineer**

Date **Oct. 11, 1928**

APPROVED:		
General Superintendent	Asst. Chief Engr. or Engr. Maint. of Way	General Manager
Mech. Supt., Supt. Telph. or Signal Engr.		
<i>[Signature]</i> Chief Engineer	<i>[Signature]</i>	Vice President
<i>[Signature]</i> Comptroller	<i>[Signature]</i> President	Date of Final Approval JAN 26 1929

COMPTROLLER'S RECORD OF NOTICE OF APPROVAL AND OF COMPLETION

Form No. 1345 issued

19 Work begun

19 Work finished

1928 4 29

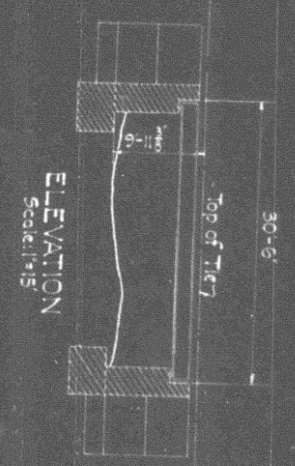
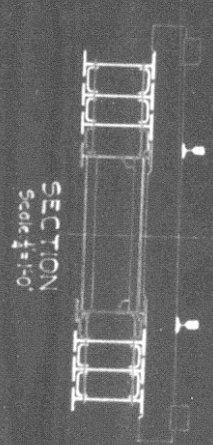
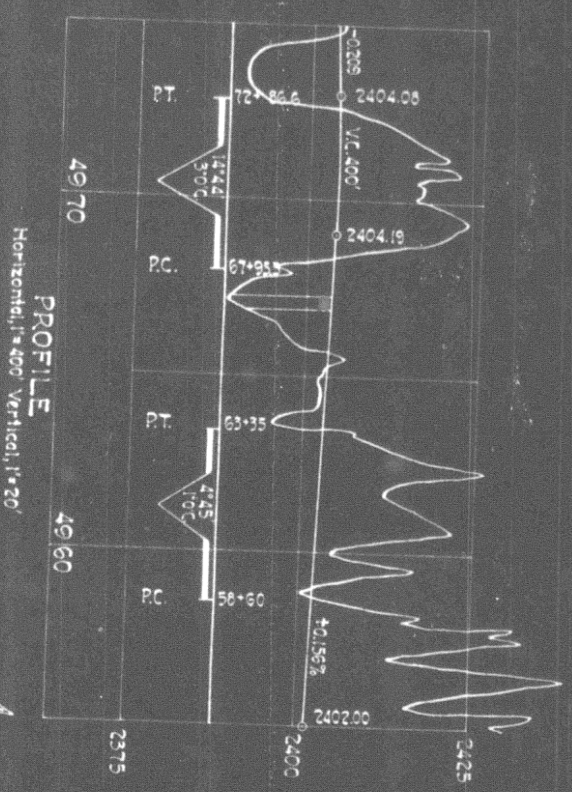
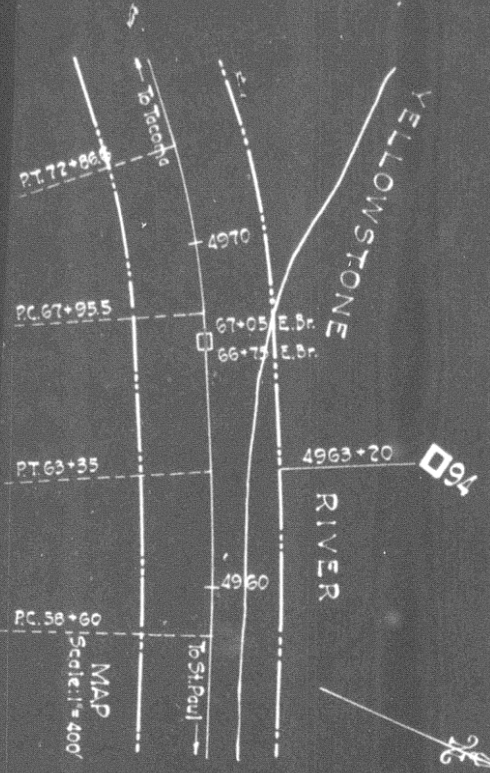

NORTHERN PACIFIC RAILWAY
YELLOWSTONE DIVISION THIRD SUBDIVISION
Validation Section Month 1
BRIDGE 94 NEAR HORTON, MONT.
PROPOSED REINFORCEMENT OF 30FT I BEAM SPAN
Scales as Noted
Office of Bridge Engineer St. Paul, Minn. Oct. 27, 1928
Proposed new work shown in red

CLERMONT.

TO Forsyth

Brq. 94.1
1500' 1/2" 305' with
work Non-sida (5m17)
(AFE 10-29)

E.H. 4963+91.2
E.E. 4961+84. NP 94+1862

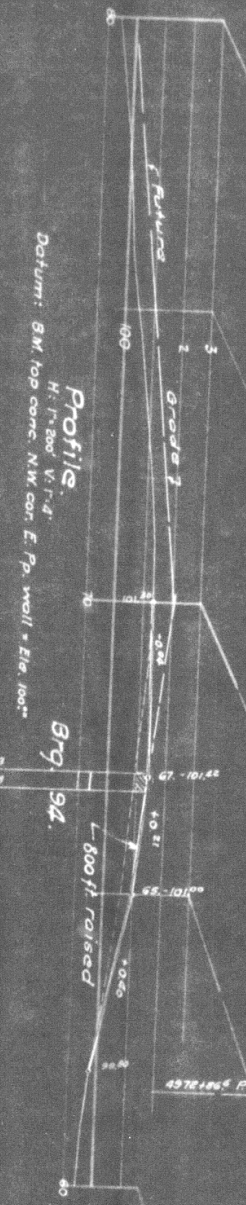

Brq. 94.

800 ft raised

4578+186 FT

30
12.424.
ST. 046.9

ESTABLISHED PC

Brq. 94
1500' 1/2" 305'
deck removed,
deck raised

E.E. 4966+74 NP 94+356

94

TO Glendive

100
02.1597

12.541957

NOTE.

Brq. reinforced for E-65 loading per plan.
For details see B.E. plan No 63062
of 2.7.29, and No 172029 B.E. 10.15.28
REV'D 12.14.28

Yell Div

N.P.Ry.

3rd Dist

Reinforce I Beam Span
Bridge No 94

HORTON

New Work

Office of Dist. Engineer, Livingston, Mont.

Vol. Sec.
Auth. under Imp't
Work begun

109-29

Montana
dated 1.26.29
October 1929
Dec. 4th 1929