



N. P. 1363
6-24

NORTHERN PACIFIC RAILWAY COMPANY
AUTHORITY FOR EXPENDITURE

COMPTROLLER'S COPY

YEAR 1929

SUPERINTENDENT'S No.
M.F.C. No.

DEPT. No.
ENGINEERING DEPT. No. 11

A. F. E. NO. 105

Yellowstone Div

Third

DISTRICT BRANCH STATE Montana VAL. SEC. No. 1

AUTHORITY IS REQUESTED FOR A NET EXPENDITURE OF \$ 4 970.

Accounting distribution as follows: (Distribution to be made in General Office.)

	Operating Expenses	Profit and Loss	Net Operating Expenses	Net Profit and Loss
Cost of property retired	300.			
Value of salvage	30.		270.	
Incidental costs			730.	
Total to Operating Expenses				\$ 1 000. ✓
Total to Profit and Loss				
To Material and Supplies				30. ✓
To Bills for Collection				
To Other Accounts				
Net charge to investment account—Additions and Betterments				3 970. ✓
Total of distribution				\$ 5 000. ✓

Budget reference: Item 122-1929 Budget

Class of Work: No. 4 ✓

Joint facility contract reference: None

The location is --- on this company's property. To secure rights, it will be necessary to do nothing

Location: Near Owens, Montana, Bridge 65

Title: Reinforce I Beam Spans

and

Reason: The present structure consists of 3-30 foot I Beam Spans on Concrete abutments and cylinder piers. The spans are overloaded by class Q5 power and do not permit the operation of Class "A" power. It is proposed to strengthen the spans by placing additional I Beams, making them good for 188½ ton loading.

Work to be done by company force under charge of Division Superintendent

Accounting to concentrate in the office of Division Superintendent

Signature and Title: *H.A. Gammeter* Bridge Engineer Date: Oct. 10, 1928

APPROVED:			
	General Superintendent	Asst. Chief Engr. or Engr. Maint. of Way	General Manager
	Mech. Supt., Supt. Telgr. or Signal Engr.		
	<i>Donald Wilson</i> Chief Engineer		<i>H.A. Gammeter</i> Vice President
	<i>W. J. ...</i> For Comptroller	<i>Charles ...</i> President	Date of Final Approval: Oct 17 1928

COMPTROLLER'S RECORD OF NOTICE OF APPROVAL AND OF COMPLETION

Form No. 1345 issued 19 Work begun 19 Work finished Oct 17 1928

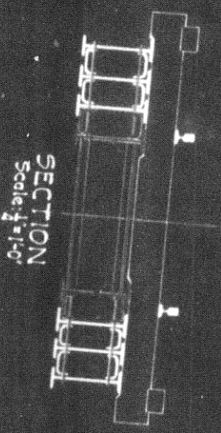
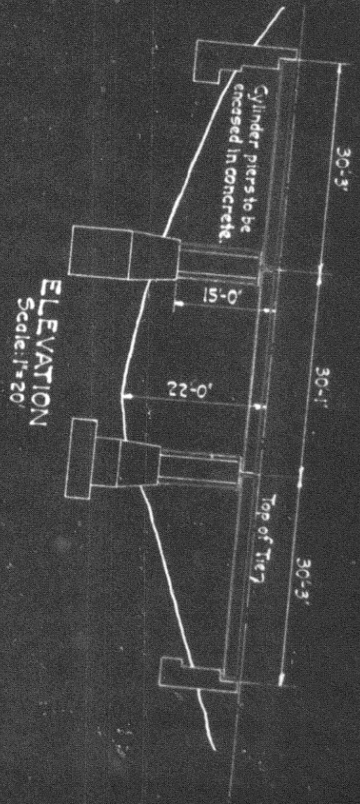
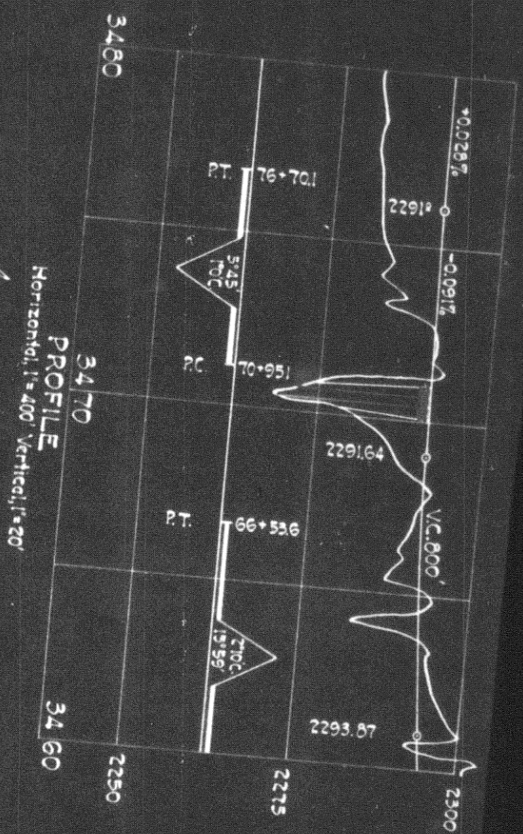
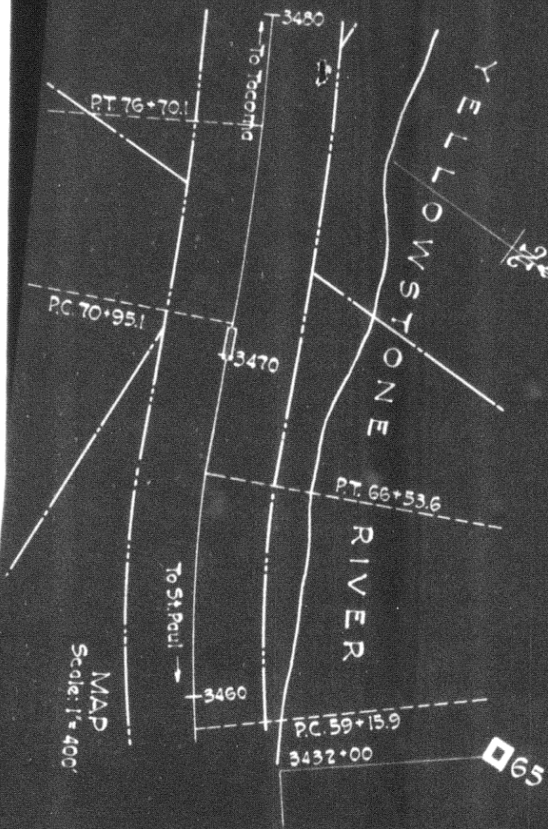

NORTHERN PACIFIC RAILWAY
YELLOWSTONE DIVISION THIRD SUBDIVISION
Validation Section Mont 1
BRIDGE 65 NEAR OWENS, MONT.
PROPOSED REINFORCEMENT OF 30 FT. I BEAM SPANS
SCALES AS NOTED
Office of Bridge Engineer St. Paul, Minn. Oct 30, 1926
Proposed new work shown in red

PROFILE
Scale: $1\text{ in} = 20\text{ ft}$
Ver. $1\text{ in} = 4\text{ ft}$

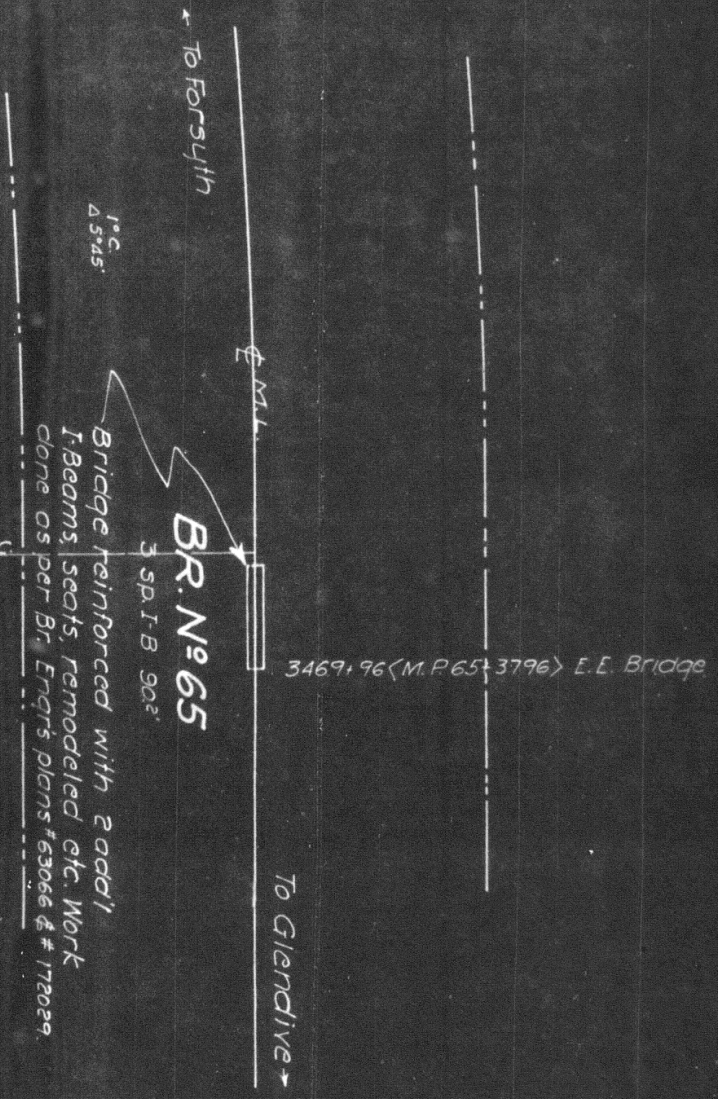
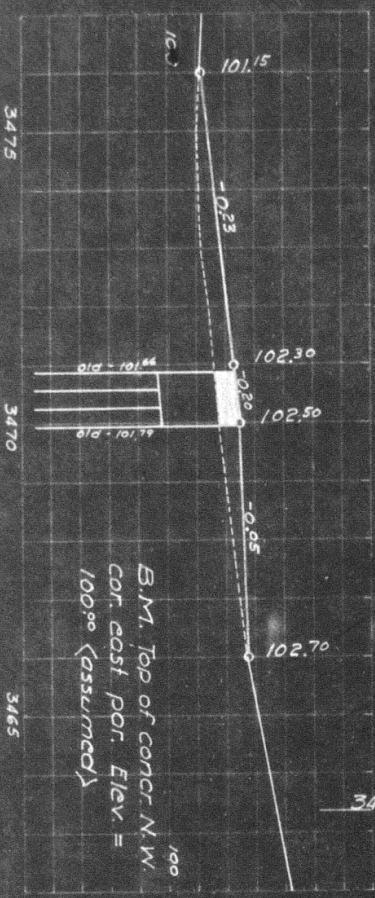

N.P. Ry. 3rd Dist.
Yell. Div.
Reinforce I-Beam spans - Bridge No 65

OWENS

Office of Dist. Engr. Livingston, Jan. 24, 1930
New work shown _____
Scale: $1\text{ in} = 100\text{ ft}$

Valuation Section
Auth. under Imp'l 105-29 dated 1-26-29
Work begun October 1929
Work completed October 17, 1929
Montana No 1