



N. P. 1363  
6-24

NORTHERN PACIFIC RAILWAY COMPANY  
AUTHORITY FOR EXPENDITURE

COMPTROLLER'S COPY

YEAR 1929

SUPERINTENDENT'S NO.  
M.F.C. No.

DEPT. No.  
ENGINEERING DEPT. No. H

A. F. E. NO. 104

Yellowstone Div Third DISTRICT STATE Montana VAL. SEC. No. 1

AUTHORITY IS REQUESTED FOR A NET EXPENDITURE OF \$ 1 220.

Accounting distribution as follows: (Distribution to be made in General Office.)

	Operating Expenses	Profit and Loss	Net Operating Expenses	Net Profit and Loss
Cost of property retired	140.			
Value of salvage	10.		130.	
Incidental costs			240.	
Total to Operating Expenses				\$ 370. ✓
Total to Profit and Loss				
To Material and Supplies				10. ✓
To Bills for Collection				
To Other Accounts				
Net charge to investment account—Additions and Betterments				850. ✓
Total of distribution				\$ 1 230. ✓

4-4  
7 total

31

Budget reference: Item -1929 Budget

Class of Work: No. 4 ✓

Joint facility contract reference: None

The location is --- on this company's property. To secure rights, it will be necessary to do nothing

Location: Near Shirley, Montana, Bridge 59

Title: Reinforce I Beam Span

and

Reason: The present structure consists of 1-30 foot I Beam Span on concrete abutments. The span is overloaded by Class Q5 power and does not permit the operation of Class "A" power. It is proposed to strengthen the spans by placing second hand I Beams from Bridge 13-1, Fargo Division, making the spans good for 188½ ton loading.



Work to be done by company force under charge of Division Superintendent

Accounting to concentrate in the office of Division Superintendent

Signature and Title: [Signature] Bridge Engineer Date Oct. 11, 1928

APPROVED:

General Superintendent: \_\_\_\_\_ Asst. Chief Engr. or Engr. Maint. of Way: \_\_\_\_\_ General Manager: \_\_\_\_\_

Mech. Supt., Supt. Telgr. or Signal Engr.: \_\_\_\_\_

Chief Engineer: [Signature] Vice President: [Signature]

For Comptroller: [Signature] Date of Final Approval: \_\_\_\_\_ 1928

COMPTROLLER'S RECORD OF NOTICE OF APPROVAL AND OF COMPLETION

Form No. 1345 issued 19... Work begun 19... Work finished 1929

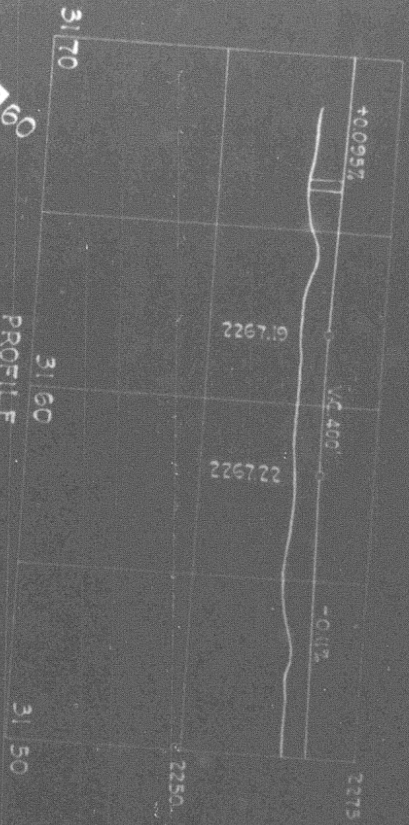

PROFILE  
Horizontal, 1"=400' Vertical, 1"=20'

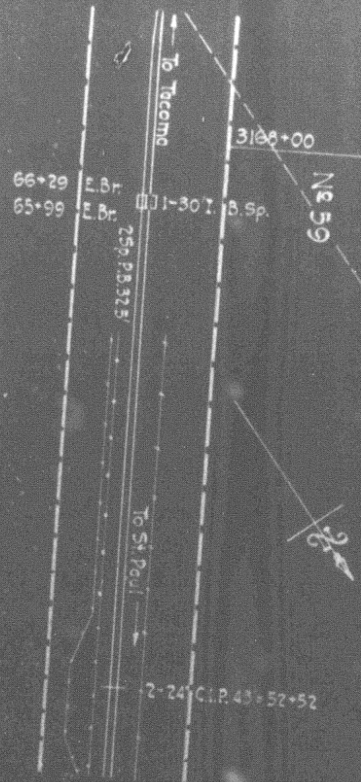

MAP  
Scale: 1"=400'



ELEVATION  
Scale: 1"=10'

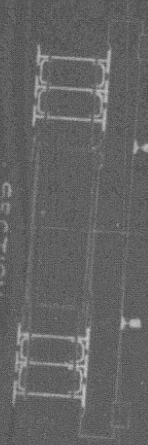

SECTION  
Scale: 1"=10'

NORTHEM PACIFIC RAILWAY  
YELLOWSTONE DIVISION - THIRD SUBDIVISION  
Situation: Section Mont 1  
BRIDGE 59 NEAR SHIRLEY MONT.  
PROPOSED REINFORCEMENT OF 30FT I-BEAM SPAN

Office of Bridge Engineers - St. Paul, Minn., Oct. 30, 1928  
Proposed new work shown in red  
Scale: AS NOTED

# SHIRLEY



H. B. 3172+75°

To Forsyth

3170

3168+00

3165

**BR. No 59**  
1 Sp. I. B. 304

3166+05 (M. P. 59+5085) E.E. Br.

To Glendive

Bridge reinforced with 2 add'l I-Beams, seats remodeled etc. Work done as per Br. Engr's plans #53060 & #112029.

BR. No 59-A  
2 Sp. R. B. 325

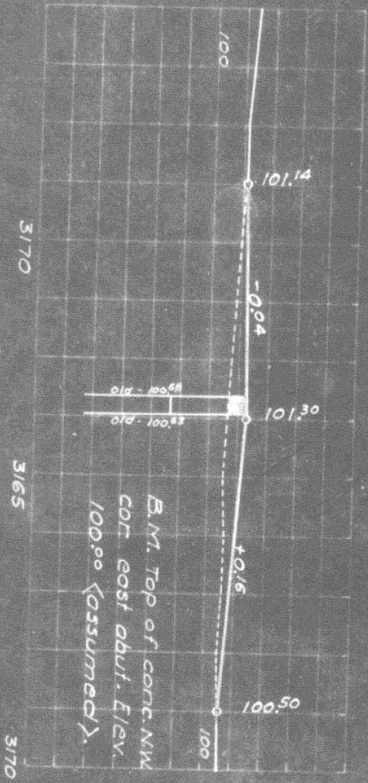

**PROFILE**  
Scale: Hor. 1"=20'  
Ver. 1"=2'

Valuation Section Montana No 1  
Auth. under Imp'd 104-29 dated 1-25-29  
Work begun September 1929  
Work completed October 7, 1929

Office Dist Engr Livingston, Jan 24, 1930.  
New work shown \_\_\_\_\_  
**SHIRLEY**  
Scale: 1"=100'

Yell. Div. N.P.Ry. 3rd Dist  
Reinforce I-Beam Span. Bridge No 59  
near