



N. P. 1363
6-24

NORTHERN PACIFIC RAILWAY COMPANY AUTHORITY FOR EXPENDITURE

COMPTROLLER'S COPY

YEAR **1929**

SUPERINTENDENT'S NO.
M.F.C. No.

DEPT. NO.
ENGINEERING DEPT. NO. **77**

A. F. E. NO. **103**

Yellowstone Div **Third** DISTRICT STATE **Montana** VAL. SEC. NO. **1**

AUTHORITY IS REQUESTED FOR A NET EXPENDITURE OF \$ **2 960.**

Accounting distribution as follows: (Distribution to be made in General Office.)

	Operating Expenses	Profit and Loss	Net Operating Expenses	Net Profit and Loss
Cost of property retired	280.			
Value of salvage	20.		260.	
Incidental costs			330.	
Total to Operating Expenses				\$ 590.
Total to Profit and Loss				
To Material and Supplies				20.
To Bills for Collection				
To Other Accounts				
Net charge to investment account—Additions and Betterments				2 370.
Total of distribution				2 980.

4-4 final

Budget reference: **Item 1929 Budget**

Class of Works No. **4**

Joint facility contract reference: **None**

The location is **---** on this company's property. To secure rights, it will be necessary **to do nothing**

Location: **Near Benz, Montana, Bridge 56**

Title: **Reinforce I Beam Spans**

and

Reason: **The present structure consists of 2-30 foot I Beam Spans on concrete masonry. The spans are overloaded by class Q5 power and do not permit the operation of class "A" power. It is proposed to strengthen the spans by placing additional I Beams, making them good for E-65 loading.**

Work to be done by **company force** under charge of **Division Superintendent**

Accounting to concentrate in the office of **Division Superintendent**

Signature and Title: *[Signature]* **Bridge Engineer**

Date **Oct. 11, 28**

APPROVED:			
	General Superintendent	Asst. Chief Engr. or Engr. Maint. of Way	General Manager
	Mech. Supt. Supt. Trough or Signal Engr.		
	<i>[Signature]</i> Chief Engineer		Vice President
	<i>[Signature]</i> For Comptroller	<i>[Signature]</i> President	Date of Final Approval

COMPTROLLER'S RECORD OF NOTICE OF APPROVAL AND OF COMPLETION

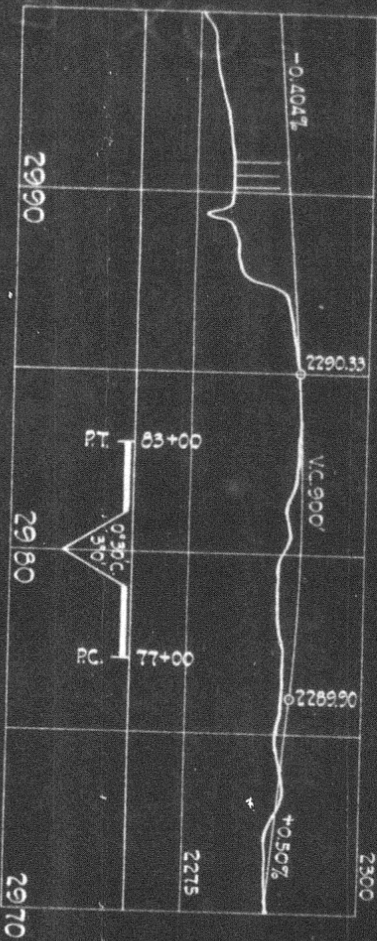

PROFILE
Horizontal, 1"=400' Vertical, 1"=20'

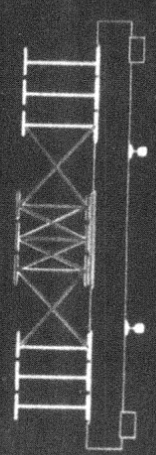
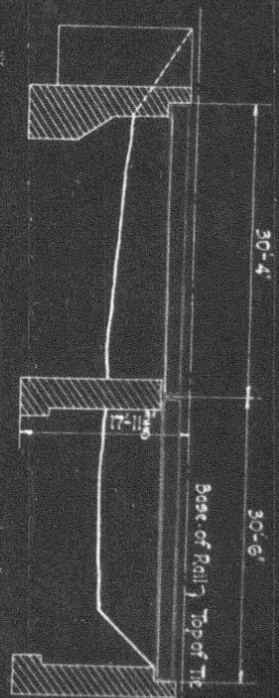
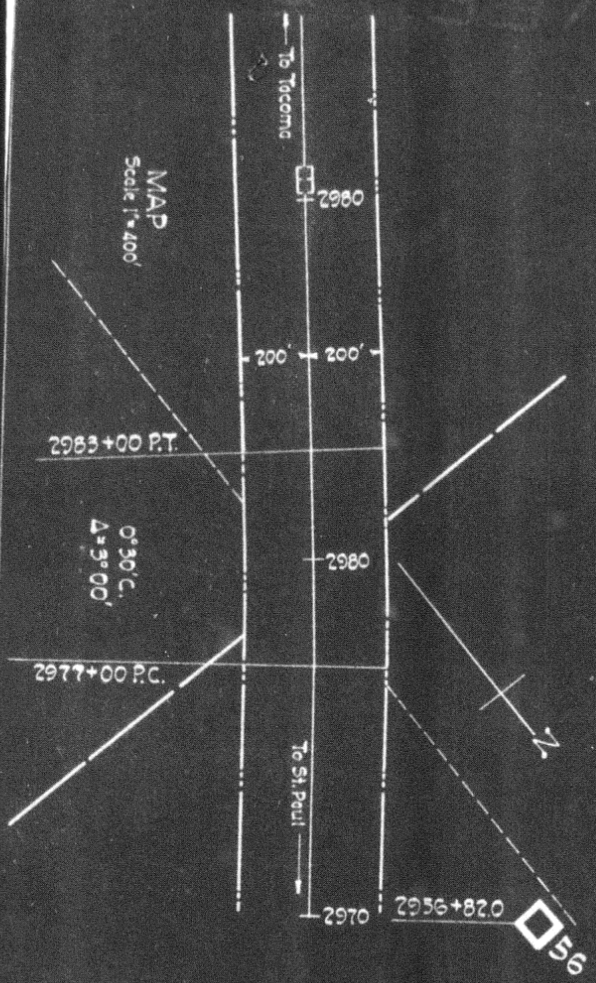

NORTHERN PACIFIC RAILWAY
YELLOWSTONE DIVISION THIRD SUBDIVISION
Validation Section Mont.
BRIDGE 56 NEAR BENZ, MONTANA
PROPOSED REINFORCEMENT OF 30 FT BEAM SPANS

Scales as Noted
Office of Bridge Engineer St. Paul, Minn. Oct. 25, 1928
Proposed new work shown in red

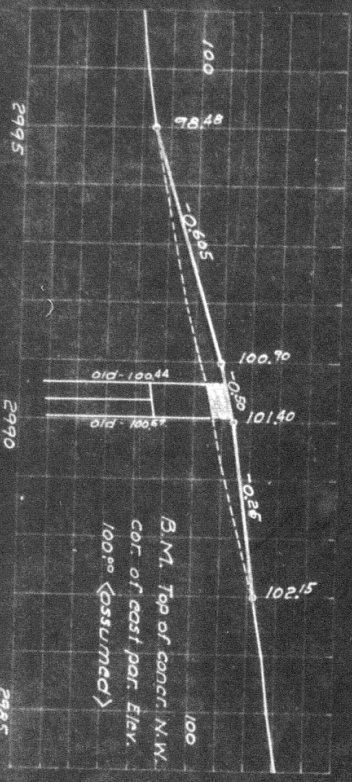

PROFILE
 Scale: Hor. 1" = 500'
 Ver. 1" = 4'

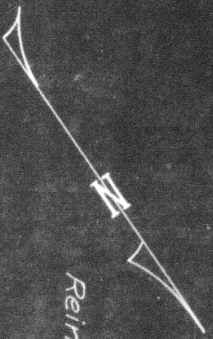

Yell. Div. N.P.R.Y.
 Reinforce I-Beam spans - Bridge No 56
 near 3rd Dist.

BENZ

Office of District Engr. Livingston, Mont. Jan 21, 1929.
 New work shown

Valuation Section Montana No 7
 Auth. under Imp't 103-29 dated 1-26-29
 Work begun September 1929
 Work completed September 27, 1929

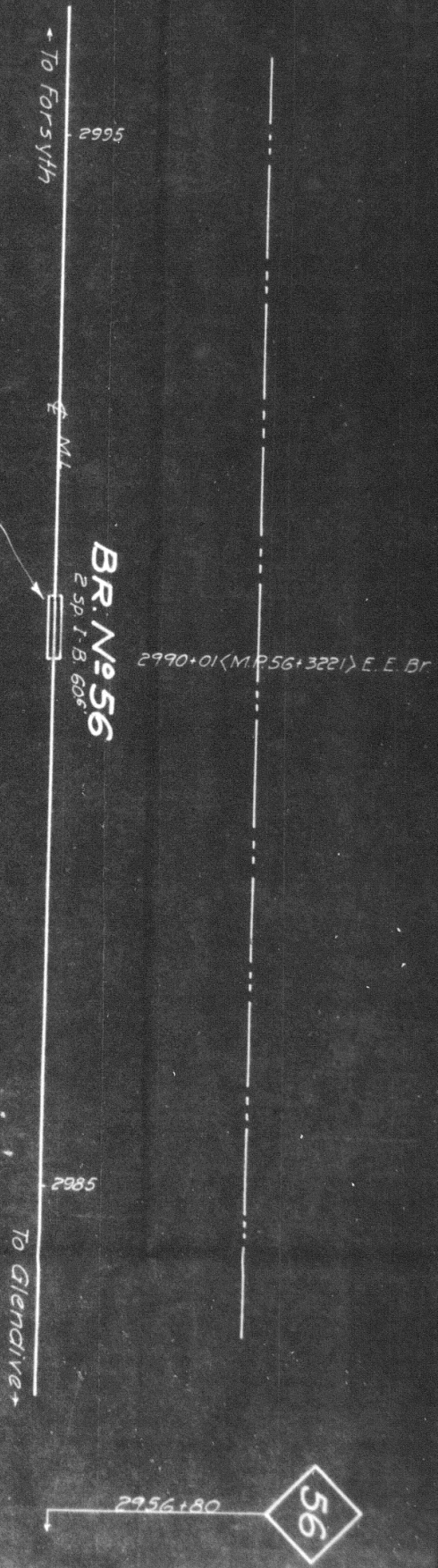

Bridge reinforced with 2 000# I Beams, seals remodeled etc. Work done as per Br. Engr's plans #63057 & #172036.

56