



N. P. 1363  
6-24

1928 1028  
NORTHERN PACIFIC RAILWAY COMPANY  
AUTHORITY FOR EXPENDITURE

COMPTROLLER'S COPY

1928  
YEAR 1927

SUPERINTENDENT'S No. 157

DEPT. No.

A. F. E. NO. 21

ENGINEERING DEPT. No. 176

Montana

Div.

Second

DISTRICT  
BOZEMAN

STATE

Montana

VAL. SEC. No. 3

AUTHORITY IS REQUESTED FOR A NET EXPENDITURE OF \$ 150.00

Accounting distribution as follows: (Distribution to be made in General Office.)

	Operating Expenses	Profit and Loss	Net Operating Expenses	Net Profit and Loss
Cost of property retired				
Value of salvage				
Incidental costs				
Total to Operating Expenses				
Total to Profit and Loss				
To Material and Supplies				
To Bills for Collection				
To Other Accounts				150
Net charge to investment account—Additions and Betterments				\$150
Total of distribution				

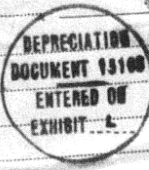

Budget reference: Not in budget

Joint facility contract reference: ~~Not Joint~~ with Am. Ry. Express Co., General Contract, effective 3/1-1923

The location is \_\_\_\_\_ on this company's property. To secure rights, it will be necessary

Location: Bozeman, Montana.

Title Partition in Express Office.

and

Reason:

This AFE is submitted to cover the expense of constructing a partition in the express room of the Bozeman passenger station. This partition was constructed at the request of the American Railway Express Company in order that valuable express shipments could be placed under lock and key at all times. The cost of the partition should be added to the valuation of the quarters on which the American Railway Express Company pays rental.

It is therefore recommended that the work be done as per attached blue print and estimate.

Work completed October 31st, 1927.

COMPLETED

Work to be done by company force under charge of Superintendent.

Checked and Entered

Accounting to concentrate in the office of Superintendent.

Signature and Title:

Superintendent

Date Nov. 21st 27

APPROVED:

General Superintendent

Asst. Chief Engr. or Engr. Maint. of Way

General Manager

Mech. Supt., Telg. or Signal Engr.

Chief Engineer

Vice President

For Comptroller

Date of Final Approval

JAN 4 1928

COMPTROLLER'S RECORD OF NOTICE OF APPROVAL AND OF COMPLETION

Form No. 1345 issued

19 Work begun

19 Work finished

Oct. 31 1927

Plan  
Scale: 1/8" = 1'

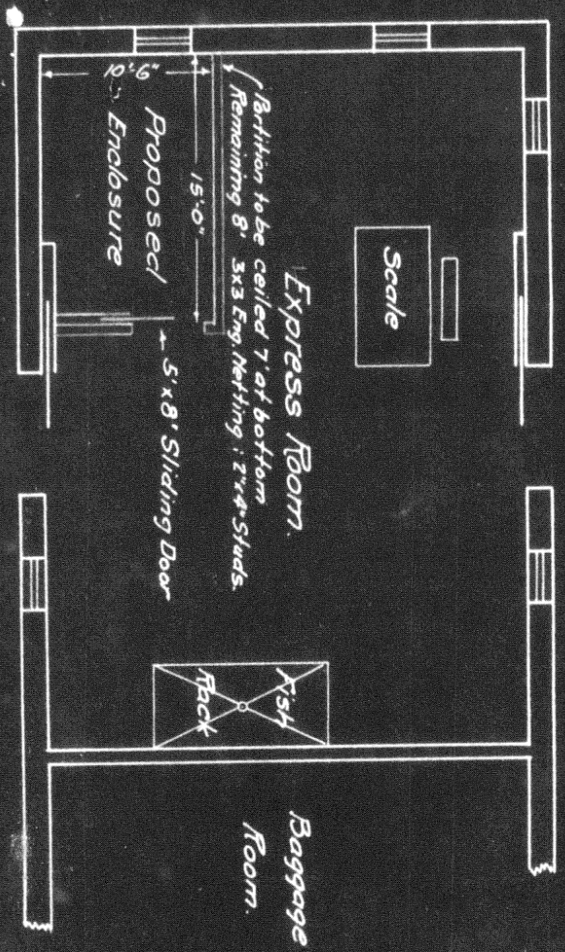

Proposed Enclosure

7414+41 3/4 E.E. Depot

N.P.R.  
Drawing No.

Mont. Div.

Eng. Dist.

Proposed Partition Installed  
in the Express Office for the  
American Railway Express Co.

at  
Bozeman

Scale: 1/4" = 100'

Office of Dist. Engr. Livingston, Mont. Nov. 16, 1927

Proposed work shown  
Valuation Section Montana No. 3.  
Work completed.

