

N. P. 1363
6-24NORTHERN PACIFIC RAILWAY COMPANY
AUTHORITY FOR EXPENDITURE

COMPTROLLER'S COPY

SUPERINTENDENT'S NO.

JTD 53

DEPT. NO.

ENGINEERING DEPT. NO. 112

A. F. E. NO.

YEAR 1927

7

Dakota

Div.

Mandan North Line

DISTRICT
BRANCH

STATE

No. Dak.

VAL. SEC. NO. 14

AUTHORITY IS REQUESTED FOR A NET EXPENDITURE OF \$ 5814

Accounting distribution as follows: (Distribution to be made in General Office.)

	Operating Expenses	Profit and Loss	Net Operating Expenses	Net Profit and Loss
Cost of property retired.....				
Value of salvage				
Incidental costs				
Total to Operating Expenses				
Total to Profit and Loss				
To Material and Supplies				
To Bills for Collection				
To Other Accounts				
Net charge to investment account—Additions and Betterments				
Total of distribution				5814

Budget reference: 1928 Budget Item 13.

Class of Work: No. 1

Joint facility contract reference:

Not Joint Account

The location is --- on this company's property. To secure rights, it will be necessary --

Location: M.P. 19 near Price

Title: Two pile dykes 50 ft. and 150 ft. long

and

Reason:

During the past several years the river has been encroaching on the Railway Company's embankment in the vicinity of M.P. 19. In 1922 a small section of hand placed riprap was placed but it is now necessary to do some additional work below this riprap in order to protect against further erosion before the next spring break-up of the Missouri River.

In line with the U. S. Government's policy in the past few years to hold the river channel in place for the protection of water transportation facilities along the river bank, and in consideration of the Railway Company's cooperation in this movement, the Government have agreed to construct these dykes at their expense. The Railway Company to furnish the necessary material as outlined on the attached estimate, and also furnish a land pile driver for the Government's use in driving the piling.

This work is to be handled in conjunction with the proposed extension of revetment for protection of the elevator site (OVER)

Work to be done by ~~contract~~ U. S. Government

Accounting to concentrate in the office of District Engineer

Signature and Title:

District Engineer

Checked and Entered
Principal's Office

Date Dec. 5th, 1927

APPROVED:

General Superintendent.	Chief Engineer.	Vice President.
Mech. Supt., Supt. Telegraph or Signal Engr.	For Controller.	President.

COMPTROLLER'S RECORD OF NOTICE OF APPROVAL AND OF COMPLETION

Form No. 1346 issued

19 Work begun

19 Work finished

March 5 1928

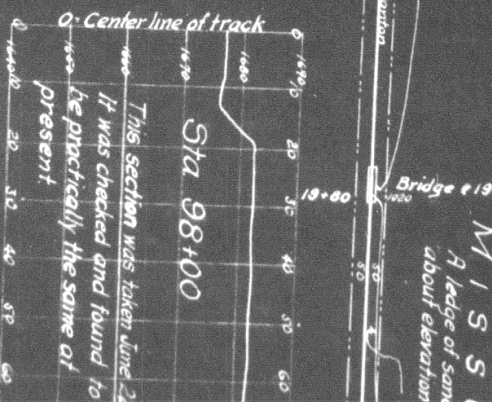
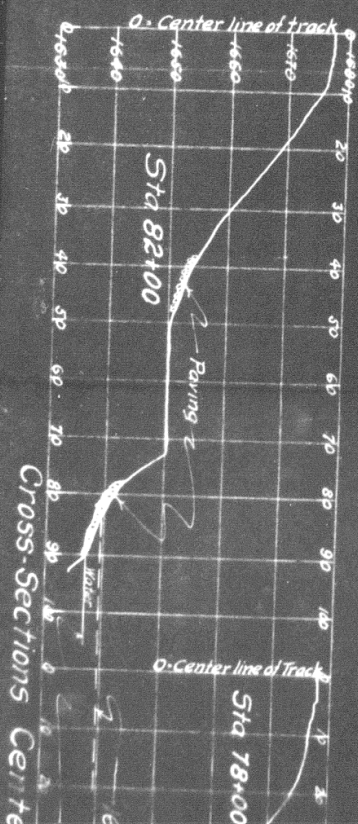
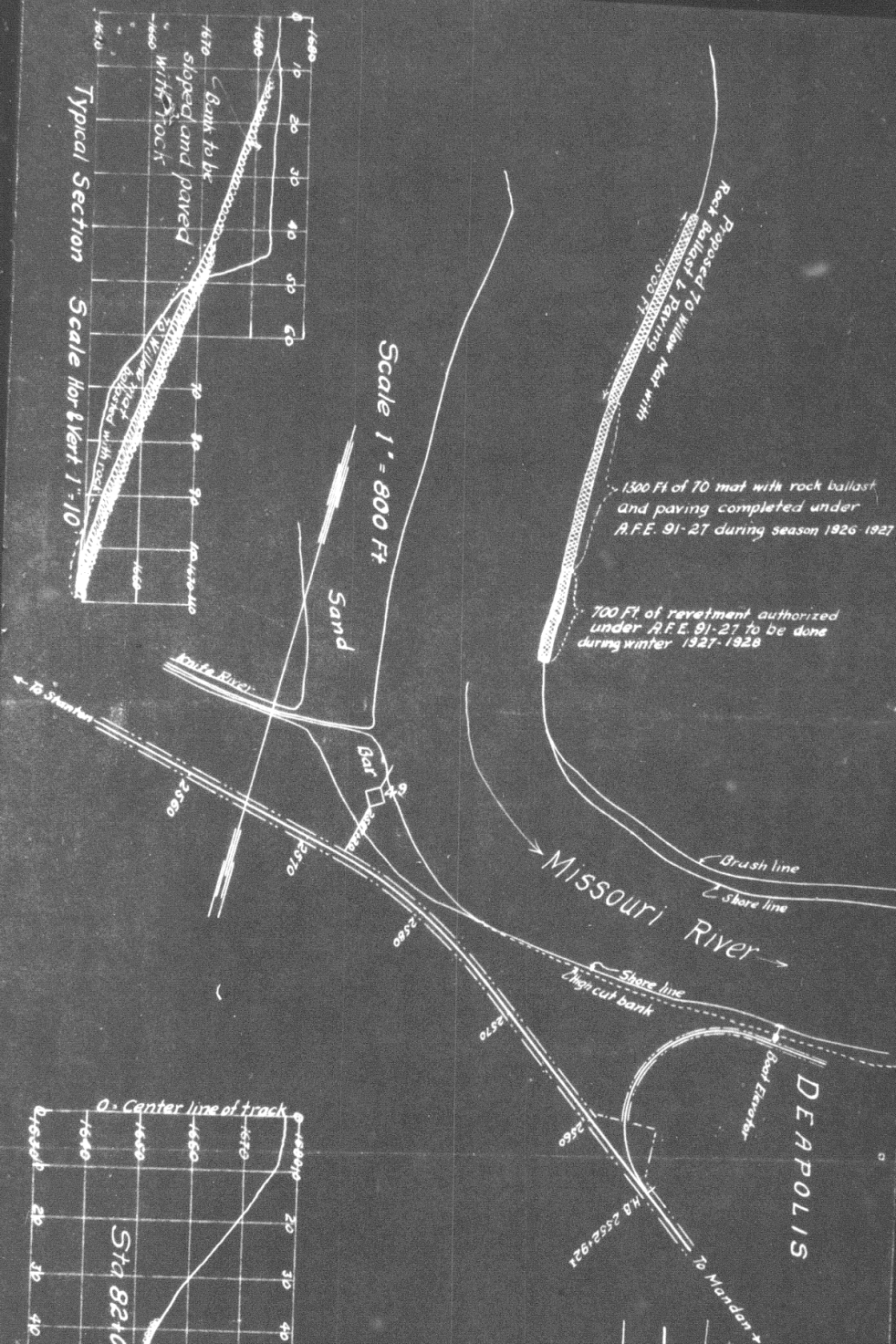

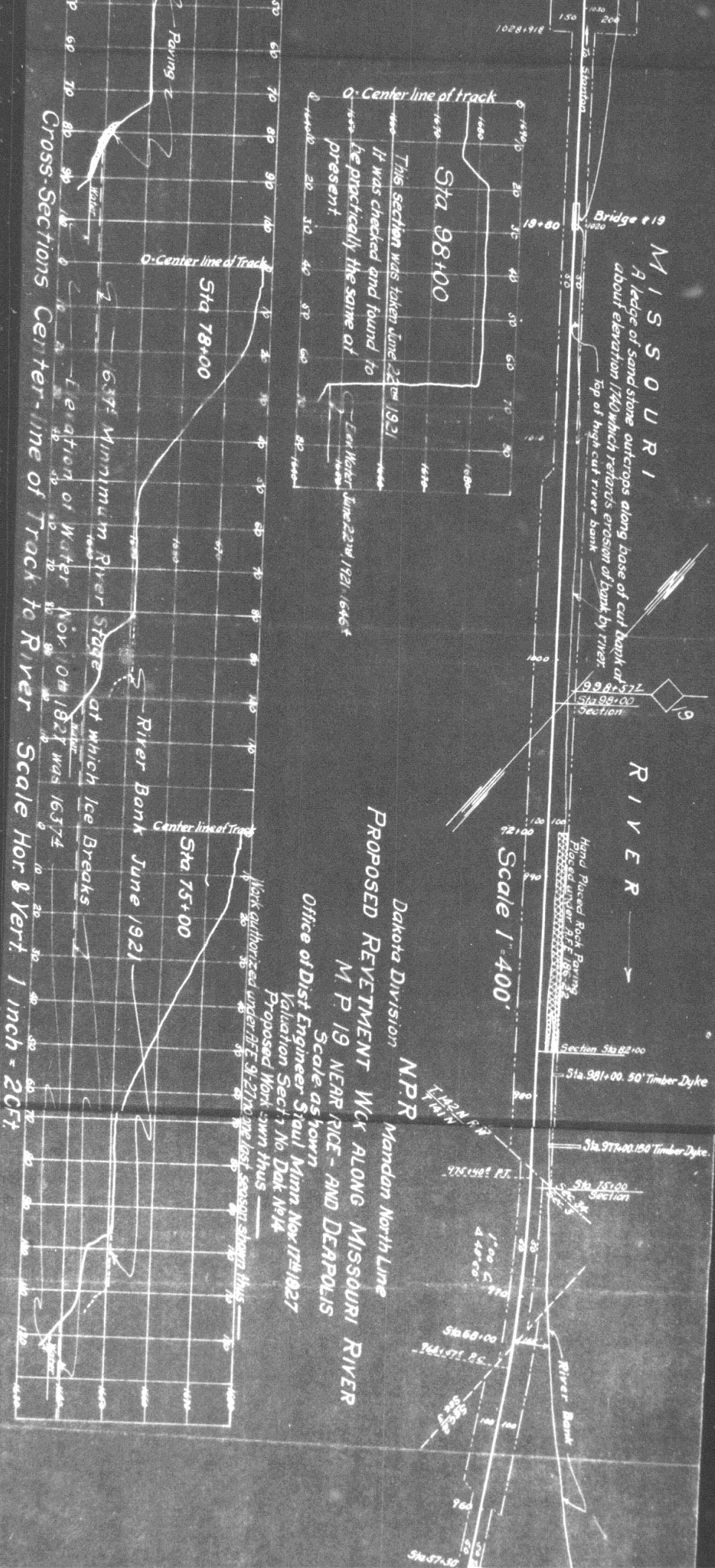

Q. Center line of track

Sta 98+00

This section was taken June 22nd 1921. It was checked and found to be practically the same as present.

En. Motor Line 22nd 1921. 1646'

Dakota Division

N.P.R.

PROPOSED REYEMENT WCK ALONG MISSOURI RIVER

M. P. 19 NEAR RICE - AND DEAPOLIS

Office of Dist Engineer Saul Mann Nov 12th 1927

Scale as shown

Calculation Sect 1 No. Dak No 14

Proposed Work shown thus

Work authorized under A.E. 9-2170 the last season shown thus

