



N. P. 1363  
6-24

1927

1927  
NORTHERN PACIFIC RAILWAY COMPANY  
AUTHORITY FOR EXPENDITURE

COMPTROLLER'S COPY

1927  
YEAR 1927

SUPERINTENDENT'S NO.

DEPT. NO.

M. F. C. No.

ENGINEERING DEPT. NO. 6

A. F. E. NO. 6

Yellowstone Div.

Second

DISTRICT  
BRANCH

STATE No. Dak. VAL. SEC. No. 2

AUTHORITY IS REQUESTED FOR A NET EXPENDITURE OF \$ 4 580.

Accounting distribution as follows: (Distribution to be made in General Office.)

|  | Operating Expenses | Profit and Loss                                 | Net Operating Expenses | Net Profit and Loss |
|--|--------------------|---|------------------------|---------------------|
| Cost of property retired                                   | \$ 150.            |   |                        |                     |
| Value of salvage   | 0.                 |   | 150.                   |                     |
| Incidental costs   |                    |   | 590.                   |                     |
| Total to Operating Expenses                                |                    |   |                        | 740.                |
| Total to Profit and Loss                                   |                    |   |                        | 0.                  |
| To Material and Supplies                                   |                    | Original Cost Adjustment<br>Made in JAN 22 1928 |                        |                     |
| To Bills for Collection                                    |                    | 19  |                        |                     |
| To Other Accounts  |                    |   |                        |                     |
| Net charge to investment account—Additions and Betterments |                    |   |                        | 3 840.              |
| Total of distribution                                      |                    |   |                        | 4 580.              |



Budget reference: Item No. 113- Budget 1927

Class of Work: No. 4

Joint facility contract references: None

The location is on this company's property. To secure rights, it will be necessary to do nothing

Location: Near South Heart, North Dakota, Bridge 120 over Branch of Heart River.

Title: Reinforce I Beam Spans

and

Reason: The present structure consists of two 25 foot I Beam and one 30 foot I Beam Spans, 81 feet long and 16 feet high, built in 1901. It was designed for 146 ton loading and is too light for the heavy type of power. It is proposed to place three additional I Beams in each span and make it good for E-65 loading.

Checked and Entered  
President's Office



Work to be done by company force under charge of Division Superintendent

Accounting to concentrate in the office of Division Superintendent at Glendive

Signature and Title: *M. S. Clements*  
Bridge Engineer

Date: Sept. 8, 1926

APPROVED:

|   |   |                                       |
|---|---|---------------------------------------|
| General Superintendent                    | Ast. Chief Engr. or Engr. Maint. of Way | General Manager                       |
| Mech. Sust., Supr. Telgr. or Signal Engr. |   |                                       |
| Chief Engineer                            |   | Vice President                        |
| For Comptroller                           | President                               | Date of Final Approval { DEC 4 - 1926 |

COMPTROLLER'S RECORD OF NOTICE OF APPROVAL AND OF COMPLETION

Form No. 1345 issued

19 Work begun

19 Work finished

June 13, 1927

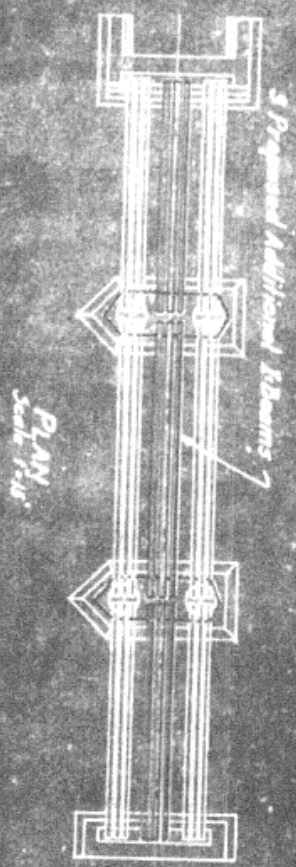
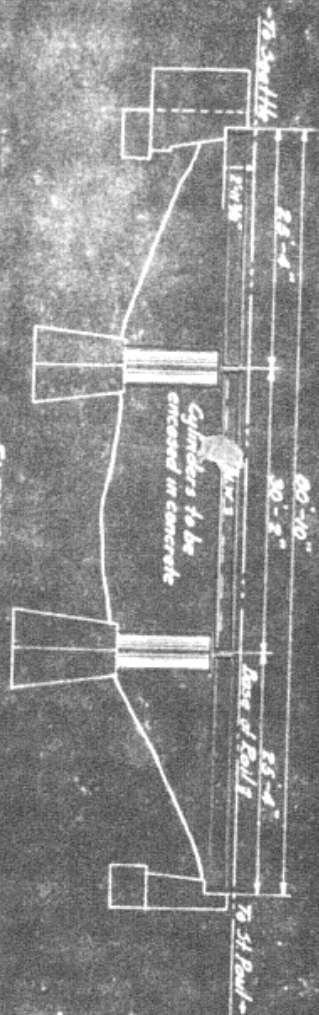

*Proposed work shown in Red.*

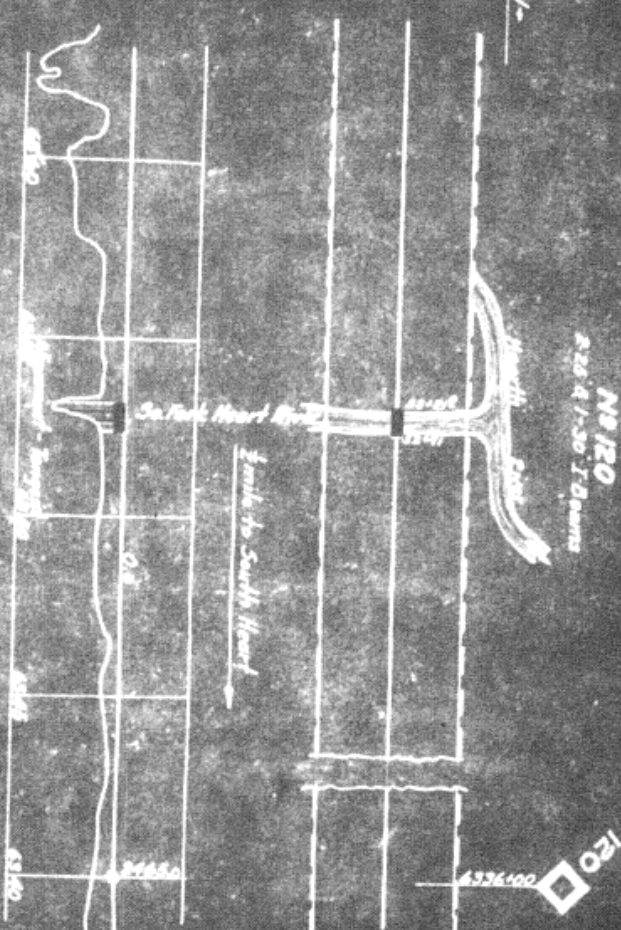

**PLAN AND PROFILE**

Scale  
1/8" = 1'-0"

N.P.R.

Ed. Sub. Div.

**SKETCH SHOWING PROPOSED ADDITIONAL I BEAMS  
MAKING SPANS GOOD FOR STRAND LOADING**

Office of Bridge Engineer  
St. Paul Minn. Sept. 19, 1926

For Detail See Bridge Engr's Plan No. 62007.  
 Lined St. Paul, Nov. 5-1926.

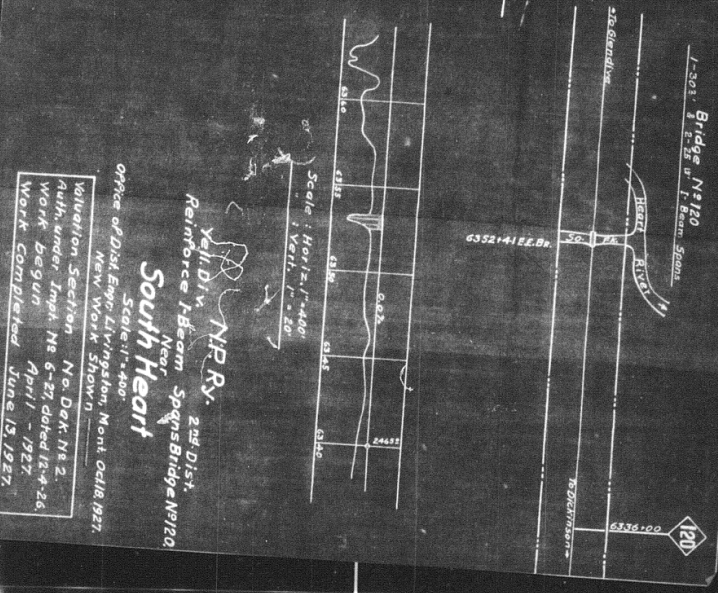
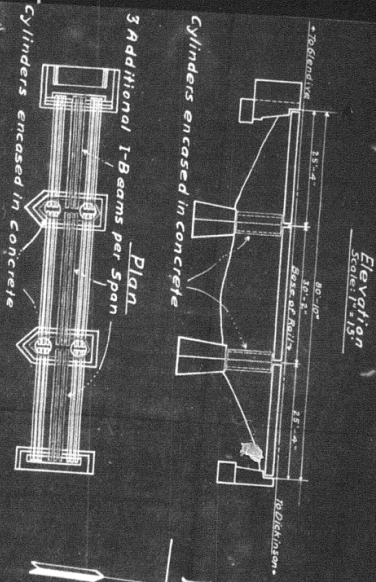

N. P. 1927  
 1927 NORTHERN PACIFIC RAILWAY COMPANY  
 AUTHORITY FOR EXPENDITURE 1927

SUPERINTENDENT'S NO. M.F.C. No. 1 DEPT. NO. ENGINEERING DEPT. No. 7 A.F.E. NO. 7

Yellowstone Div. Second District State No. Dak. VAL. SEC. NO. 2

**AUTHORITY IS REQUESTED FOR A NET EXPENDITURE OF \$ 3 585.**

Accounting distribution as follows: (Distribution to be made in General Office)

| Cost of property retired | Value of salvage | Incidental costs | Total to Operating Expenses | Total to Profit and Loss | To Material and Supplies | To Bills for Collection | To Other Accounts | Net charge to investment account (Additions and Deductions) | Total of distribution |
|--------------------------|------------------|------------------|-----------------------------|--------------------------|--------------------------|-------------------------|-------------------|---|-----------------------|
| 100.                     | 0.               | 565.             | 665.                        | 0.                       | 0.                       | 0.                      | 0.                | 2 920.  | 3 585.                |

Budget reference: Item No. 779 Budget 1927 Class of work: No. 4

Joint facility contract reference: None

The location is \_\_\_\_\_ in the company's property. To secure access, it is necessary to do nothing

Location: Near Belvidere, North Dakota, Bridge 130.

Title: Reinforce I Beam spans

Reason: The present structure consists of two 30 foot I Beams 61 feet long and 16 feet high on concrete masonry and cylinder pier built in 1902. It was designed for 140 ton loading and is too light for the heavy type of power. It is proposed to place three additional I Beams in each span and make it good for 2-60 loading.

Work to be done by company force under charge of Division Superintendent at Glendive

Accounting to cooperate in the office of Division Superintendent at Glendive

Signature and Title: \_\_\_\_\_