



N. P. 1363

DULUTH UNION DEPOT AND TRANSFER COMPANY

COMPTROLLER'S COPY

1927

AUTHORITY OF EXPENDITURE

1927  
YEAR 1927

SUPERINTENDENT'S No. 2

DEPT. No.

A. F. E. NO. 3

ENGINEERING DEPT. No. 3

Div. DUD&T Co.

DISTRICT STATE Minn.  
BRANCH

VAL. SEC. No. /

AUTHORITY IS REQUESTED FOR A NET EXPENDITURE OF \$ 844.00

Accounting distribution as follows: (Distribution to be made in General Office.)

	Operating Expenses	Profit and Loss	Net Operating Expenses	Net Profit and Loss
Cost of property retired	838		414	
Value of salvage	424		397	
Incidental costs				811
Total to Operating Expenses				424
Total to Profit and Loss				33
To Material and Supplies				1268
To Bills for Collection				
To Other Accounts				
Net charge to investment account—Additions and Betterments				
Total of distribution				



Class of Work: No. 3

Budget reference: Not in Budget

Joint facility contract reference: Owned by Duluth Union Depot and Transfer Company

The location is on this company's property. To secure rights, it will be necessary to do nothing.

Location: *Hecketh*  
West end of Union Depot coach yard.

Title: Replace present wornout 67# crossover at west end of coach yard with 85# rail and switches.

Reason: The present crossover connecting the NP main line with the coach yard tracks at west end of coach yard is laid with 67# steel and 66# switches. This is wornout, and due to the heavy power used in coach yard, should be replaced with 85# steel and switches.

Checked and Entered  
President's Office



Work to be done by company force under charge of contract Section Foreman - DUD&T Co.

Superintendent - DUD&T Co.

Accounting to concentrate in the office of

Signature and Title: *H. B. Bissell* Superintendent

Date June 29 1927

APPROVED: <i>H. C. Bissell</i> General Superintendent	<i>Bernard Blum</i> Engr. Maint. of Way	<i>J. H. Hartley</i> General Manager
<i>[Signature]</i> Mech. Supt., Supt. Telg. or Signal Engr.	<i>W. B. Strachan</i> Supt. of Maintenance	<i>[Signature]</i> Vice President
<i>[Signature]</i> Chief Engineer	<i>Charles Donnelly</i> President	Date of Final Approval { AUG 17 1927
<i>[Signature]</i> For Comptroller		

COMPTROLLER'S RECORD OF NOTICE OF APPROVAL AND OF COMPLETION

H.B. 7956+262

H.B. 7956+802

Old Ld 732 15'67" Pts #9R.F.115.66# 15'6R.L.67#  
Replace with 85 #Mat'l, 15' Pts 8'3" G.R. #9R.F.139  
Old Ld 752 15'67" Pts #9R.F.95.66# 15'6R.L.67#  
Replace with 85 #Mat'l, 15' Pts 8'3" G.R. #9R.F.139

G.N. Ry. Co.  
Dul. Union Depot Co.

10th Ave W

9th Ave W

D.U.D.C.

Prop'd Relay of 2 Turnouts ~ W End of Coach Yard  
Lette Superior Divn.  
D.U.D.C.

Duluth Terminals  
Office of Dist Engr. St Paul June 17-1927  
Scale 1" = 60'  
Prop'd work shown thus  
Valuation Section No 1 Minn.

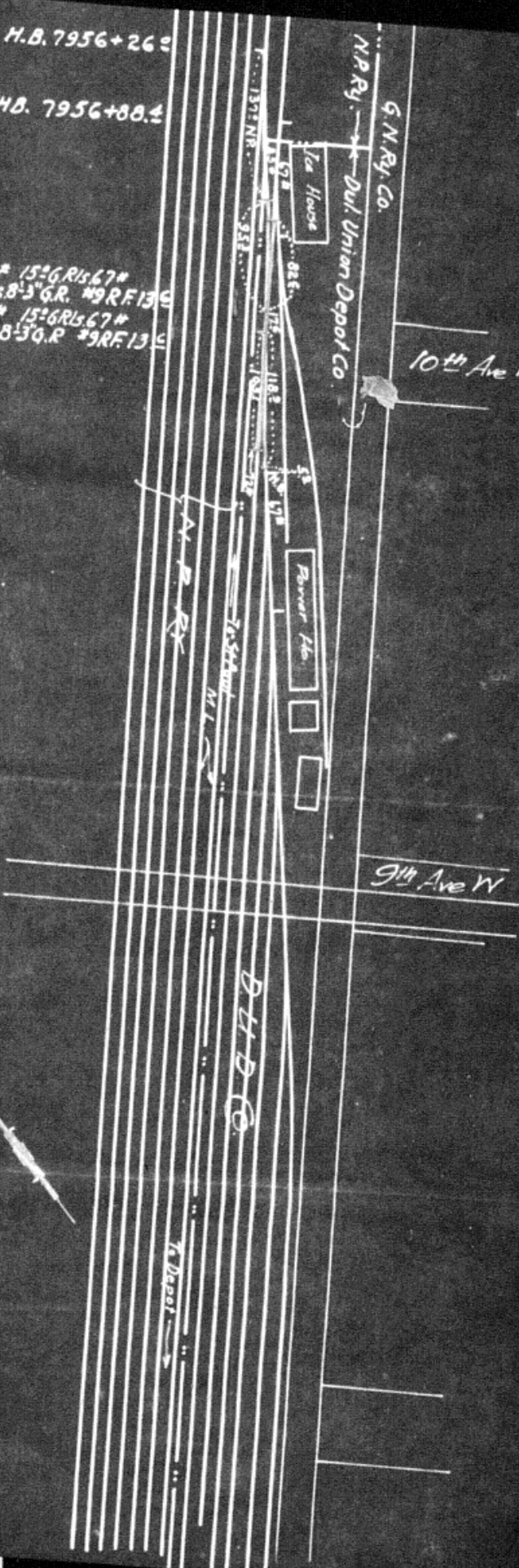

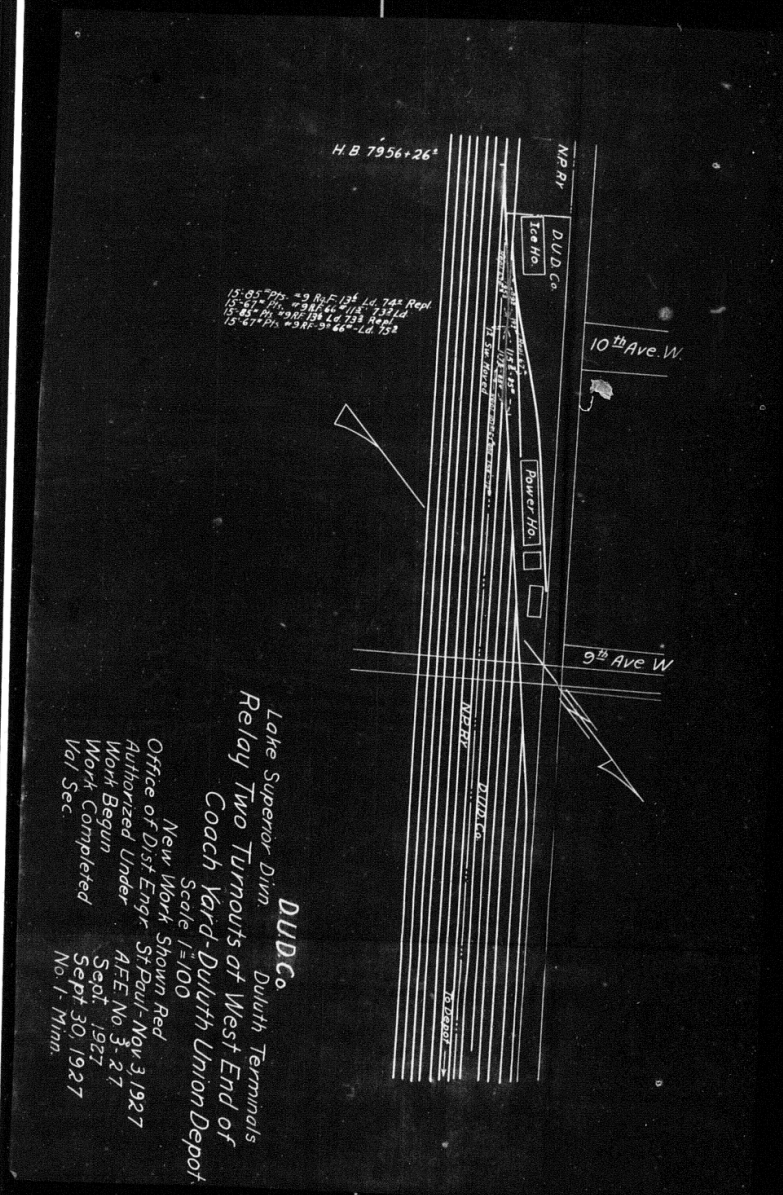

N. P. 1363 1927 NORTHERN PACIFIC RAILWAY COMPANY COMPTROLLER'S COPY  
 1927 AUTHORITY FOR EXPENDITURE 1927 1927  
 SUPERINTENDENT'S NO. E. J. C. DEPT. NO. ENGINEERING DEPT. NO. 4 A. F. E. NO. 4  
 Yellowstone Div. First DISTRICT STATE NO. Dak. VAL. SEC. NO. 2  
 AUTHORITY IS REQUESTED FOR A NET EXPENDITURE OF \$ 2 120.  
 Accounting distribution as follows: (Distribution to be made in General Office.)

	Operating Expenses	Profit and Loss	Net Operating Expenses	Net Profit and Loss
Cost of property retired	50.		50.	
Value of salvage	0.		0.	
Incidental costs			590.	
Total to Operating Expenses				640.
Total to Profit and Loss		Original Cost Adjustment		
To Material and Supplies		Made in 1911-1928 19		0.
To Bills for Collection				
To Other Accounts				
Net charge to investment account—Additions and Betterments				1 480.
Total of distribution				2 120.

Budget reference: Item No. 111 - Budget 1927  
 Joint facility contract reference: None  
 The location is on this company's property. To secure rights, it will be necessary to do nothing  
 Location: Near Hebron, North Dakota, Bridge 74.  
 Title: Reinforce I Beam Span  
 Reason: The present structure consists of one 30 foot I Beam on concrete masonry, built in 1900. It was designed for 146 ton loading and is too light for the heavy type of power. It is proposed to place three additional I Beams in each span and make it good for E-65 loading.

Checked and Entered  
 President's Office