

Form 100 100 **1922**

**NORTHERN PACIFIC RAILWAY COMPANY**  
AUTHORITY FOR EXPENDITURE

**1922**

Year: 1922

Superintendent's No. **7** **OPERATING** Dept. No.  
No. Engineering Dept. No. **21(22)**

A. F. E. No. **105**

**IDAHO** Div. **W. C.** Branch State **WASH** Val. Sec. No. **12**

**AUTHORITY IS REQUESTED FOR A NET EXPENDITURE OF \$196**

Accounting distribution as follows (Distribution to be made in General Office)

	Profit and Loss	Net Operating Expenses	Net Profit and Loss
Cost of property retired	\$ 570		
Value of salvage		30	570
Incidental costs		108	75
Total to Operating Expenses			
Total to Profit and Loss	\$ 570		\$ 138
Loss on Retired Road & Equipment			645
To Material and Supplies			
To Bills for Collection			
To Other Accounts			
Net charge to investment account - Additions and Betterments			587
Total of distribution			\$ 196

**CORPORATE**

Budget reference *Not in Budget* Original Class of Work No.

Joint facility contract reference *Not used* Made in *MSU* 1922 necessary

The location is \_\_\_\_\_ on this company's property To secure rights, it will be necessary to \_\_\_\_\_

Location: **WILBUR, WASHINGTON.**

Title **Moving and converting old pump house into an ice house.**

Reason: We have a small ice house for serving the station and section forces at Wilbur but this building has been in use a great many years and has become in an extremely dilapidated condition. We also have at that point an old abandoned pump house which is not needed. This building is 12x30' in dimension and may be moved and fitted up satisfactorily for an ice house, this job involving moving the building a short distance to the house track, putting under it new sills, placing the door on the rear side and closing up the front doors and windows.

It is important that we have facilities for storing seasons ice supply at Wilbur for the station and section men to avoid the necessity for shipping ice on passenger trains at frequent intervals and under excessive shrinkage during the summer months.

Checked and Entered  
President's Office

Work to be done by company force under charge of **SUPERINTENDENT**

Accounting to concentrate in the office of **SUPERINTENDENT**

Signature and Title: *A.P. Jones* Date **Jan. 14th** 19**22**n.

APPROVED: *A.P. Jones* General Superintendent. *A.P. Jones* Engr. of *W.C.* Assistant General Manager

Mech. Supt. or Supt. Telgh. *[Signature]* Chief Engineer. *[Signature]* General Manager. *[Signature]* Vice President

Comptroller *[Signature]* Date of Final Approval **1922**

COMPTROLLER'S RECORD OF NOTICE OF APPROVAL AND OF COMPLETION

Issued **FEB 11 1922** Work begun \_\_\_\_\_ 19 \_\_\_\_\_ Work finished **Oct. 17, 1922**

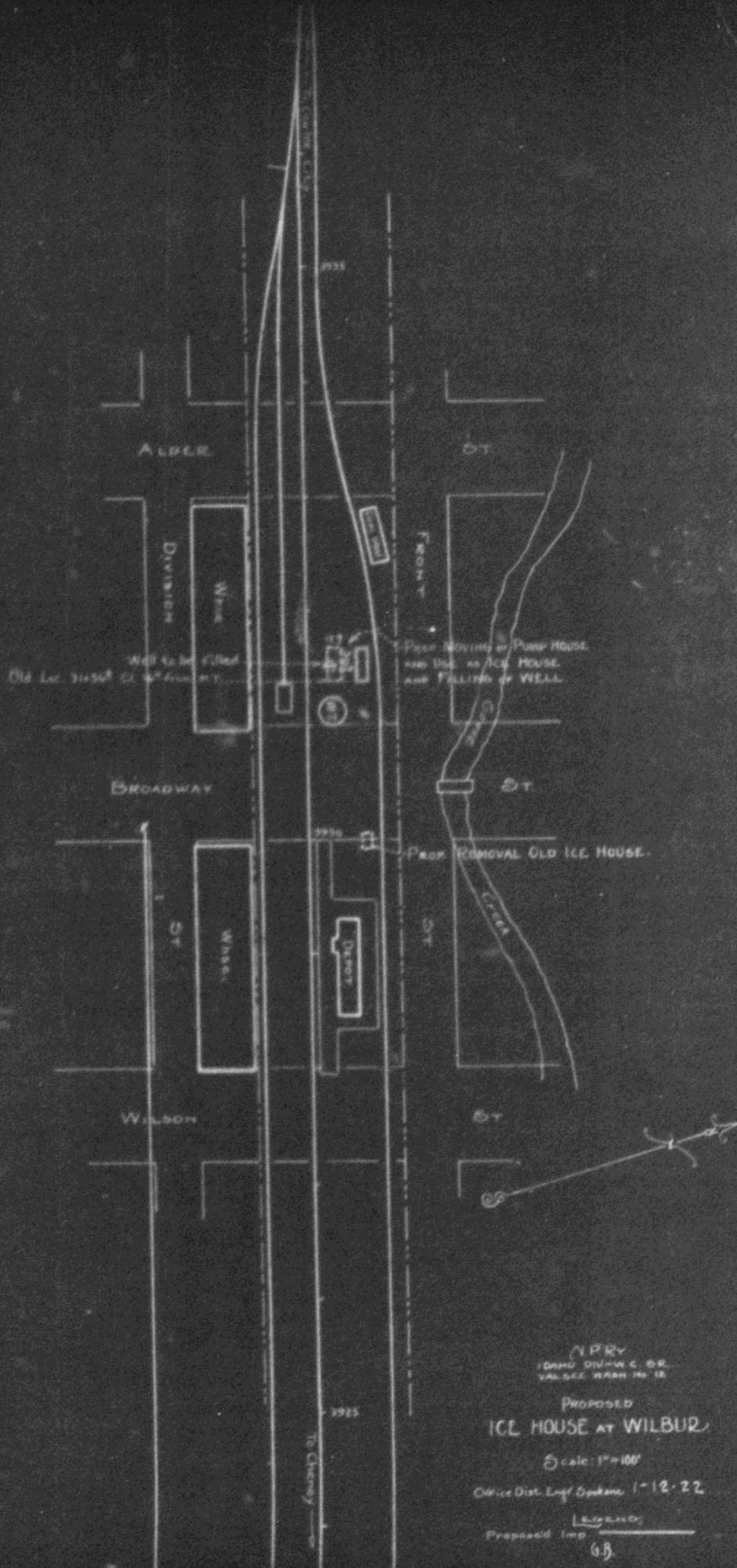

N.P.V.  
 DRAIN DIVISION C. O. R.  
 VALLEY ROAD NO. 12

PROPOSED  
 ICE HOUSE AT WILBUR

Scale: 1"=100'

Office Dist. Engr. Spokane, 1-12-22

LEGEND:  
 Proposed Imp \_\_\_\_\_  
 43.